



Belsize Square

Belsize Park, NW3

£3,950 per month
(£911.54 per week)

VIDEO TOUR AVAILABLE.Short Let. A magnificent spacious 1st floor apartment in a beautiful period building boasting exceptionally high ceilings, wood floors throughout and a balcony. The property is situated in this popular well located quiet tree lined square in the heart of Belsize Park, walking distance to the shops and restaurants. Accommodation comprises spacious reception room, fully fitted kitchen, double bedroom with fitted wardrobes with direct access to the balcony, ultra modern bathroom, separate guest cloakroom. Sole Agent.

CHESTERTONS



Belsize Square

Belsize Park, NW3

- Short Let. A Magnificent Spacious 1st floor Apartment in Beautiful Period Building
- 1 Bedroom, 1 Bathroom, Reception, Kitchen
- Exceptionally High Ceilings, Wood Floors Throughout, Balcony
- Situated in Quiet Tree Lined Street, Walking Distance to the Shops/Amenities of Belsize Park (Northern Line)



Minimum Term: 3 months
Deposit Required: £3,646.15
Local Authority: London Borough Of Camden
Council Tax Band: D
EPC Rating: C
Furnished

Energy Efficiency Rating		
	Current	Potential
Very energy efficient - lower running costs		
A (91-100)		
B (81-90)		
C (69-80)	75	79
D (55-68)		
E (39-54)		
F (21-38)		
G (1-20)		
Not energy efficient - higher running costs		
England, Scotland & Wales EU Directive 2002/91/EC		

Chestertons Hampstead Lettings

55-56 Hampstead High Street
 Hampstead
 London
 NW3 1QH
 hampstead@chestertons.co.uk
 02077941125
 chestertons.co.uk

Additional tenant charges apply (fees apply to non-AST tenancies only)
 Tenancy Agreement Fee: £300
 References per Tenant/Guarantor: £60
 Inventory check (approx. £100 – £250 inc. VAT)
chestertons.co.uk/property-to-rent/applicable-fees

Belsize Square, NW3

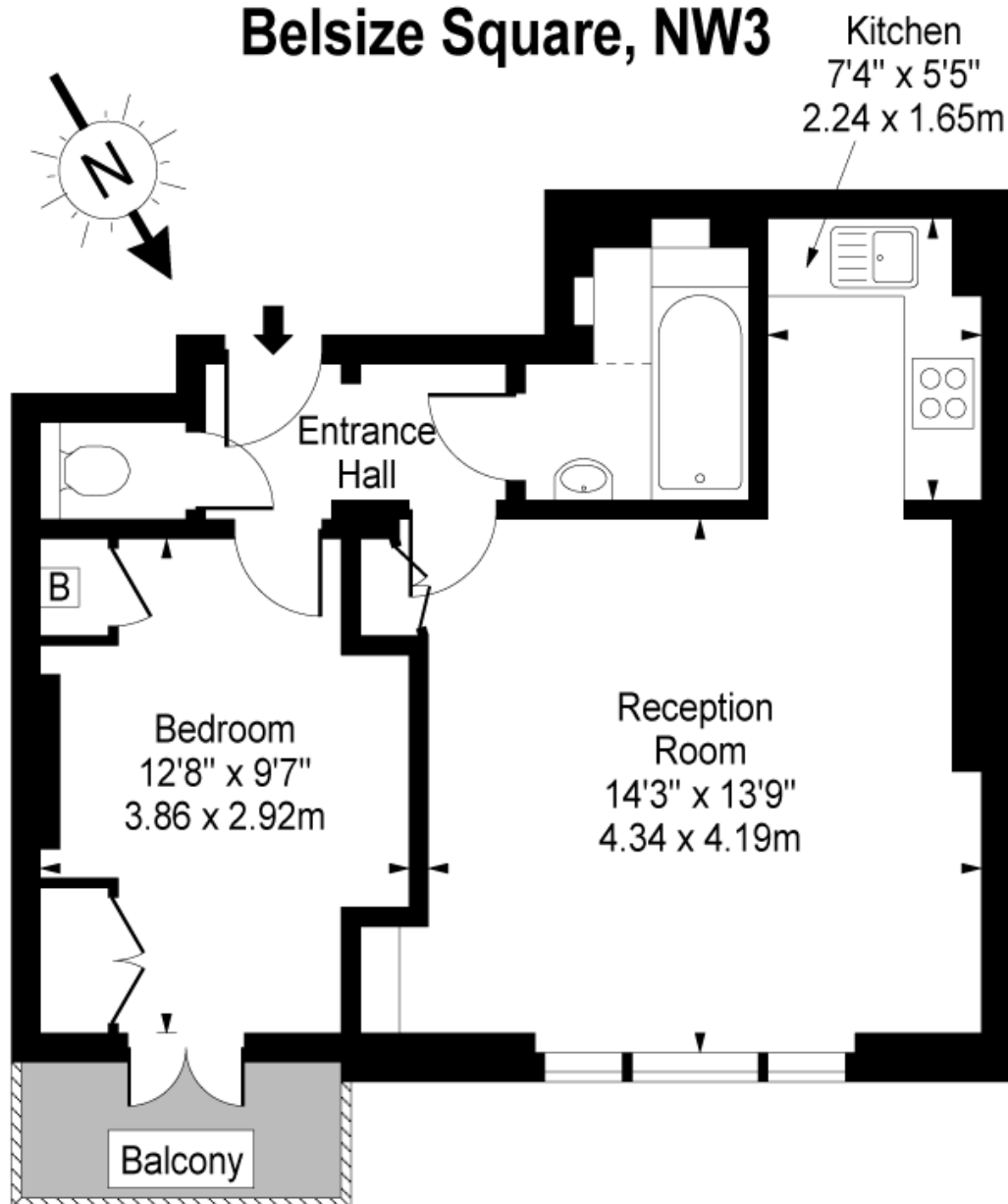

First Floor

Approx Gross Internal Area 450 Sq Ft - 41.81 Sq M

For Illustration Purposes Only - Not To Scale

www.goldlens.co.uk

Prepared for Chestertons

Ref. No. 001573

