



Kings Road

Chelsea, SW3

£3,791.67 per month
(£875 per week)

An ideally located split-level one bedroom apartment situated only moments away from Sloane Square in the heart of Chelsea. Benefiting from over 800sqft of accommodation space and own private entrance.

CHESTERTONS



Kings Road

Chelsea, SW3

- Spacious split-level one bedroom apartment
- Plenty of period features
- Over 800sqft
- Moments away from Sloane Square



An ideally located split-level one bedroom apartment situated only moments away from Sloane Square in the heart of Chelsea. Benefiting from over 830sqft of accommodation space and own entrance.

Sloane Square is easily reachable on foot, Knightsbridge and South Kensington are located nearby and accessible either on foot or via public transport found on Kings Road or Sloane Square.

Minimum Term: 5 months
Deposit Required: £4,375.00
Local Authority: Royal Borough of Kensington & Chelsea
Council Tax Band: F
EPC Rating: C
Unfurnished

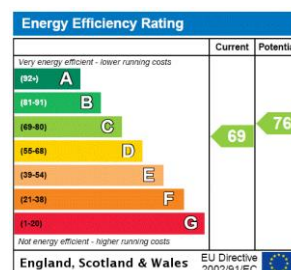

Chestertons Chelsea Lettings

17 Cale Street
 London
 SW3 3QR
 chelsea@chestertons.co.uk
 02075944750
 chestertons.co.uk

Additional tenant charges apply (fees apply to non-AST tenancies only)
 Tenancy Agreement Fee: £300
 References per Tenant/Guarantor: £60
 Inventory check (approx. £100 – £250 inc. VAT)
 chestertons.co.uk/property-to-rent/applicable-fees

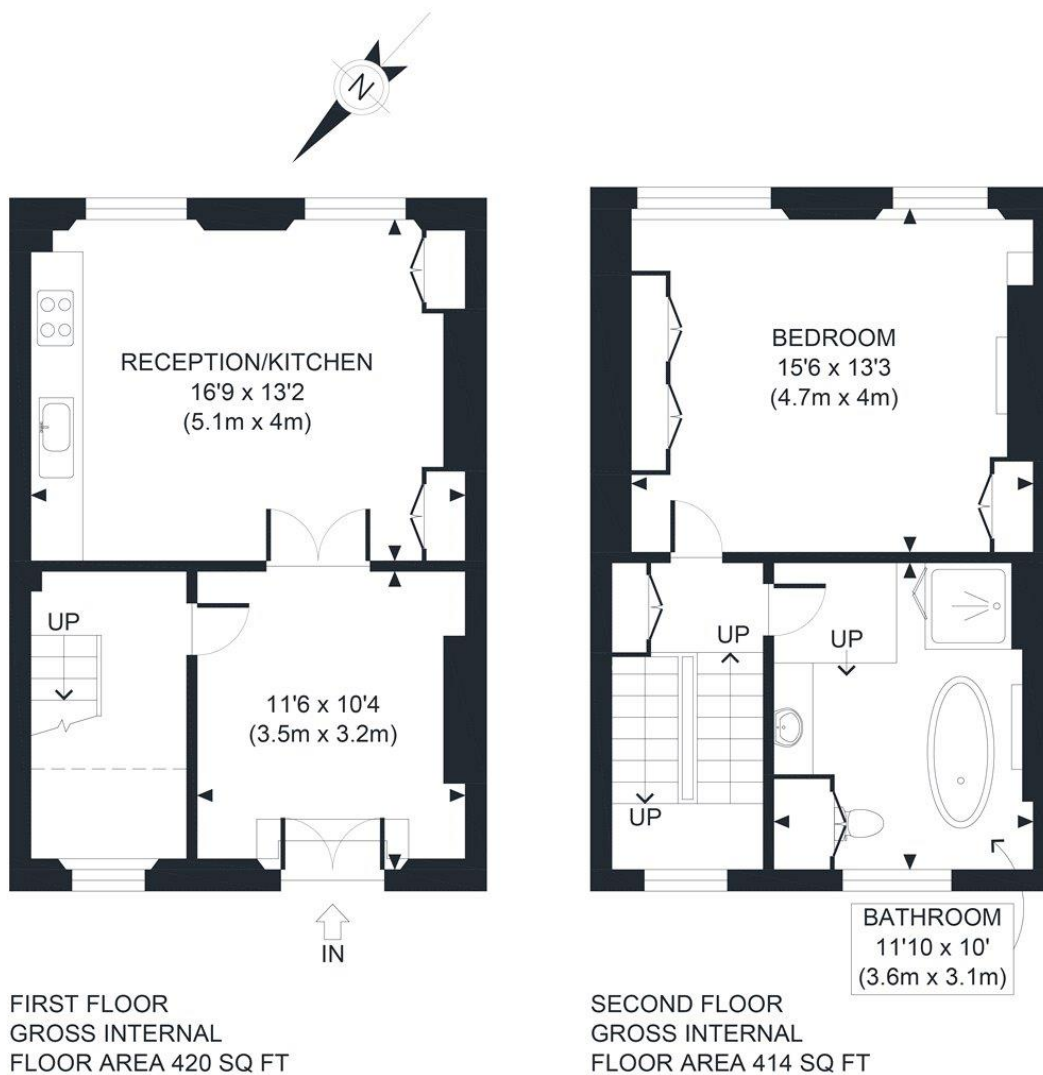

APPROX. GROSS INTERNAL FLOOR AREA 834 SQ FT / 77 SQM

Ref:

Copyright **photoplan** 

Disclaimer: Floor plan measurements are approximate and are for illustrative purposes only. While we do not doubt the floor plan accuracy and completeness, you or your advisors should conduct a careful, independent investigation of the property in respect of monetary valuation

