



# Pelham Court

145 Fulham Road, SW3

£825 per week  
(£3,575 pcm)

Located in the heart of Chelsea is this newly re-decorated two bedroom apartment on the first floor of this period mansion block and has the added benefit of an onsite porter, lift and access to communal gardens. Photos are examples. EPC C.



# Pelham Court

## 145 Fulham Road, SW3

- Reception Room
- Kitchen
- Bedroom with Ensuite Shower Room
- Further Bedroom
- Bathroom
- Lift
- Communal Gardens





This beautiful two bedroom two bathroom first floor apartment is located in the heart of Chelsea and looks directly out onto Pelham Crescent. The apartment comprises of two bedrooms with ample storage space, two bathrooms, separate kitchen and a large reception room.

The property is available to rent furnished or unfurnished.

This beautiful Edwardian style mansion block offers light, spacious and modern living accommodation while maintaining many of the classical period features of the building. The apartments are set over 5 floors and are accessed via a lift. The flats can be rented on flexible

**Tenure:** To be advised  
**Furnished, Part Furnished**

Additional tenant charges apply (fees apply to non-AST tenancies only)  
 Tenancy Agreement Fee: £300  
 References per Tenant/Guarantor: £60  
 Inventory check (approx. £100 – £250 inc. VAT)  
[chestertons.com/property-to-rent/applicable-fees](https://www.chestertons.com/property-to-rent/applicable-fees)

Energy Efficiency Rating		
	Current	Potential
Very energy efficient - lower running costs		
(94-100) <b>A</b>		
(81-93) <b>B</b>		
(69-80) <b>C</b>	74	76
(55-68) <b>D</b>		
(39-54) <b>E</b>		
(21-38) <b>F</b>		
(1-20) <b>G</b>		
Not energy efficient - higher running costs		
England, Scotland & Wales EU Directive 2002/91/EC		

### *Chestertons Chelsea Lettings*

17 Cale Street  
 London  
 SW3 3QR  
[lettings.chelsea@chestertons.com](mailto:lettings.chelsea@chestertons.com)  
 02075944750  
[chestertons.com](https://www.chestertons.com)

## 17 PELHAM COURT, SW3

APPROX. GROSS INTERNAL AREA \*  
733 Ft<sup>2</sup> - 68.10 M<sup>2</sup>

ILLUSTRATION FOR IDENTIFICATION PURPOSES ONLY. NOT TO SCALE  
\* As Defined by RICS - Code of Measuring Practice

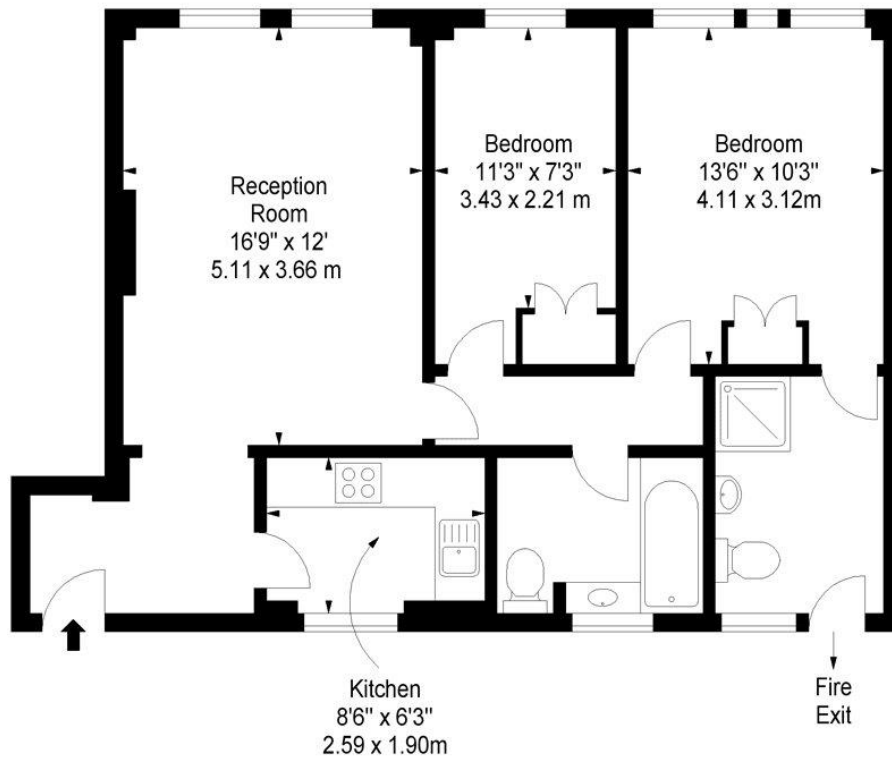

FIRST FLOOR

**BKR**

[www.bkrfloorplans.co.uk](http://www.bkrfloorplans.co.uk)  
T: 0845 257 2023  
© BKR 2010

[1.3.2.11] [Pelham Court 17.pdf] [Page 1 of 1]



This paper is  
100% recyclable