



Merthyr Terrace

Barnes, SW13

£9,000 per month
(£2,076.92 per week)

A beautifully-presented terraced house, arranged over four floors, located in north Barnes. Offered furnished, the property comprises benefits from its proximity to Barnes' renowned local schools and to the public transport hub at Hammersmith.

Accommodation comprises a double reception room, a kitchen and a patio on the raised ground floor, a kitchen and dining room, a double bedroom, a bathroom and a cloakroom on the lower ground floor, as well as hallway storage and another patio garden. Upstairs, there are three further bedrooms, two of which are en-suite and benefit from built-in wardrobes. The second floor also boasts a roof terrace.

Merthyr Terrace is well-situated for the amenities and eateries of adjacent Castelnau. Several frequent bus routes are available nearby for access to the delights of Barnes Village and the High Street. Utilities, council tax and WiFi are included.

CHESTERTONS

Merthy Terrace, SW13

Approximate gross internal area

164.99 sq m / 1776 sq ft

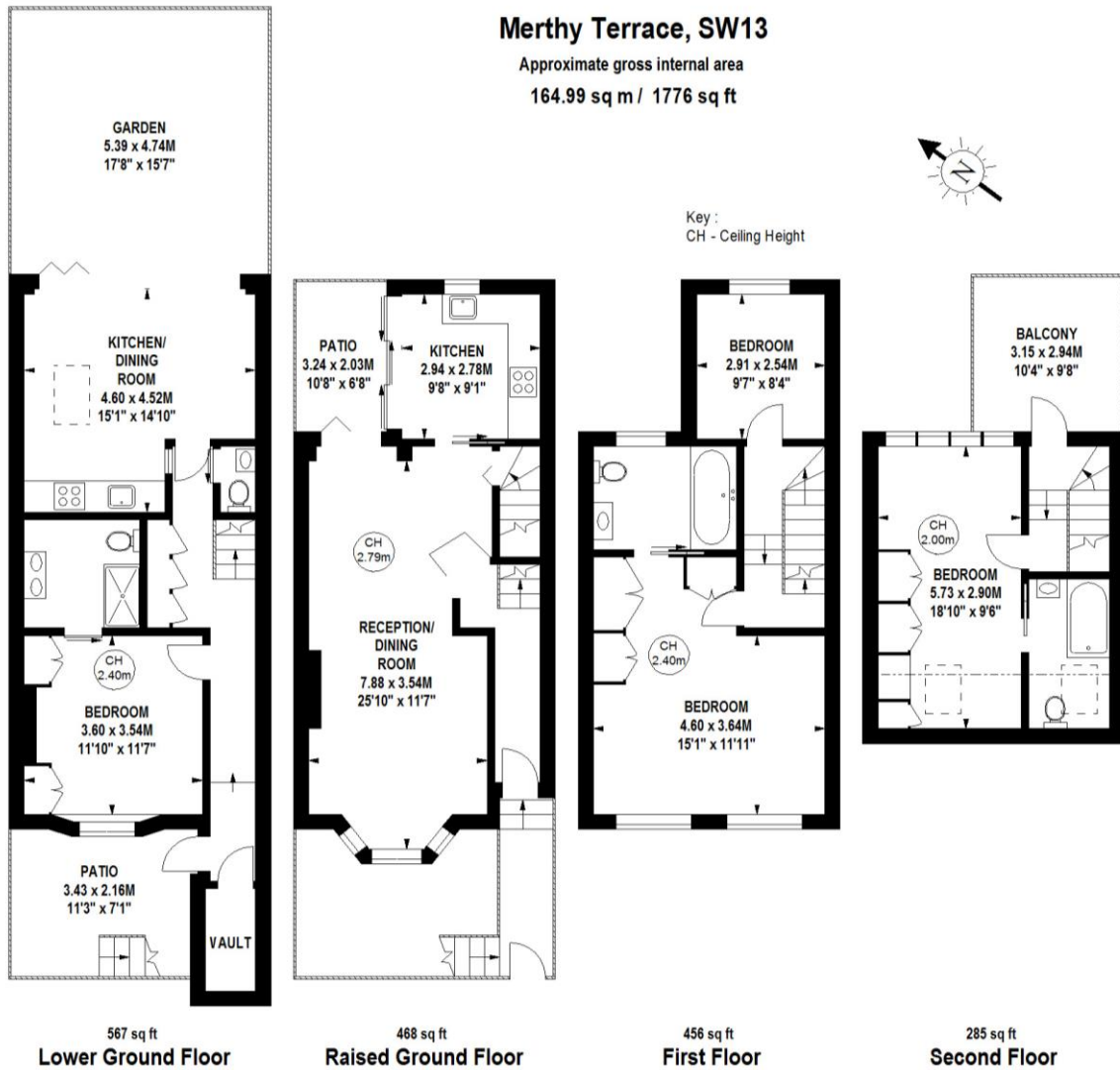

The floor plan is not to scale and measurements and areas shown are approximate and therefore should be used for illustrative purposes only. The plan has been prepared in accordance with the RICS code of Measuring Practice and whilst we have confidence in the information produced, it must not be relied on. If there is any aspect of particular importance, you should carry out or commission your own inspection of the property. Copyright of FeaturePRO.

Minimum Term: 1 month
Local Authority: London Borough of Richmond upon Thames
Council Tax Band: F
EPC Rating: C
Furnished

Energy Efficiency Rating		
	Current	Potential
Very energy efficient - lower running costs		
(92+) A		
(81-91) B		
(69-80) C		
(55-68) D		
(39-54) E		
(21-38) F		
(1-20) G		
Not energy efficient - higher running costs		
EU Directive 2002/91/EC		
England, Scotland & Wales		
	71	82

Chestertons Barnes Village Lettings

68-69 Barnes High Street
 Barnes
 London
 SW13 9LD
lettings.barnes@chestertons.com
 020 8748 7733
chestertons.com

Additional tenant charges apply (fees apply to non-AST tenancies only)

Tenancy Agreement Fee: £300

References per Tenant/Guarantor: £60

Inventory Check: Approx. £100-£250 (inc. VAT)

chestertons.com/property-to-rent/applicable-fees

Chesterton Global Ltd trading as Chestertons for themselves and for the vendor of this property whose agents they are, give notice that (i) these particulars do not constitute any part of an offer or contract, (ii) all statements contained within these particulars are made without responsibility on the part of Chestertons or the vendor, (iii) whilst made in good faith, none of the statements contained within these particulars are to be relied upon as a statement or representation of fact, (iv) any intending purchasers must satisfy themselves by inspection or otherwise as to the correctness of each of the statements contained within these particulars, (v) the vendor does not make or give either Chestertons or any person in their employment any authority to make or give representation or warranty whatsoever in relation to this property. Wide angle lenses may be used. ©Copyright Chestertons | Chesterton Global Ltd | Registered Office 40 Connaught Street, Hyde Park, London W2 2AB Registered Company Number 05334580.



This paper is
100% recyclable