

estate agents **auctioneers**

hollis
morgan



8, Ropemaker Court Lower Park Row, Bristol, BS1 5BN
Offers In Excess Of £400,000

A spacious (1000 sq ft) conversion situated in the ever popular " Ropemaker Court" with gated secure allocated parking, moments from the city centre.

- Two spacious double bedrooms
- Allocated parking behind secure gates
- Spacious open plan reception room
- Modern conversion
- Immaculate conditon
- Master bedroom with ensuite shower room
- Prime central location

The Property

A superb 2-bedroom apartment located on the top floor of Ropemaker Court building situated conveniently in Bristol City Centre.

Upon entry to the flat, the hallway opens up to a spacious and bright open plan kitchen/ reception room to the right. The sleek fitted kitchen is equipped with high end appliances including a fridge freezer, dishwasher, electric hob and oven. It also provides plenty of work surfaces with the central island and worktops. The large reception area offers a versatile space for delineation between a dining and lounge area.

The accommodation further unfolds with two generously proportioned double bedrooms. Notably, the master suite boasts an en-suite shower room, complete with a large main fed shower cubicle, basin, WC and heated towel rail. A bright bathroom serves the flat whilst a large cupboard offers ample space for storage.

Finally, the flat comes with an allocated parking space.

Location - City Centre

The Centre is the heart of the City with constant action on offer from the Hippodrome and Colston Hall, Bristol Shopping Quarter at Cabot's Circus to the characterful Christmas Steps, Corn Street and St Nicholas Market. Nearby Millennium Square acts as a gateway to the neighbouring harbourside with its fountains and big screen as well as world class attractions such as Brunel's SS Great Britain, We The Curious, Bristol Aquarium, the Arnolfini, Spike Island, the Watershed and the M Shed.

Other Information

Leasehold: 242 years remaining from 01/01/20216

Management Fee: £2,300 pa

Management company: HML Ltd

Council Tax Band: C

Please Note

Hollis Morgan endeavour to make our sales details clear, accurate and reliable in line with the Consumer Protection from Unfair Trading Regulations 2008 but they should not be relied on as statements or representations of fact and they do not constitute any part of an offer or contract. All Hollis Morgan references to planning, tenants, boundaries, potential development, tenure etc is to be superseded by the information provided in your solicitors enquiries. It should not be assumed that this property has all the necessary Planning, Building Regulation or other consents. Any services, appliances and heating system(s) listed may not been checked or tested and you should rely on your own investigations. The seller does not make any representation or give any warranty in relation to the property and we have no authority to do so on behalf of the seller. Please note that in some instances the photographs may have been taken using a wide angle lens.



Ropemaker Court, Lower Park Row, Bristol, BS1

Approximate Area = 1018 sq ft / 94.6 sq m

For identification only - Not to scale

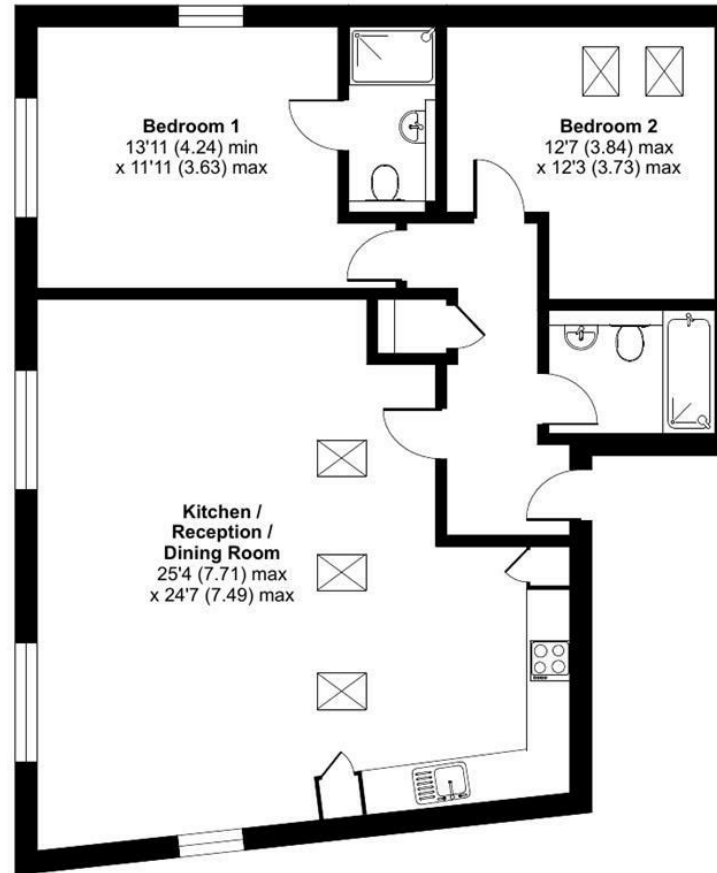

SECOND FLOOR



Floor plan produced in accordance with RICS Property Measurement Standards incorporating International Property Measurement Standards (IPMS2 Residential). © n̄cheom 2024. Produced for Hollis Morgan. REF: 1198516



TEL | 0117 933 9522 | 9 Waterloo Street, Clifton, Bristol BS8 4BT

www.hollismorgan.co.uk | post@hollismorgan.co.uk

Hollis Morgan Property Limited, registered in England, registered no 7275716
Registered address, 5 Upper Belgrave Road, Clifton, Bristol BS8 2XQ

Energy Efficiency Rating		
	Current	Potential
Very energy efficient - lower running costs		
(92 plus) A		
(81-91) B		
(69-80) C		
(55-68) D		
(39-54) E		
(21-38) F		
(1-20) G		
Not energy efficient - higher running costs		
England & Wales	EU Directive 2002/91/EC	

Environmental Impact (CO ₂) Rating		
	Current	Potential
Very environmentally friendly - lower CO ₂ emissions		
(92 plus) A		
(81-91) B		
(69-80) C		
(55-68) D		
(39-54) E		
(21-38) F		
(1-20) G		
Not environmentally friendly - higher CO ₂ emissions		
England & Wales	EU Directive 2002/91/EC	

hollis
morgan
