

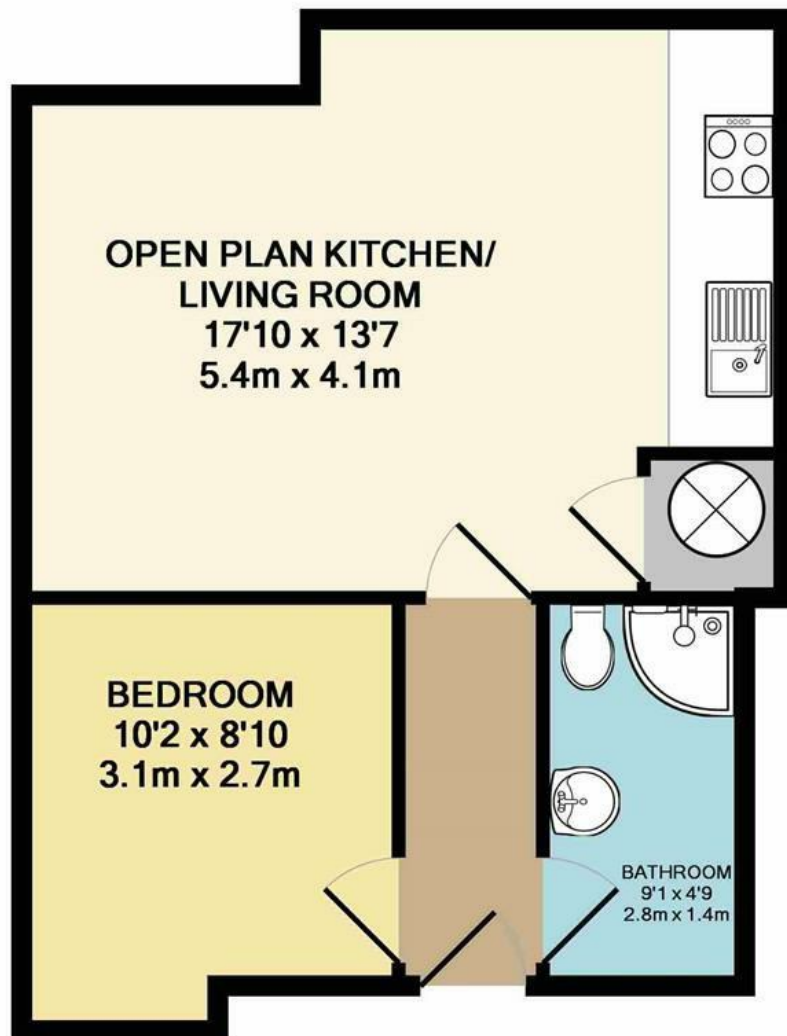

Surrey Street | Norwich | NR1
£900

abbotFox



TOTAL APPROX. FLOOR AREA 389 SQ.FT. (36.1 SQ.M.)

Whilst every attempt has been made to ensure the accuracy of the floor plan contained here, measurements of doors, windows, rooms and any other items are approximate and no responsibility is taken for any error, omission, or mis-statement. This plan is for illustrative purposes only and should be used as such by any prospective purchaser. The services, systems and appliances shown have not been tested and no guarantee as to their operability or efficiency can be given
Made with Metropix ©2018

Energy Efficiency Rating		
	Current	Potential
Very energy efficient - lower running costs		
(92 plus) A		
(81-91) B		
(69-80) C		
(55-68) D	66	66
(39-54) E		
(21-38) F		
(1-20) G		
Not energy efficient - higher running costs		
England & Wales		EU Directive 2002/91/EC

Disclaimer – In accordance with the Property Misdescriptions Act, the company gives notice that all descriptions, references to condition, necessary permissions for use and other details are given in good faith and believed to be correct, but any intending lessees do not rely on them as statements of fact, but must satisfy themselves by inspection or other means, as to their accuracy.



abbotFox presents this second floor one bedroom apartment.

Sentinel House is our cities newest and most exciting residential development offering something Norwich has never seen before. Within the cultivated walls of this iconic landmark, Sentinel House delivers outstanding modern living with a concierge service, residents' gym and residents' lounge all within Norwich's vibrant city centre. Its pioneering renovation has unearthed 199 stunning apartments from a very well known office building and is being marketed exclusively with abbotFox.

Sentinel House is fully submersed in the city centre and empowers walking ease of Norwich's nationally acclaimed shopping facilities, quirky cafes and restaurants, exciting nightlife and its quintessential culture and history. The apartments are an ideal match for commuters, who need to reside within touching distance of both the bus and train stations.

Contemporary specification has ensured that Sentinel House weds effortlessly with the buildings heritage past. This exclusive development has been meticulously presented and offers authentic living space, perfect for city dwellers who are seeking a home in the urban centre.

Expert design has maximised space and lighting throughout six floors. Sentinel House provides an impressive ensemble of studio, one and two bedroom apartments. Each one has been systematically calculated to ensure the very best of contemporary comforts.

The developed blueprints guarantee that all apartments are fitted with modern appliances, stylish finishes and fresh air ventilation. The more prominent floors also permit breath taking scenic views over Norwich's metropolitan skyline.

Early enquiries are encouraged to avoid disappointment.

