

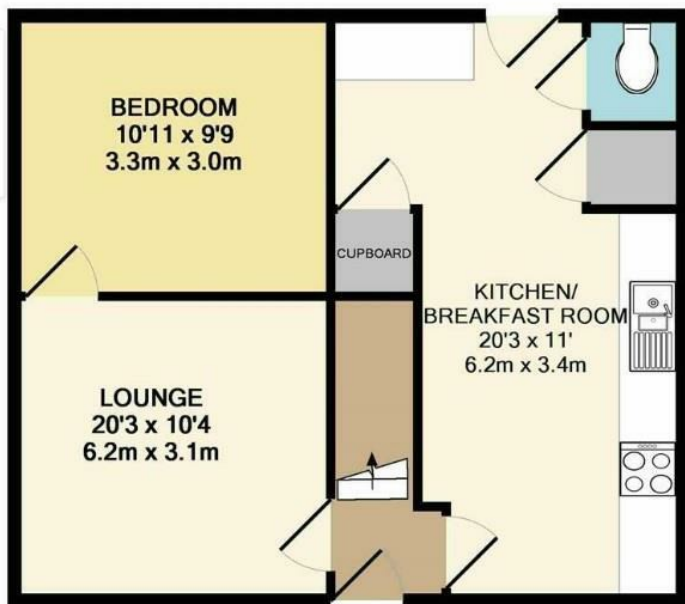

St. Mildreds Road | Norwich | NR5
£1,800

abbotFox



GROUND FLOOR
APPROX. FLOOR
AREA 469 SQ.FT.
(43.6 SQ.M.)

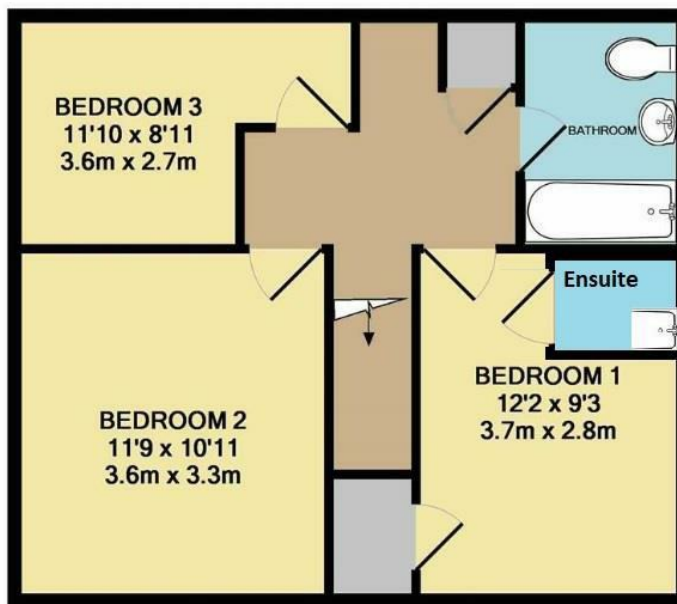

1ST FLOOR
APPROX. FLOOR
AREA 469 SQ.FT.
(43.6 SQ.M.)

TOTAL APPROX. FLOOR AREA 938 SQ.FT. (87.1 SQ.M.)

Energy Efficiency Rating		
	Current	Potential
Very energy efficient - lower running costs		
(92 plus) A		
(81-91) B		
(69-80) C		
(55-68) D		
(39-54) E		
(21-38) F		
(1-20) G		
Not energy efficient - higher running costs		
England & Wales		EU Directive 2002/91/EC

Disclaimer – In accordance with the Property Misdescriptions Act, the company gives notice that all descriptions, references to condition, necessary permissions for use and other details are given in good faith and believed to be correct, but any intending lessees do not rely on them as statements of fact, but must satisfy themselves by inspection or other means, as to their accuracy.



abbotFox presents this four-bedroom student property located in a popular residential area only moments from the UEA. This property has newly been landscaped both front and back and within easy access of amenities. This spacious furnished home features well-proportioned rooms, the master with an en-suite and a new family bathroom, with plenty of natural light, a fully fitted kitchen, lounge, utility room and large rear garden.

The much sought after area only moments from the Norfolk and Norwich Hospital and the University of East Anglia are within easy reach of the property and there is good access to the A11 and A47 Southern Bypass.

