

abbotFox





Heath Road, Hockering  
*£2,300 PCM*

“

We are a team of genuine individuals who hold a deep passion for both property and marketing. Collectively, we bring over 70 years of experience in the property market of Norfolk and Suffolk. Our affection for both counties runs deep, and we are enthusiastic about sharing our passion with you.

Colin McKenzie | **Branch Partner**













## THE DETAIL\_\_\_\_\_

abbotFox presents this stunning Four Bedroom Barn,

Upon arrival at North Barn, tenants are welcomed into an impressive entrance hall leading to generous single-storey accommodation throughout.

The heart of the home is the elegant open-plan living space, ideal for both everyday living and entertaining. Flooded with natural light and enjoying uninterrupted countryside views, the sitting area features a newly installed wood burner, creating a warm and inviting atmosphere. The contemporary kitchen offers ample cupboard and worktop space, a central island, Rangemaster cooker with induction hob, LG fridge freezer, pantry cupboard and space for a dishwasher. A separate utility room provides space for a washing machine and tumble dryer.

The principal bedroom is a generous double room with fitted wardrobes, a luxury en-suite shower room and French doors opening onto a private al fresco patio area. The second bedroom also benefits from its own en-suite. Bedrooms three and four are further well-proportioned doubles with fitted wardrobes and offer flexibility for use as home offices if required. These are served by the main bathroom, complete with a shower over bath.

Externally, the property is approached via a private driveway providing parking for up to four vehicles and an EV charging point. The courtyard-style garden has been thoughtfully landscaped and includes a rustic outdoor shower, all set within peaceful Norfolk countryside surroundings.











## THE HIGHLIGHTS\_\_

- Bespoke Fitted Kitchen with Central Island
- Four Double Bedrooms with Two En-Suite Facilities
- Stylish Scandi Style Finish
- Tranquil Setting with Enchanting Countryside Aspect
- Elegant Open Plan Living Space

Approx Gross Internal Area  
169 sq m / 1818 sq ft

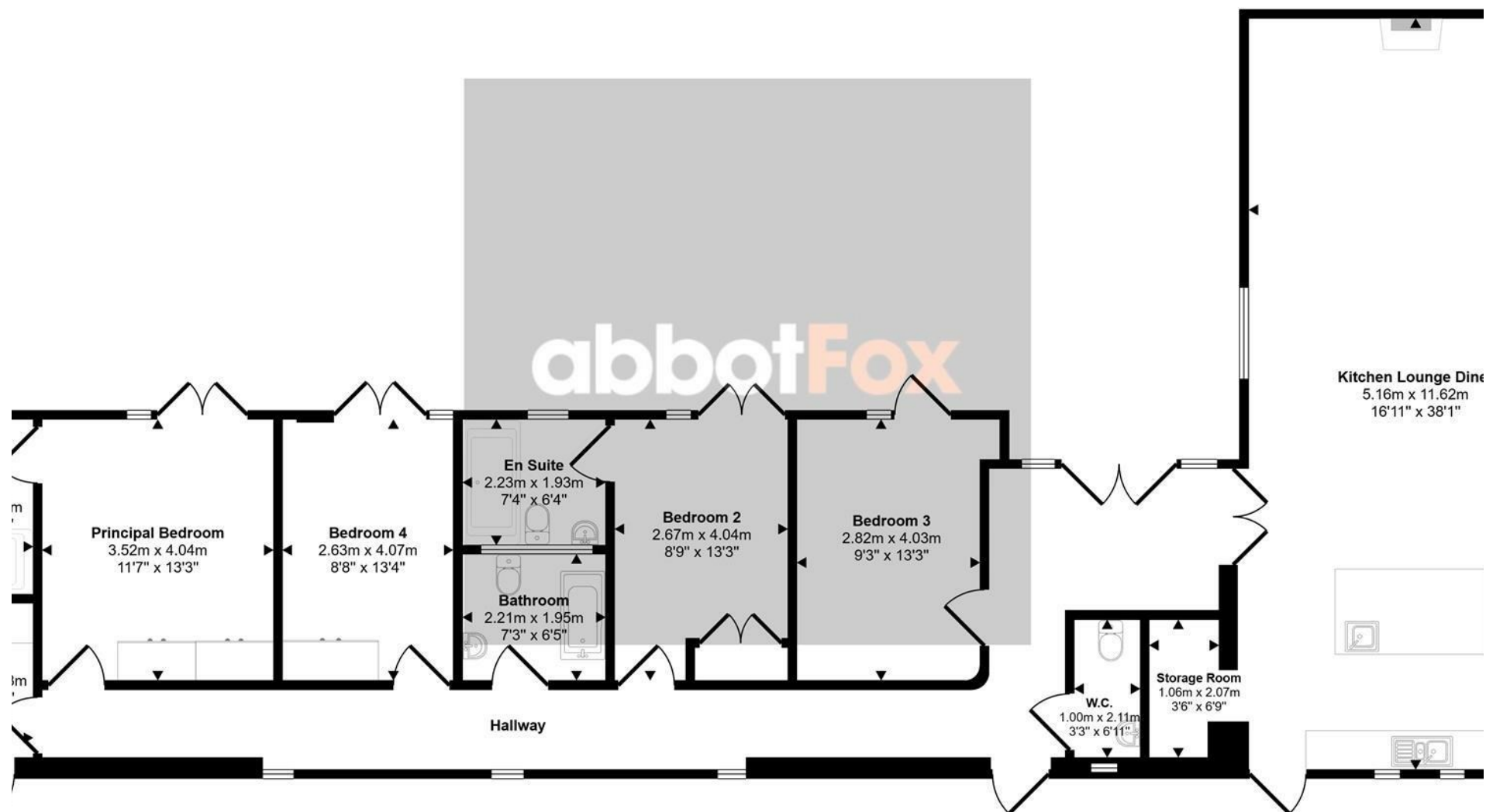

This floorplan is only for illustrative purposes and is not to scale. Measurements of rooms, doors, windows, and any items are approximate and no responsibility is taken for any error, omission or mis-statement. Icons of items such as bathroom suites are representations only and may not look like the real items. Made with Made Snappy 360.

*Let's talk*

01603 660000

[sales@abbotfox.co.uk](mailto:sales@abbotfox.co.uk)

@abbotfox

EPC RATING -

Disclaimer – In accordance with the Property Misdescriptions Act, the company abbotFox gives notice that all descriptions, references to condition, necessary permissions for use and other details are given in good faith and believed to be correct, but any purchaser should not rely on them as statements of fact, and must satisfy themselves by inspection or other means, as to their accuracy.