

abbotFox





Costessey, NR8  
£215,000

“

We are a team of genuine individuals who hold a deep passion for both property and marketing. Collectively, we bring over 70 years of experience in the property market of Norfolk and Suffolk. Our affection for both counties runs deep, and we are enthusiastic about sharing our passion with you.

Colin McKenzie | **Branch Partner**









## THE DETAIL\_\_\_\_\_

abbotFox presents this stylish two-bedroom semi-detached home, located within the ever-popular Queens Hills development.

Well presented throughout, this home offers an inviting entrance hall, a modern fitted kitchen, and a spacious lounge diner with French doors opening onto the private rear garden. Upstairs, two generous bedrooms are complemented by a contemporary family bathroom.

Externally, the property benefits from an enclosed rear garden and the convenience of off-road parking set to the rear.

Situated within easy reach of local amenities, schools, and excellent transport links into Norwich, this property represents an ideal opportunity for first-time buyers, young professionals, or those looking to downsize without compromise.









## THE HIGHLIGHTS\_\_\_\_



- Ideal first time buy
- Semi-detached house
- Two double bedrooms
- Popular residential location
- Two allocated parking spaces
- Viewing advised

Approx Gross Internal Area  
53 sq m / 572 sq ft

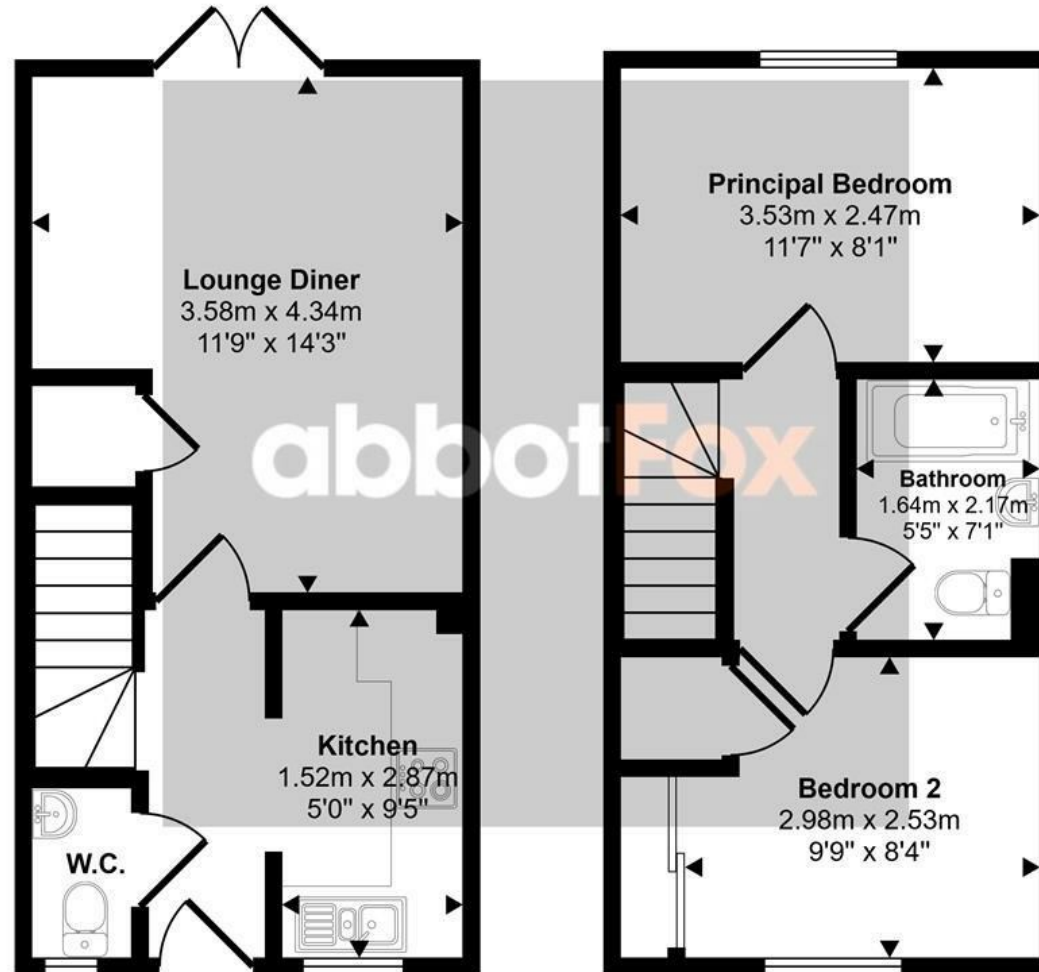

Ground Floor  
Approx 27 sq m / 288 sq ft

First Floor  
Approx 26 sq m / 284 sq ft

This floorplan is only for illustrative purposes and is not to scale. Measurements of rooms, doors, windows, and any items are approximate and no responsibility is taken for any error, omission or mis-statement. Icons of items such as bathroom suites are representations only and may not look like the real items. Made with Made Snappv 360.

*Let's talk*

01603 660000

[sales@abbotfox.co.uk](mailto:sales@abbotfox.co.uk)

@abbotfox

EPC RATING - C

Disclaimer – In accordance with the Property Misdescriptions Act, the company abbotFox gives notice that all descriptions, references to condition, necessary permissions for use and other details are given in good faith and believed to be correct, but any purchaser should not rely on them as statements of fact, and must satisfy themselves by inspection or other means, as to their accuracy.