

abbotFox



Arthurton Road, Spixworth, Norwich
£1,100

“

We are a team of genuine individuals who hold a deep passion for both property and marketing. Collectively, we bring over 70 years of experience in the property market of Norfolk and Suffolk. Our affection for both counties runs deep, and we are enthusiastic about sharing our passion with you.

Colin McKenzie | **Branch Partner**







THE DETAIL_____

abbotFox presents this three bedroom semi-detached house. Located within the popular and well serviced village of Spixworth, this home represents an ideal opportunity for any professional couple or young family.

The accommodation is neatly arranged over two floors, and comprises; entrance hall, downstairs WC, lounge diner and kitchen to the ground floor, with three bedrooms and a family bathroom accessed off landing. Externally, the property benefits from an enclosed rear garden and off road parking.

An early viewing comes highly recommended.







THE HIGHLIGHTS__

- Semi-detached house
- Three bedrooms
- Generous living accommodation
- Popular location
- Close to local amenities
- Viewing advised

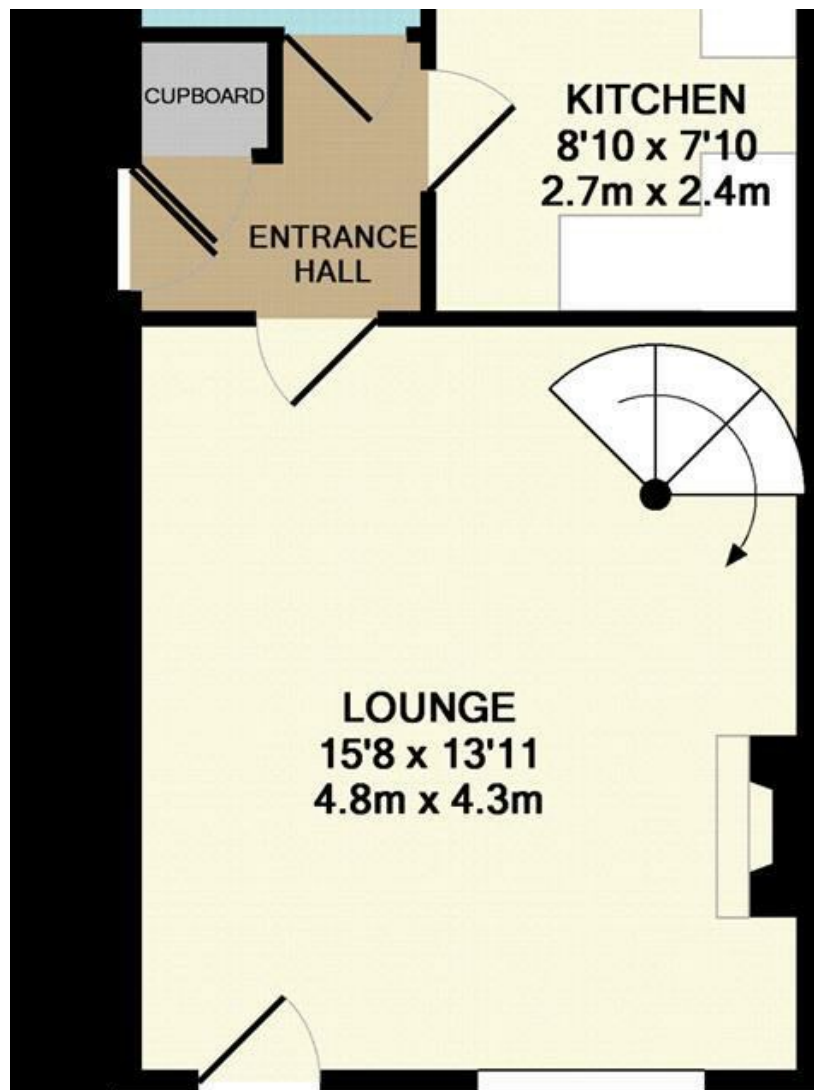

GROUND FLOOR

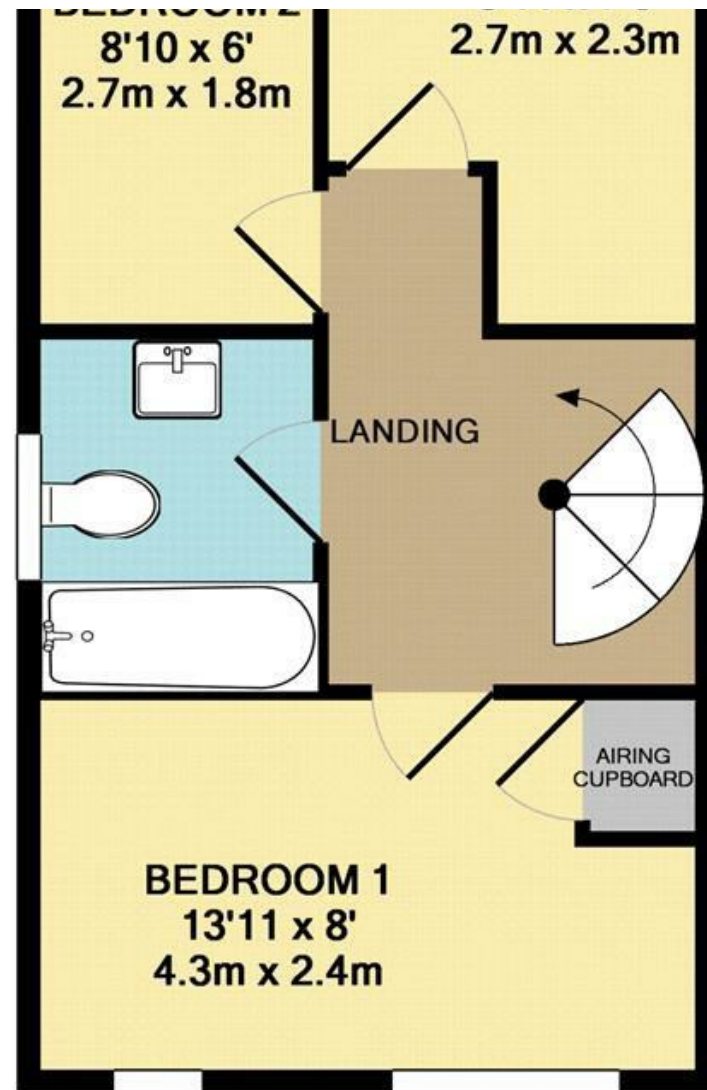

1ST FLOOR

EPC RATING -

Disclaimer – In accordance with the Property Misdescriptions Act, the company abbotFox gives notice that all descriptions, references to condition, necessary permissions for use and other details are given in good faith and believed to be correct, but any purchaser should not rely on them as statements of fact, and must satisfy themselves by inspection or other means, as to their accuracy.

Let
01603 660000
sales@abbotfox.co.uk
@abbotfox