

abbotFox



City Centre, NR1
£250,000

“

We are a team of genuine individuals who hold a deep passion for both property and marketing. Collectively, we bring over 70 years of experience in the property market of Norfolk and Suffolk. Our affection for both counties runs deep, and we are enthusiastic about sharing our passion with you.

Colin McKenzie | **Branch Partner**







THE DETAIL_____

abbotFox presents this superbly positioned two-bedroom apartment, set within the sought-after Skipper House development, offering stunning views towards Norwich Cathedral and the city skyline.

Located on the second floor, this stylish home offers generous, light-filled living spaces ideal for modern city living. The open-plan kitchen, living, and dining area is finished to a high standard and perfectly placed to enjoy the iconic Cathedral views.

Both bedrooms are well-proportioned, with the principal bedroom benefitting from an en-suite shower room. The sleek, contemporary bathroom adds to the overall sense of quality throughout the home. Further highlights include a secure entry system, lift access, and a valuable allocated parking space.

Positioned moments from Norwich train station, the Riverside development offers an unrivalled blend of city living with riverside walks, bars, restaurants, and shopping facilities all on the doorstep.

Agents note: additional internal images to follow.

THE HIGHLIGHTS____

- Stylish apartment
- Two double bedrooms
- En-suite shower room
- Secure allocated parking
- City and Cathedral views
- No onward chain
- Internal viewing advised

Approx Gross Internal Area
73 sq m / 783 sq ft

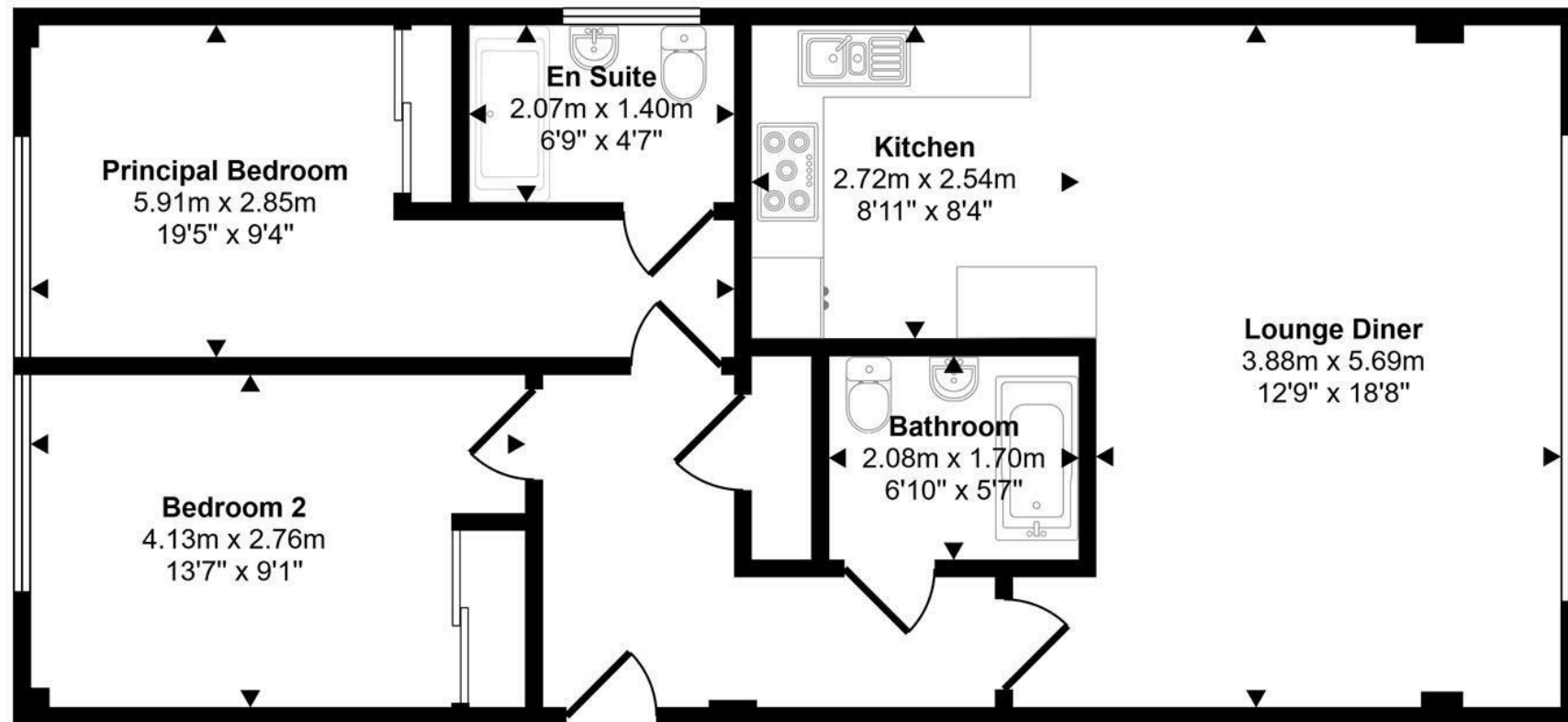

Floorplan

This floorplan is only for illustrative purposes and is not to scale. Measurements of rooms, doors, windows, and any items are approximate and no responsibility is taken for any error, omission or mis-statement. Icons of items such as bathroom suites are representations only and may not look like the real items. Made with Made Snappy 360.

Let's talk

01603 660000

sales@abbotfox.co.uk

@abbotfox

EPC RATING -

Disclaimer – In accordance with the Property Misdescriptions Act, the company abbotFox gives notice that all descriptions, references to condition, necessary permissions for use and other details are given in good faith and believed to be correct, but any purchaser should not rely on them as statements of fact, and must satisfy themselves by inspection or other means, as to their accuracy.