

abbotFox

SENTINEL HOUSE



Norwich's City Centre, NR1
Guide £190,000

“

We are a team of genuine individuals who hold a deep passion for both property and marketing. Collectively, we bring over 70 years of experience in the property market of Norfolk and Suffolk. Our affection for both counties runs deep, and we are enthusiastic about sharing our passion with you.

Colin McKenzie | **Branch Partner**







THE DETAIL_____

abbotFox presents this immaculate two-bedroom ground floor apartment enjoying a prime position within Norwich's city centre.

Light and airy rooms briefly comprise; an entrance hall, an open plan kitchen living space, two large double bedrooms and a modern shower room.

The kitchen comes complete with a washer dryer, fridge/freezer, electric oven and hob.

Features include a silent internal ventilation system and secure entry system. There is an on-site gym available to residents only, as well as a resident's lounge.

The property benefits from good quality fitted blinds and could, subject to the offer made come complete with furniture.

Sentinel House enjoys a convenient, prime central Norwich location, an ideal first purchase, bolt hole or buy to let having achieved £1,400pcm previously.

Guide Price £190,000 - £200,000







THE HIGHLIGHTS____

- City centre opposite John Lewis
- Concierge Service
- Two double bedrooms
- Open plan living space
- Modern kitchen
- Large shower room
- A great buy to let having been let recently at £1,400pcm
- Resident's lounge and gym
- No onward chain
- Guide Price £200,000 - £215,000

Approx Gross Internal Area
54 sq m / 582 sq ft

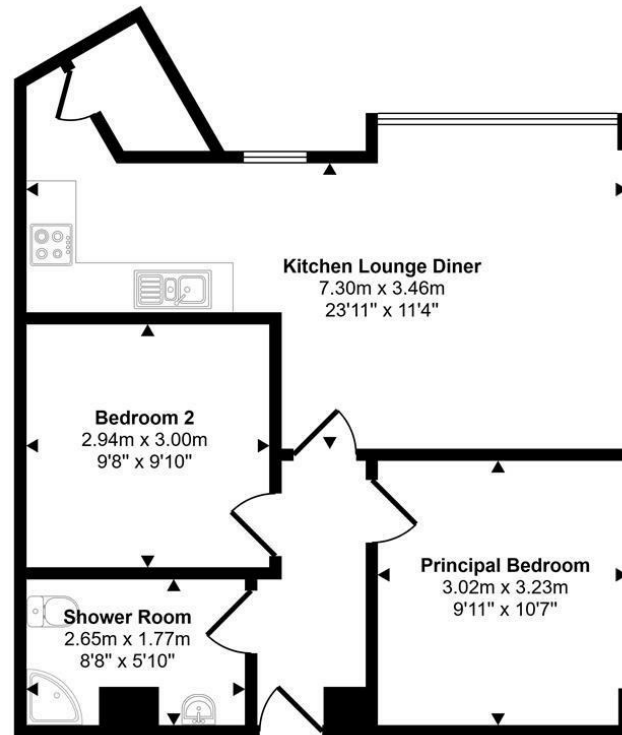

Floorplan

This floorplan is only for illustrative purposes and is not to scale. Measurements of rooms, doors, windows, and any items are approximate and no responsibility is taken for any error, omission or mis-statement. Icons of items such as bathroom suites are representations only and may not look like the real items. Made with Made Snappy 360.

Let's talk

01603 660000

sales@abbotfox.co.uk

@abbotfox

EPC RATING -

Disclaimer – In accordance with the Property Misdescriptions Act, the company abbotFox gives notice that all descriptions, references to condition, necessary permissions for use and other details are given in good faith and believed to be correct, but any purchaser should not rely on them as statements of fact, and must satisfy themselves by inspection or other means, as to their accuracy.