

abbotFox



Norwich, NR2

Asking Price £115,000

“

We are a team of genuine individuals who hold a deep passion for both property and marketing. Collectively, we bring over 70 years of experience in the property market of Norfolk and Suffolk. Our affection for both counties runs deep, and we are enthusiastic about sharing our passion with you.

Colin McKenzie | **Branch Partner**







THE DETAIL_____

****NO ONWARD CHAIN****

****GUIDE PRICE: £115,000 - £120,000****

abbotFox presents this light and airy top floor apartment overlooking the communal gardens and adjacent park. Accommodation comprises of an open plan lounge dining room, separate kitchen, generous double bedroom and three piece bathroom. To the outside there is allocated parking and communal gardens.

The property is conveniently located close to the city centre of Norwich with its blend of historical buildings and modern shops, including the Norman Castle, magnificent Cathedral, Chapelfield and Castle Mall together with the bustling market place and pretty lanes with boutique shopping.

An ideal home for any first time buyer, an internal viewing comes highly recommended.

THE HIGHLIGHTS____

- Top floor apartment
- Generous living accommodation
- Convenient location
- Ideal first time buy
- Viewing advised

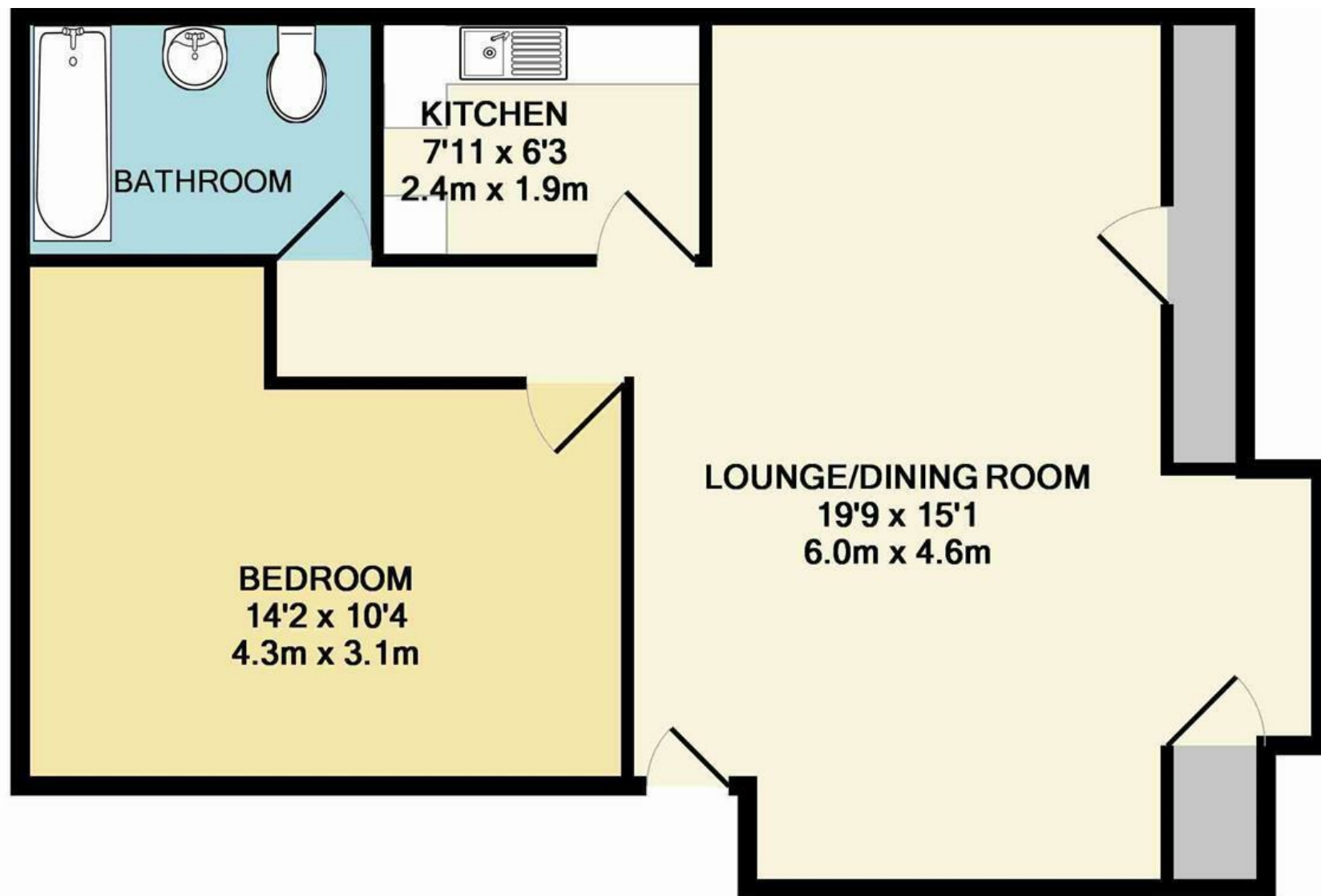

Whilst every attempt has been made to ensure the accuracy of the floor plan contained here, measurements of doors, windows, rooms and any other items are approximate and no responsibility is taken for any error, omission, or mis-statement. This plan is for illustrative purposes only and should be used as such by any

Let's talk

01603 660000

sales@abbotfox.co.uk

@abbotfox

EPC RATING - C

Disclaimer – In accordance with the Property Misdescriptions Act, the company abbotFox gives notice that all descriptions, references to condition, necessary permissions for use and other details are given in good faith and believed to be correct, but any purchaser should not rely on them as statements of fact, and must satisfy themselves by inspection or other means, as to their accuracy.