

abbotFox



Appleton Drive, Ormesby, Great Yarmouth
Guide Price £260,000

“

We are a team of genuine individuals who hold a deep passion for both property and marketing. Collectively, we bring over 70 years of experience in the property market of Norfolk and Suffolk. Our affection for both counties runs deep, and we are enthusiastic about sharing our passion with you.

Colin McKenzie | **Branch Partner**







THE DETAIL_____

abbotFox presents this renovated detached bungalow. Set within the desirable village of Ormesby within the heart of the picturesque Norfolk Broads, this home has been thoughtfully and stylishly renovated by the current owners.

The internal accommodation comprises; entrance hall, lounge, kitchen diner, two double bedrooms and a family bathroom. Externally, the generous frontage allows for ample off road parking and leads to the detached garage. The enclosed rear garden offers a high degree of privacy and potential for extension (STPP).

The property has an air source heat pump and solar panels offering cheaper running costs.

An internal viewing comes highly recommended.

Guide price £260,000 - £270,000







THE HIGHLIGHTS____

- Detached bungalow
- Two double bedrooms
- Generous private gardens
- High quality finish throughout
- Sought after village
- Viewing advised
- Guide price £270,000 - £280,000

Approx Gross Internal Area
63 sq m / 676 sq ft

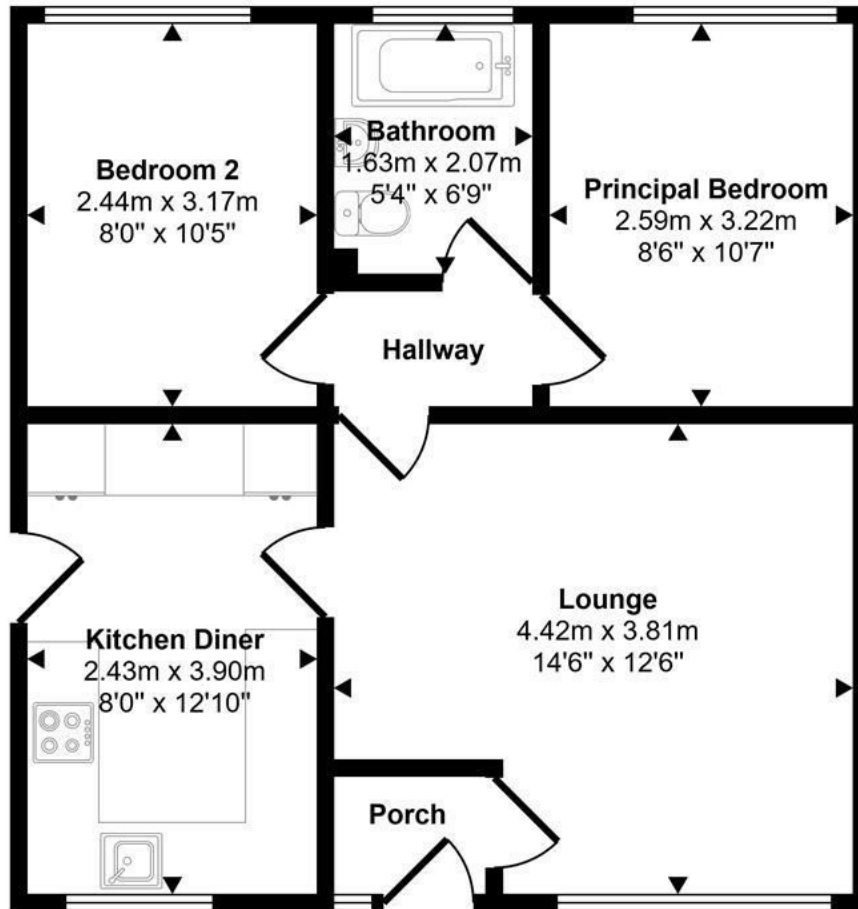

Floorplan

Approx 50 sq m / 539 sq ft

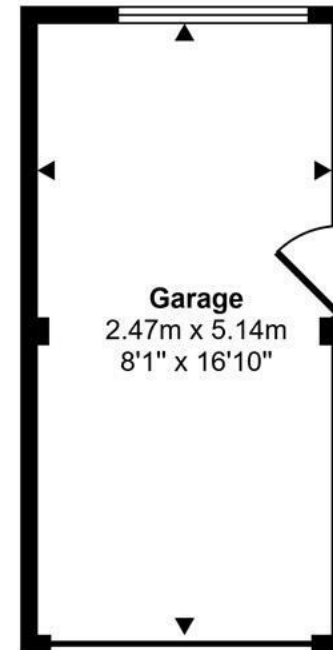

Garage

Approx 13 sq m / 137 sq ft

This floorplan is only for illustrative purposes and is not to scale. Measurements of rooms, doors, windows, and any items are approximate and no responsibility is taken for any error, omission or mis-statement. Icons of items such as bathroom suites are representations only and may not look like the real items. Made with Made Snappy 360.

Let's talk

01603 660000

sales@abbotfox.co.uk

@abbotfox

EPC RATING - B

Disclaimer – In accordance with the Property Misdescriptions Act, the company abbotFox gives notice that all descriptions, references to condition, necessary permissions for use and other details are given in good faith and believed to be correct, but any purchaser should not rely on them as statements of fact, and must satisfy themselves by inspection or other means, as to their accuracy.