

abbotFox





Southwell Road, Norwich  
*£155,000*

“

We are a team of genuine individuals who hold a deep passion for both property and marketing. Collectively, we bring over 70 years of experience in the property market of Norfolk and Suffolk. Our affection for both counties runs deep, and we are enthusiastic about sharing our passion with you.

Colin McKenzie | **Branch Partner**













## THE DETAIL\_\_\_\_\_

abbotFox presents this chain free, first floor apartment. Set within walking distance to Norwich City Centre and a wealth of local amenities, this home affords a high degree of convenience for any occupant.

The accommodation is neatly arranged and comprises; entrance hall, lounge diner, kitchen, two double bedrooms and a re-fitted family shower room. The property further benefits from a private balcony and a secure storage shed. On-street permit parking is also available.

An ideal opportunity for any first time buyer or buy-to-let investor, an internal viewing comes highly recommended.





## THE HIGHLIGHTS\_\_\_\_

- First floor apartment
- Two bedrooms
- Private balcony
- Convenient location
- Ideal first time buy
- No onward chain

Approx Gross Internal Area  
62 sq m / 668 sq ft

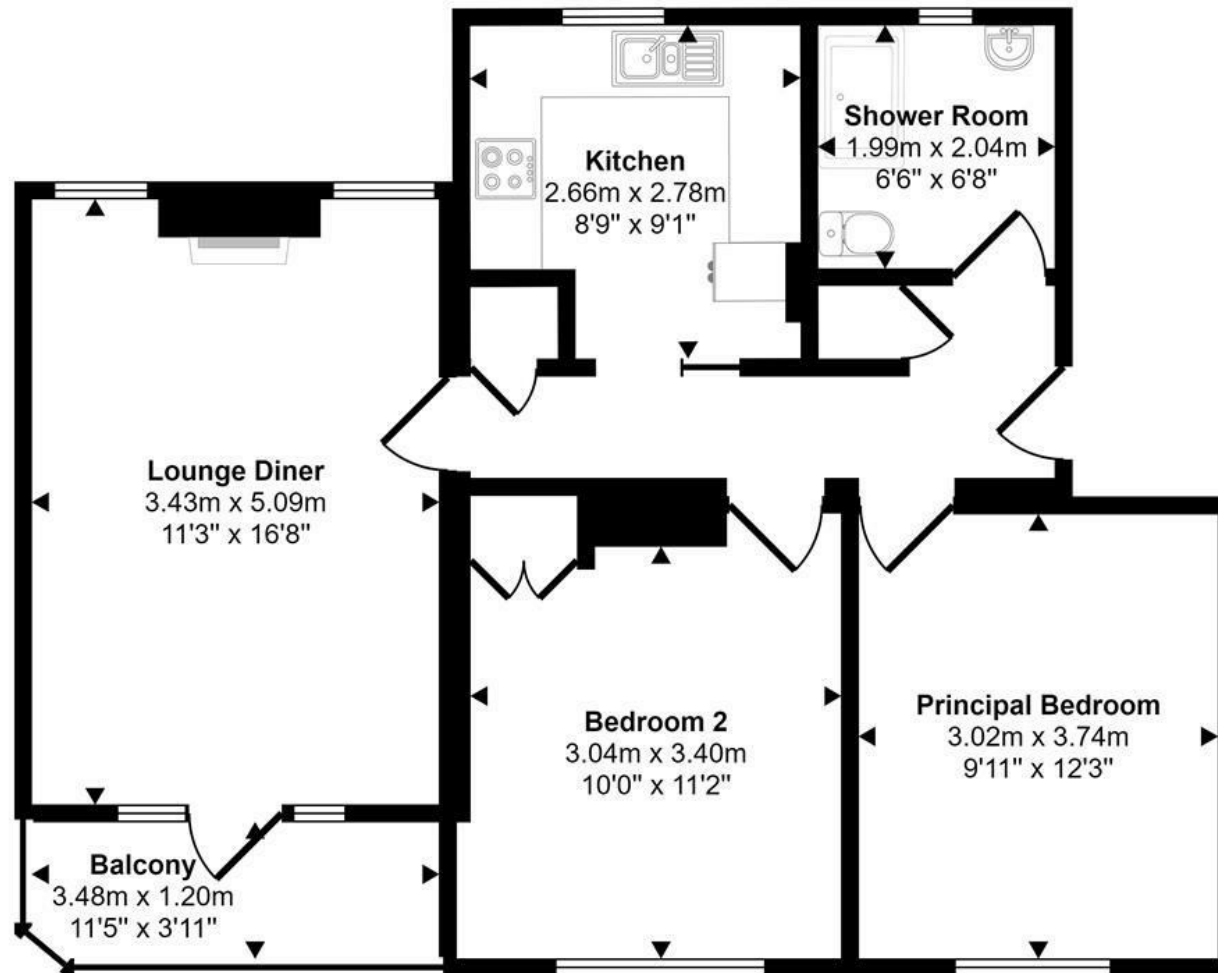

Floorplan

*Let's talk*

01603 660000

sales@abbotfox.co.uk

@abbotfox

This floorplan is only for illustrative purposes and is not to scale. Measurements of rooms, doors, windows, and any items are approximate and no responsibility is taken for any error, omission or mis-statement. Icons of items such as bathroom suites are representations only and

EPC RATING - C

Disclaimer – In accordance with the Property Misdescriptions Act, the company abbotFox gives notice that all descriptions, references to condition, necessary permissions for use and other details are given in good faith and believed to be correct, but any purchaser should not rely on them as statements of fact, and must satisfy themselves by inspection or other means, as to their accuracy.