

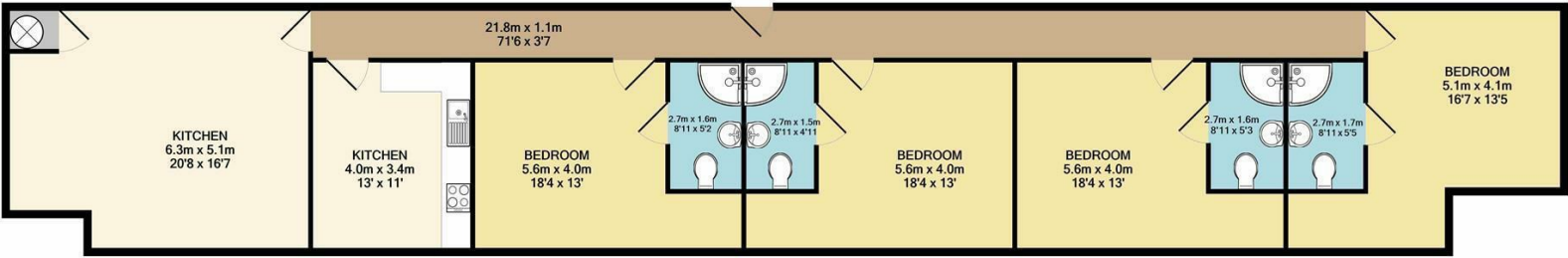

Surrey Street | Norwich | NR1
PCM £3,100 PCM



Whilst every attempt has been made to ensure the accuracy of the floor plan contained here, measurements of doors, windows, rooms and any other items are approximate and no responsibility is taken for any error, omission, or mis-statement. This plan is for illustrative purposes only and should be used as such by any prospective purchaser. The services, systems and appliances shown have not been tested and no guarantee as to their operability or efficiency can be given.
Made with Metrofox ©2020

Energy Efficiency Rating		
	Current	Potential
Very energy efficient - lower running costs		
(92 plus) A		
(81-91) B		
(69-80) C		
(55-68) D		
(39-54) E		
(21-38) F		
(1-20) G		
Not energy efficient - higher running costs		
England & Wales		EU Directive 2002/91/EC

Disclaimer – In accordance with the Property Misdescriptions Act, the company gives notice that all descriptions, references to condition, necessary permissions for use and other details are given in good faith and believed to be correct, but any intending lessees do not rely on them as statements of fact, but must satisfy themselves by inspection or other means, as to their accuracy.



*** Student let ***

abbotFox presents this stunning top floor PENTHOUSE apartment. This is one of just four penthouse apartments occupying an exclusive area of the top floor. The apartment itself provides an exceptionally large sitting room, kitchen dining room and FOUR DOUBLE BEDROOMS all featuring en suites.

Sentinel House is our cities newest and most exciting residential development offering something Norwich has never seen before delivering outstanding modern living with a concierge service, well-equipped residents' gym and residents' lounge all within Norwich's vibrant city centre.

Submersed in the city centre within easy walking of Norwich's nationally acclaimed shopping facilities, quirky cafes and restaurants, exciting nightlife and its quintessential culture and history. An ideal match for students in touching distance of both the bus and train stations with regular bus services to the University of East Anglia.

