

abbotFox





Wherry Road, Norwich  
*Guide Price £170,000*

“

We are a team of genuine individuals who hold a deep passion for both property and marketing. Collectively, we bring over 70 years of experience in the property market of Norfolk and Suffolk. Our affection for both counties runs deep, and we are enthusiastic about sharing our passion with you.

Colin McKenzie | **Branch Partner**













## THE DETAIL\_\_\_\_\_

abbotFox presents this spacious first floor, purpose built apartment, set within the popular Riverside development, which is within easy reach of the Train station, Norwich City Centre and a wealth of amenities. The internal accommodation is neatly arranged and comprises; an inviting entrance hall, with secure telephone entry point, dual aspect open plan living accommodation, two double bedrooms, en-suite shower room and family bathroom. The property further benefits from a secure, allocated parking space. With a convenience hard to match, this home would make an ideal opportunity for any first time buyer or buy-to-let investor. An internal viewing comes highly recommended.

Guide price £170,000 - £180,000









## THE HIGHLIGHTS\_\_

- First floor, purpose built apartment
- Two double bedrooms
- Spacious open plan living
- Convenient location
- Ideal first time buy or investment opportunity
- Viewing advised
- Guide price £170,000 - £180,000

Approx Gross Internal Area  
57 sq m / 619 sq ft

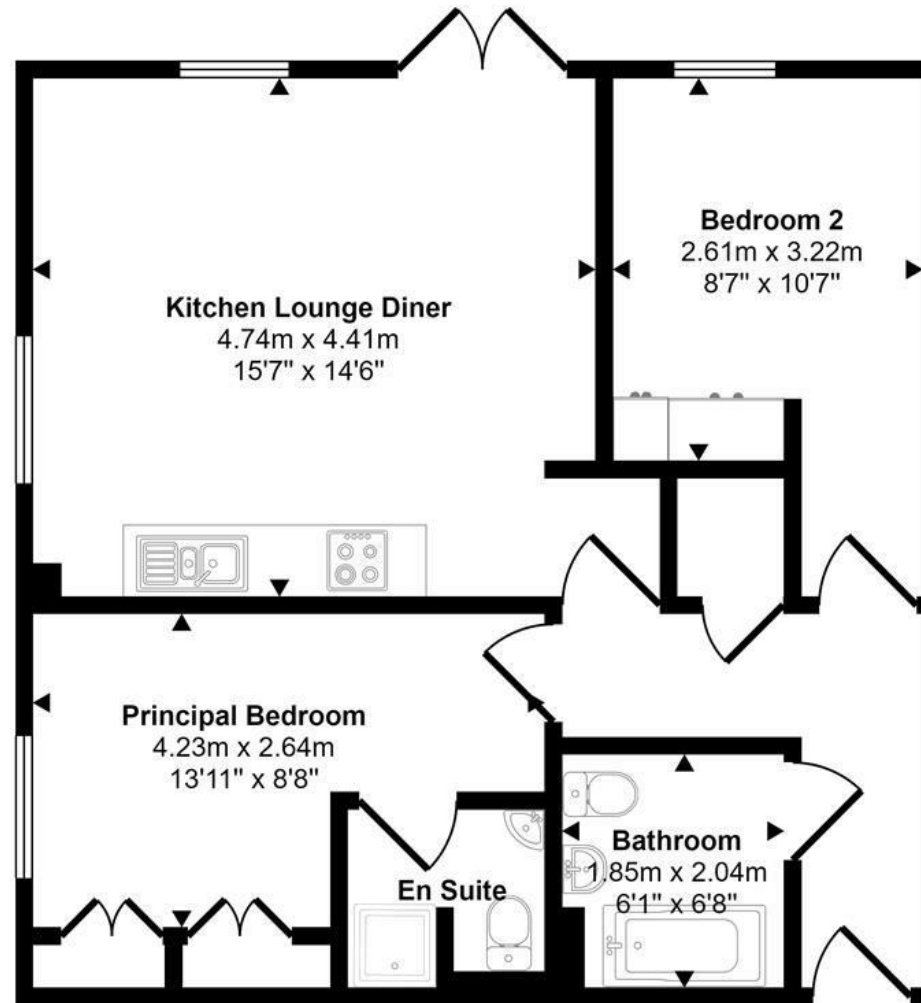

Floorplan

*Let's talk*

01603 660000

[sales@abbotfox.co.uk](mailto:sales@abbotfox.co.uk)

@abbotfox

This floorplan is only for illustrative purposes and is not to scale. Measurements of rooms, doors, windows, and any items are approximate and no responsibility is taken for any error, omission or mis-statement. Icons of items such as bathroom suites are representations only and

EPC RATING - B

Disclaimer – In accordance with the Property Misdescriptions Act, the company abbotFox gives notice that all descriptions, references to condition, necessary permissions for use and other details are given in good faith and believed to be correct, but any purchaser should not rely on them as statements of fact, and must satisfy themselves by inspection or other means, as to their accuracy.