

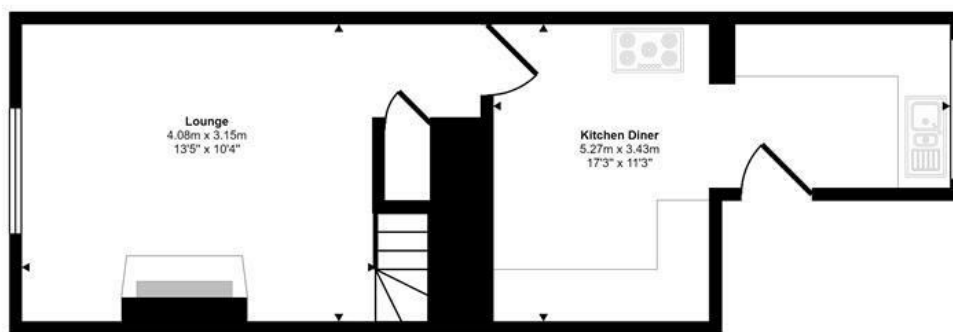

Brook Street | Buxton | NR10  
 Guide Price £210,000

abbotFox

Approx Gross Internal Area  
 70 sq m / 757 sq ft



Ground Floor  
 Approx 33 sq m / 351 sq ft

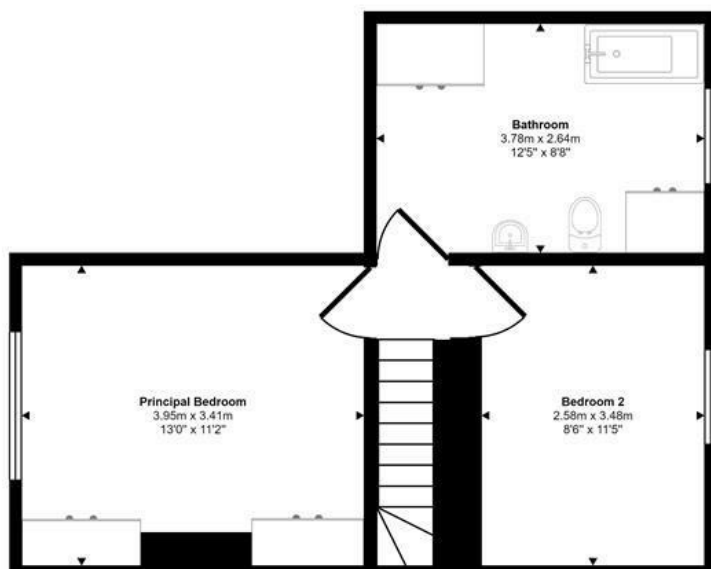

First Floor  
 Approx 38 sq m / 406 sq ft

This floorplan is only for illustrative purposes and is not to scale. Measurements of rooms, doors, windows, and any items are approximate and no responsibility is taken for any error, omission or mis-statement. Icons of items such as bathroom suites are representations only and may not look like the real items. Made with Made Snappy 360.

| Energy Efficiency Rating                    |  | Current                 | Potential |
|---|--|-------------------------|-----------|
| Very energy efficient - lower running costs |  |                         |           |
| (92 plus) A                                 |  |                         | 88        |
| (81-91) B                                   |  |                         |           |
| (69-80) C                                   |  | 67                      |           |
| (55-68) D                                   |  |                         |           |
| (39-54) E                                   |  |                         |           |
| (21-38) F                                   |  |                         |           |
| (1-20) G                                    |  |                         |           |
| Not energy efficient - higher running costs |  |                         |           |
| England & Wales                             |  | EU Directive 2002/91/EC |           |

Disclaimer – In accordance with the Property Misdescriptions Act, the company gives notice that all descriptions, references to condition, necessary permissions for use and other details are given in good faith and believed to be correct, but any intending lessees do not rely on them as statements of fact, but must satisfy themselves by inspection or other means, as to their accuracy.



abbotFox presents this pretty, mid terraced cottage set within the sought after and well serviced village of Buxton. With easy access to both Norwich, Aylsham and the picturesque Norfolk Broads, this home represents an ideal opportunity for any buyer looking to enjoy village life, or would make an exceptional holiday let or second home.

The property itself has been well maintained and thoughtfully improved by the current owners and perfectly blends character charm with modern convenience. The accommodation is neatly arranged over two floors, with a cosy lounge and stylish kitchen diner to the ground floor, with two bedrooms and a bathroom accessed off landing to the first floor. Externally, the property benefits from a private rear garden. An internal viewing comes highly recommended to appreciate this home.

Guide price £210,000 - £220,000

