

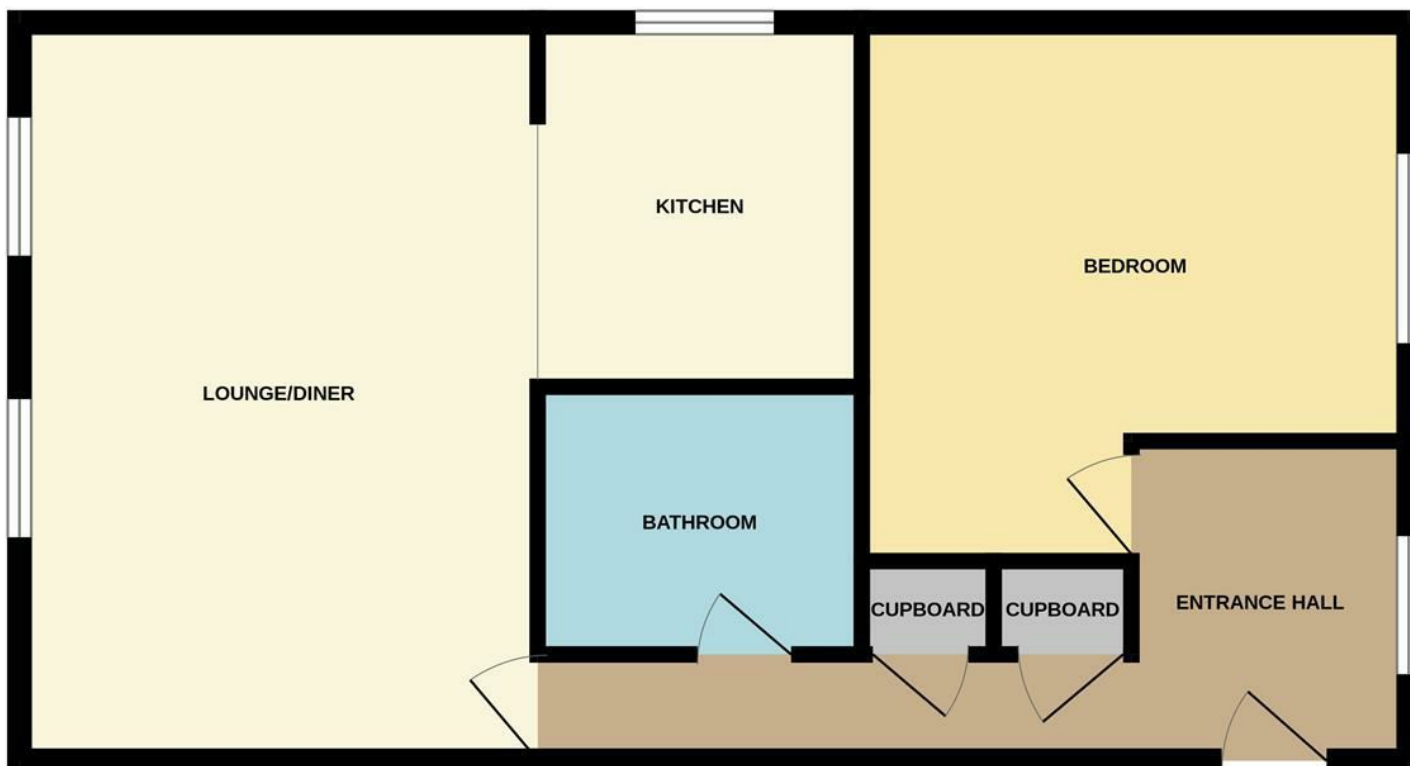

Bishop Pelham Court | Norwich | NR4
 £115,000

abbotFox

GROUND FLOOR
 53.9 sq.m. (581 sq.ft.) approx.



Energy Efficiency Rating		
	Current	Potential
Very energy efficient - lower running costs		
(92 plus) A		
(81-91) B		
(69-80) C		
(55-68) D		
(39-54) E		
(21-38) F		
(1-20) G		
Not energy efficient - higher running costs		
England & Wales	EU Directive 2002/91/EC	

Disclaimer – In accordance with the Property Misdescriptions Act, the company gives notice that all descriptions, references to condition, necessary permissions for use and other details are given in good faith and believed to be correct, but any intending lessees do not rely on them as statements of fact, but must satisfy themselves by inspection or other means, as to their accuracy.

TOTAL FLOOR AREA : 53.9 sq.m. (581 sq.ft.) approx.
 Whilst every attempt has been made to ensure the accuracy of the floorplan contained here, measurements of doors, windows, rooms and any other items are approximate and no responsibility is taken for any error, omission or mis-statement. This plan is for illustrative purposes only and should be used as such by any prospective purchaser. The services, systems and appliances shown have not been tested and no guarantee as to their operability or efficiency can be given.
 Made with Metropix ©2024



abbotfox presents this well presented one bedroom apartment, ideal for investment or first time buyers. Being situated within the prestigious Keswick Hall development. Accommodation comprises; entrance hall, lounge opening into kitchen, double bedroom and shower room. Keswick Hall, occupies a peaceful rural position, yet is within easy reach of Norwich City Centre. Residents have exclusive access to a wealth of facilities including tennis courts, heated swimming pool, well maintained communal grounds and sun terrace. An internal viewing comes highly recommended to appreciate this home.

