

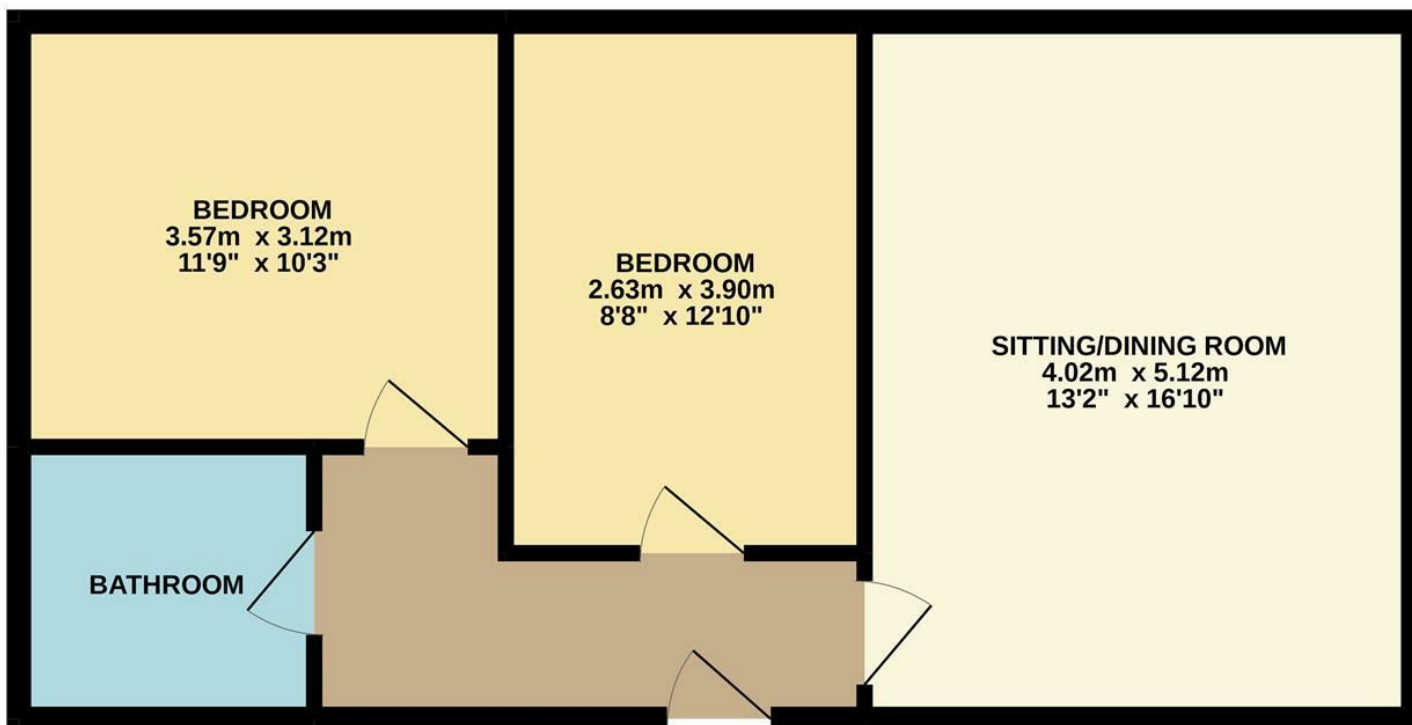

Fishers Lane | Norwich | NR2  
PCM £1,100 PCM

abbotFox

GROUND FLOOR  
52.3 sq.m. (563 sq.ft.) approx.



TOTAL FLOOR AREA : 52.3 sq.m. (563 sq.ft.) approx.

Whilst every attempt has been made to ensure the accuracy of the floorplan contained here, measurements of doors, windows, rooms and any other items are approximate and no responsibility is taken for any error, omission or mis-statement. This plan is for illustrative purposes only and should be used as such by any prospective purchaser. The services, systems and appliances shown have not been tested and no guarantee as to their operability or efficiency can be given.  
Made with Metropix ©2021

Energy Efficiency Rating		
	Current	Potential
<i>Very energy efficient - lower running costs</i>		
(92 plus) <b>A</b>		
(81-91) <b>B</b>		
(69-80) <b>C</b>		
(55-68) <b>D</b>		
(39-54) <b>E</b>		
(21-38) <b>F</b>		
(1-20) <b>G</b>		
<i>Not energy efficient - higher running costs</i>		
<b>England &amp; Wales</b>	EU Directive 2002/91/EC	

Disclaimer – In accordance with the Property Misdescriptions Act, the company gives notice that all descriptions, references to condition, necessary permissions for use and other details are given in good faith and believed to be correct, but any intending lessees do not rely on them as statements of fact, but must satisfy themselves by inspection or other means, as to their accuracy.



abbotFox presents Vantage House, our cities newest and most exciting residential development offering something Norwich has never seen before. Within the cultivated walls of this iconic landmark, Vantage House delivers outstanding modern living within Norwich's vibrant city centre. Its pioneering renovation has unearthed 44 stunning apartments from a very well known office building and is being marketed exclusively with abbotFox.

Vantage House is fully submersed in the city centre and empowers walking ease of Norwich's nationally acclaimed shopping facilities, quirky cafes and restaurants, exciting nightlife and its quintessential culture and history. The apartments are an ideal match for commuters, who need to reside within touching distance of both the bus and train station.

Contemporary specification has ensured that Vantage House weds effortlessly with the buildings heritage past. This exclusive development has been meticulously presented and offers authentic living space, perfect for city dwellers who are seeking a home in the urban centre.

Expert design has maximised space and lighting throughout five floors. Vantage House provides an impressive ensemble of one and two bedroom apartments. Each one has been systematically calculated to ensure the very best of contemporary comforts.

The developed blueprints guarantee that all apartments are fitted with modern appliances and stylish finishes. The more prominent floors also permit breath taking scenic views over Norwich's metropolitan skyline.

Early enquiries are encouraged to avoid disappointment.

