

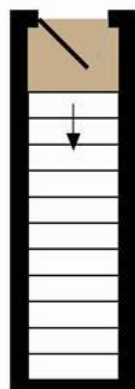

Windmill Court | Norwich | NR3  
 £135,000

abbotFox



ENTRANCE FLOOR

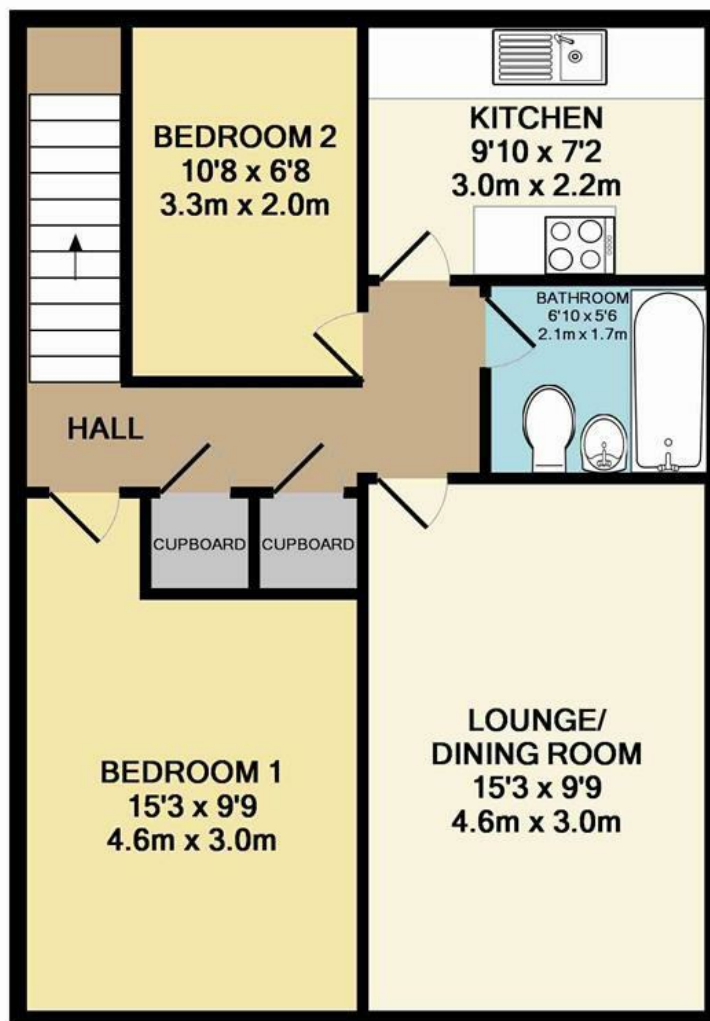

GROUND FLOOR

Whilst every attempt has been made to ensure the accuracy of the floor plan contained here, measurements of doors, windows, rooms and any other items are approximate and no responsibility is taken for any error, omission, or mis-statement. This plan is for illustrative purposes only and should be used as such by any prospective purchaser. The services, systems and appliances shown have not been tested and no guarantee as to their operability or efficiency can be given  
 Made with Metropix ©2015

Energy Efficiency Rating		
	Current	Potential
Very energy efficient - lower running costs		
(92 plus) <b>A</b>		
(81-91) <b>B</b>		
(69-80) <b>C</b>		
(55-68) <b>D</b>		
(39-54) <b>E</b>		
(21-38) <b>F</b>		
(1-20) <b>G</b>		
Not energy efficient - higher running costs		
	61	79
<b>England &amp; Wales</b>	EU Directive 2002/91/EC	

Disclaimer – In accordance with the Property Misdescriptions Act, the company gives notice that all descriptions, references to condition, necessary permissions for use and other details are given in good faith and believed to be correct, but any intending lessees do not rely on them as statements of fact, but must satisfy themselves by inspection or other means, as to their accuracy.



abbotFox presents this first floor, two double bedroom flat. Set within easy reach of a wealth of local amenities, this home offers a high degree of convenience and would be a perfect first time buy or buy-to-let investment opportunity. An internal viewing comes highly recommended.

The NR3 area of Norwich is served by a range of local amenities and regular bus services into the city centre. Norwich train station is approximately a mile away with daily services to Cambridge and London and Mousehold Heath is close by which is popular with walkers and runners alike.

Guide price £135,000 - £145,000

