

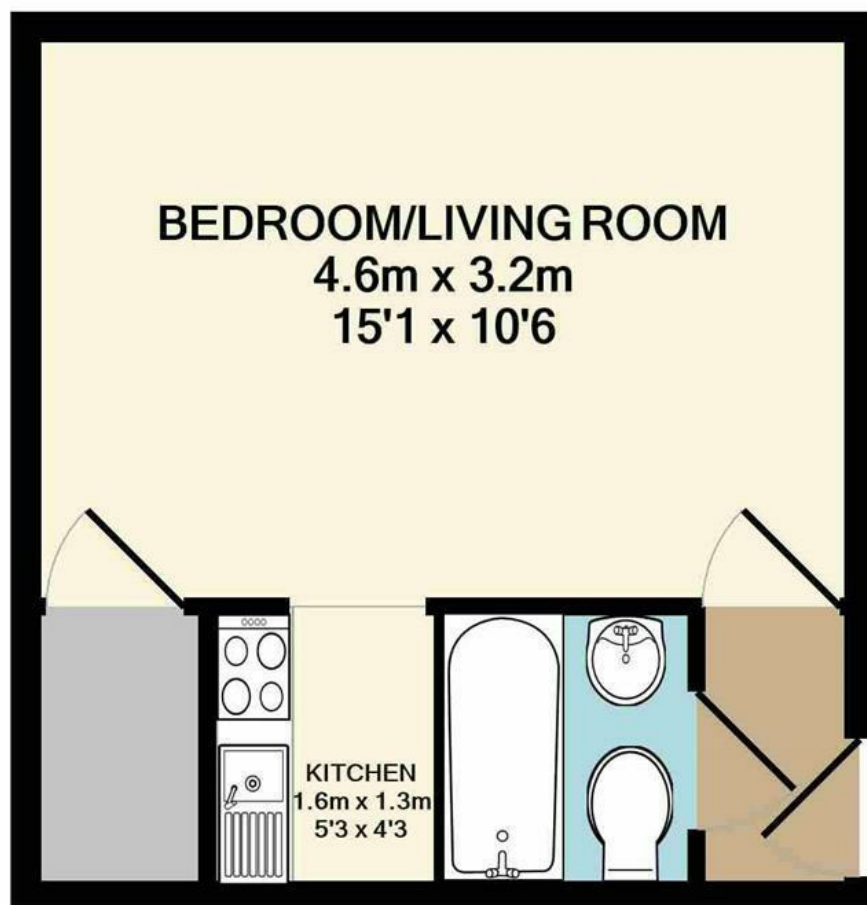

Earlham Road | Norwich | NR2
 Guide Price £70,000

abbotFox



Energy Efficiency Rating		
	Current	Potential
Very energy efficient - lower running costs		
(92 plus) A		
(81-91) B		
(69-80) C		
(55-68) D		64
(39-54) E	26	
(21-38) F		
(1-20) G		
Not energy efficient - higher running costs		
England & Wales		EU Directive 2002/91/EC

Disclaimer – In accordance with the Property Misdescriptions Act, the company gives notice that all descriptions, references to condition, necessary permissions for use and other details are given in good faith and believed to be correct, but any intending lessees do not rely on them as statements of fact, but must satisfy themselves by inspection or other means, as to their accuracy.

TOTAL APPROX. FLOOR AREA 22.1 SQ.M. (238 SQ.FT.)

Whilst every attempt has been made to ensure the accuracy of the floor plan contained here, measurements of doors, windows, rooms and any other items are approximate and no responsibility is taken for any error, omission, or mis-statement. This plan is for illustrative purposes only and should be used as such by any prospective purchaser. The services, systems and appliances shown have not been tested and no guarantee as to their operability or efficiency can be given

Made with Metropix ©2020



abbotFox presents this studio apartment located within the popular Golden Triangle, and affording easy access to a wealth of local amenities. With the Norfolk and Norwich Hospital and the University of East Anglia within easy reach of the property and with good access to the A11 and A47 Southern Bypass, an internal viewing comes highly recommended.

The highly sought after NR2 area of Norwich sits just to the west of the City Centre. Providing a wide range of amenities such as a Co-op, a Tesco Express, restaurants, takeaways and several parks. The NR2 area is also famed for its fantastic selection of public houses and a high number of local independent retailers. The vibrant City of Norwich is accessible by foot or a variety of regular bus routes are available including services to the City Centre, University of East Anglia, Norwich & Norfolk Hospital and many more making this location highly convenient for travelling in and around Norwich and the County of Norfolk.

Guide price £70,000 - £80,000

