

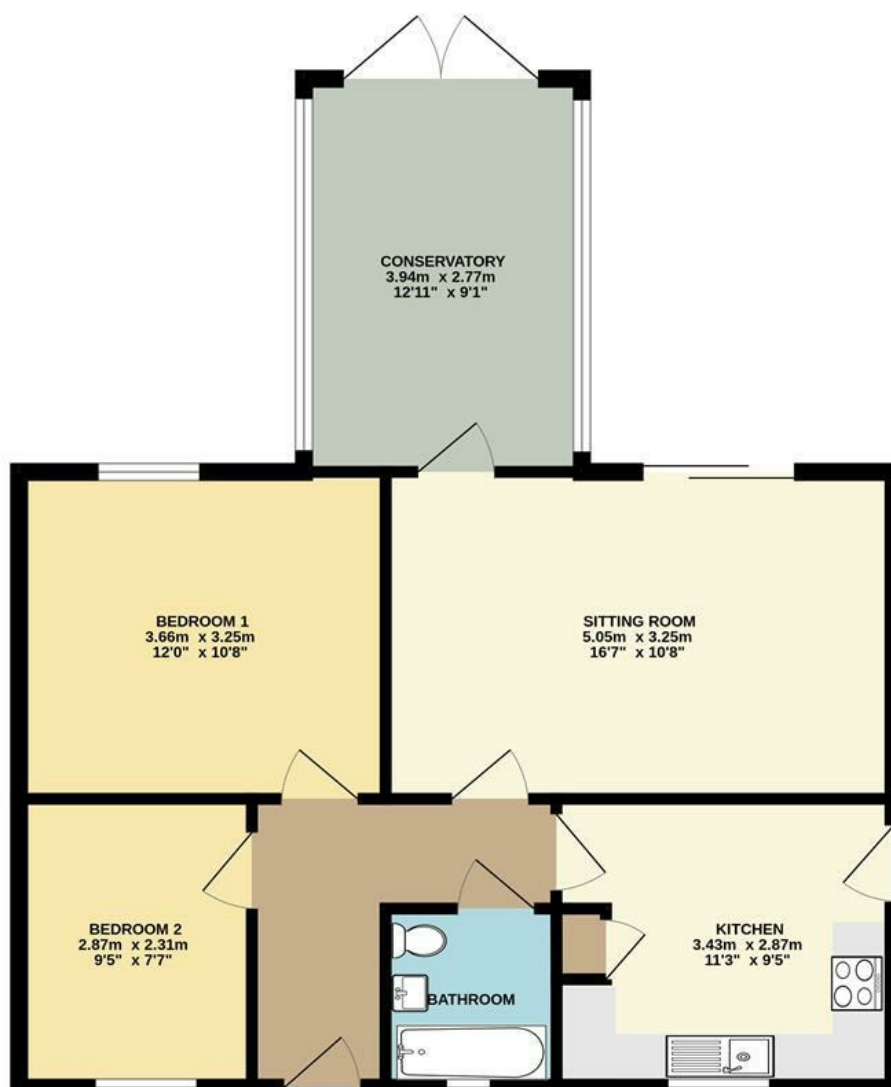

Orchard Close | Norwich | NR11  
 Guide Price £290,000

abbotFox

GROUND FLOOR  
 64.4 sq.m. (693 sq.ft.) approx.



TOTAL FLOOR AREA : 64.4 sq.m. (693 sq.ft.) approx.  
 Whilst every attempt has been made to ensure the accuracy of the floorplan contained here, measurements of doors, windows, rooms and any other items are approximate and no responsibility is taken for any error, omission or mis-statement. This plan is for illustrative purposes only and should be used as such by any prospective purchaser. The services, systems and appliances shown have not been tested and no guarantee as to their operability or efficiency can be given.  
 Made with Metropix ©2024

Energy Efficiency Rating		Current	Potential
Very energy efficient - lower running costs			
(92 plus) A			85
(81-91) B			
(69-80) C			
(55-68) D		64	
(39-54) E			
(21-38) F			
(1-20) G			
Not energy efficient - higher running costs			
<b>England &amp; Wales</b>			EU Directive 2002/91/EC

Disclaimer – In accordance with the Property Misdescriptions Act, the company gives notice that all descriptions, references to condition, necessary permissions for use and other details are given in good faith and believed to be correct, but any intending lessees do not rely on them as statements of fact, but must satisfy themselves by inspection or other means, as to their accuracy.



abbotFox presents this deceptively spacious, two bedroom detached bungalow. Nestled in a quiet residential close, within the sought after coastal village of Mundesley, this home represents an ideal opportunity for any buyer looking to enjoy life on one level.

The internal accommodation is neatly arranged to offer an inviting entrance hall, lounge diner, kitchen breakfast room, conservatory, two bedrooms and a family bathroom. Externally, the property offers a driveway for two vehicles, and a garage, with a secluded, mature rear garden that affords a high degree of privacy.

Guide price £290,000 - £325,000

