

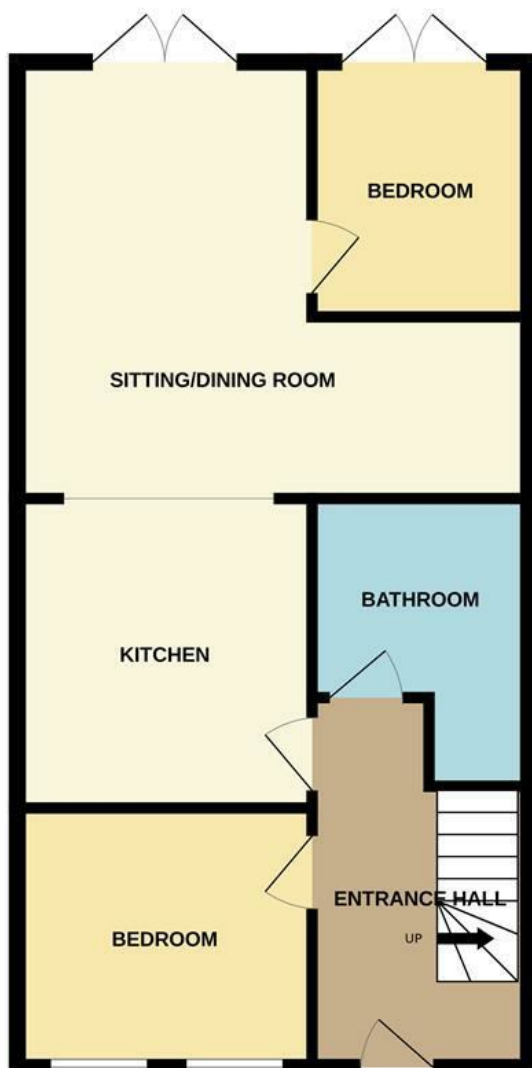

Old Watton Road | Norwich | NR4
£2,700

GROUND FLOOR
56.1 sq.m. (604 sq.ft.) approx.



1ST FLOOR
31.8 sq.m. (342 sq.ft.) approx.

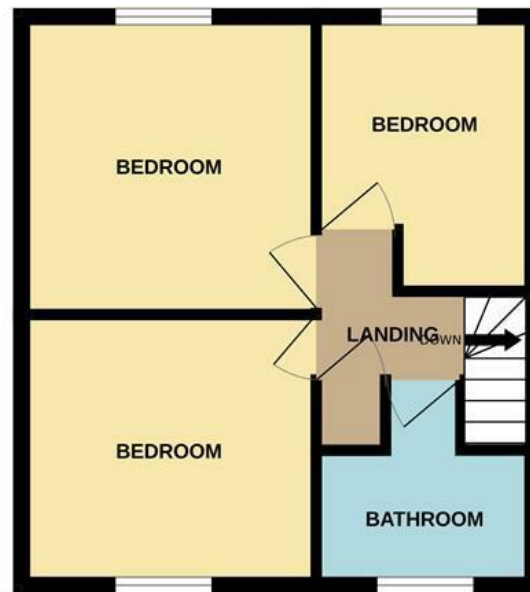

TOTAL FLOOR AREA : 87.9 sq.m. (946 sq.ft.) approx.

Whilst every attempt has been made to ensure the accuracy of the floorplan contained here, measurements of doors, windows, rooms and any other items are approximate and no responsibility is taken for any error, omission or mis-statement. This plan is for illustrative purposes only and should be used as such by any prospective purchaser. The services, systems and appliances shown have not been tested and no guarantee as to their operability or efficiency can be given.
Made with Metropix ©2024

Energy Efficiency Rating		Current	Potential
Very energy efficient - lower running costs			
(92 plus) A			
(81-91) B			
(69-80) C			
(55-68) D			
(39-54) E			
(21-38) F			
(1-20) G			
Not energy efficient - higher running costs			
England & Wales		EU Directive 2002/91/EC	

Disclaimer – In accordance with the Property Misdescriptions Act, the company gives notice that all descriptions, references to condition, necessary permissions for use and other details are given in good faith and believed to be correct, but any intending lessees do not rely on them as statements of fact, but must satisfy themselves by inspection or other means, as to their accuracy.

abbotFox presents this exquisite 5-bedroom detached house, a beacon of modern elegance nestled in the heart of Norwich, NR4. Boasting a contemporary design and meticulous attention to detail, this property is undergoing a comprehensive renovation to elevate your living experience to new heights.

Upon entry, you'll be captivated by the seamlessly crafted interiors and modern fixtures adorning every corner. The living spaces exude a sense of refined luxury, with a chic ambiance that sets the stage for sophisticated living. Spread across a spacious floor plan, the five generously sized bedrooms offer ample accommodation for residents, promising comfort and privacy.

Tailored for student living, this residence comes fully furnished, ensuring convenience and comfort at every turn. Each bedroom is thoughtfully appointed with cozy beds, practical study desks, and abundant storage solutions, fostering an ideal environment for academic pursuits. The communal areas are equally impressive, featuring an open-plan living room and kitchen designed for both relaxation and social gatherings. Equipped with contemporary appliances, including an oven, hob, and fridge-freezer, this space seamlessly blends style with functionality, perfect for hosting guests or unwinding after a busy day.

Positioned in a coveted locale, this property affords easy access to a plethora of local amenities, from shops and eateries to recreational facilities. Its prime location ensures effortless connectivity, with excellent transport links facilitating swift commutes to the University of East Anglia and the vibrant city centre.

