

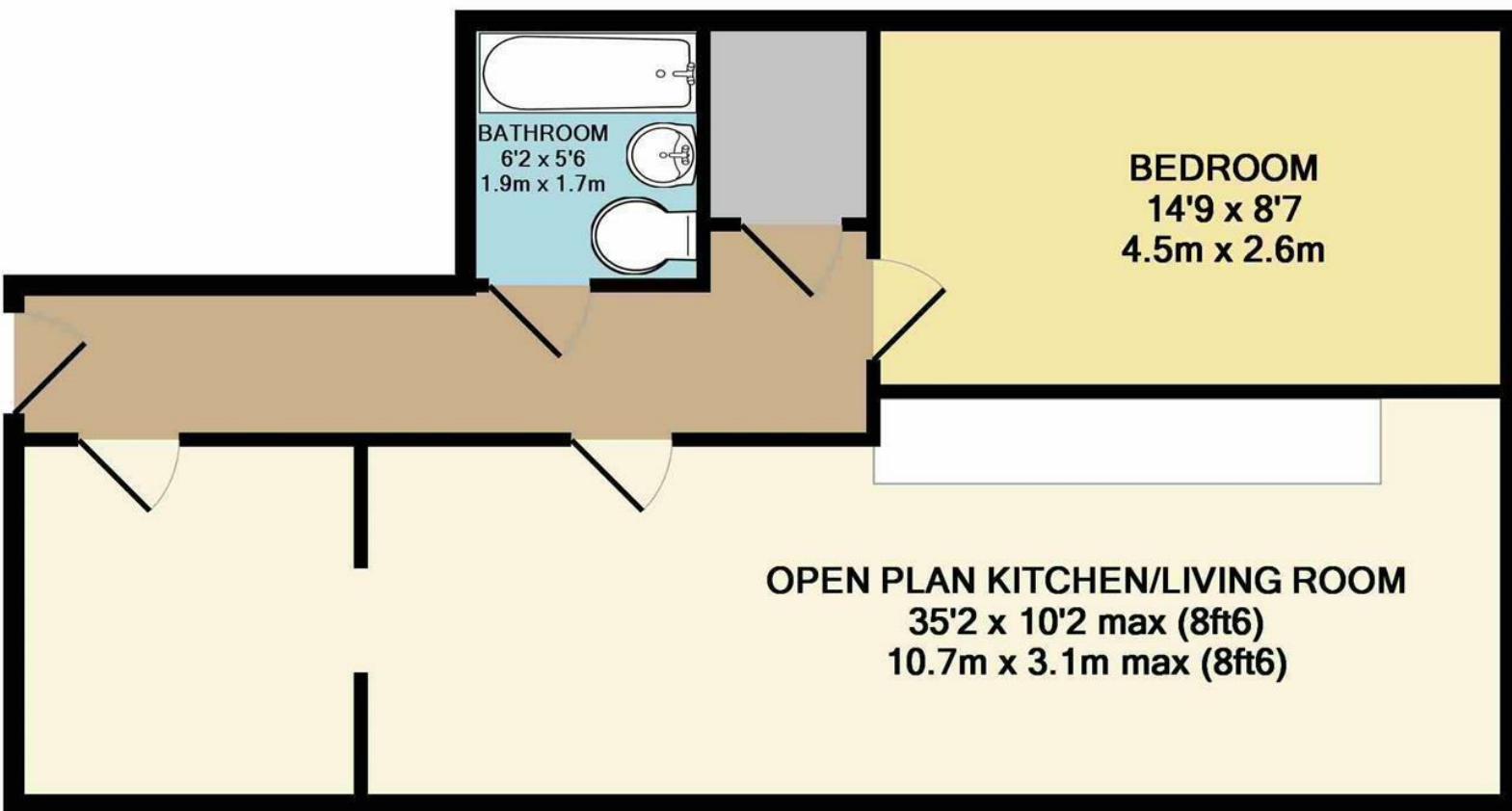

Ber Street | Norwich | NR1  
 Guide Price £140,000

abbotFox



Energy Efficiency Rating		
	Current	Potential
Very energy efficient - lower running costs		
(92 plus) <b>A</b>		
(81-91) <b>B</b>		
(69-80) <b>C</b>	69	69
(55-68) <b>D</b>		
(39-54) <b>E</b>		
(21-38) <b>F</b>		
(1-20) <b>G</b>		
Not energy efficient - higher running costs		
<b>England &amp; Wales</b>	EU Directive 2002/91/EC	

Disclaimer – In accordance with the Property Misdescriptions Act, the company gives notice that all descriptions, references to condition, necessary permissions for use and other details are given in good faith and believed to be correct, but any intending lessees do not rely on them as statements of fact, but must satisfy themselves by inspection or other means, as to their accuracy.

TOTAL APPROX. FLOOR AREA 564 SQ.FT. (52.4 SQ.M.)

Whilst every attempt has been made to ensure the accuracy of the floor plan contained here, measurements of doors, windows, rooms and any other items are approximate and no responsibility is taken for any error, omission, or mis-statement. This plan is for illustrative purposes only and should be used as such by any prospective purchaser. The services, systems and appliances shown have not been tested and no guarantee as to their operability or efficiency can be given

Made with Metropix ©2017



abbotFox presents this generous one bedroom apartment. Ideal for a professional couple, this property is located within the popular Skipper House development and is ideally situated within Norwich City Centre. Finished to an exceptional standard, and having been well maintained by the current owner, this apartment offers a generous double bedroom, stylish modern bathroom, open plan living area and additional office / study space. An internal viewing comes highly recommended.

Guide price - £140,000 - £150,000

