

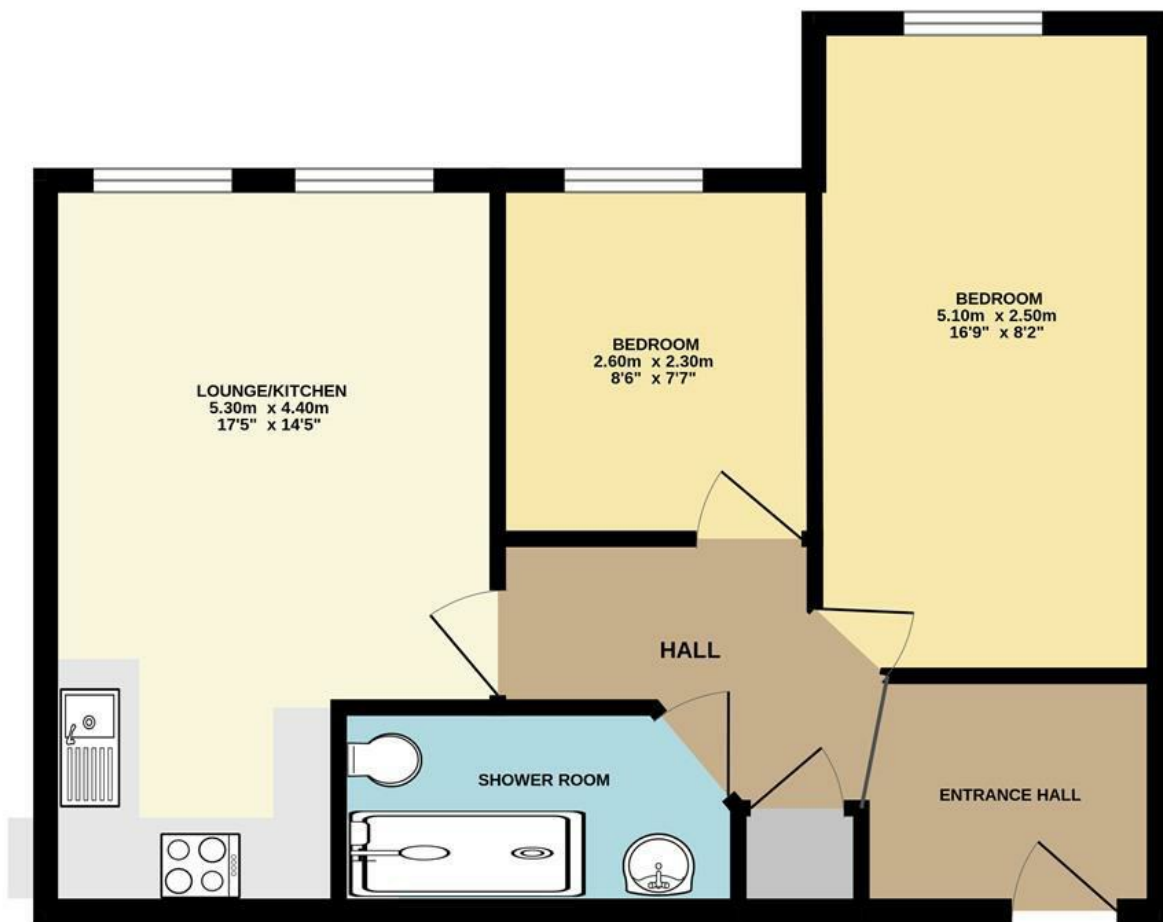

Cordwainer Close | Norwich | NR7
 Guide Price £160,000

abbotFox

GROUND FLOOR



Energy Efficiency Rating		
	Current	Potential
Very energy efficient - lower running costs		
(92 plus) A		
(81-91) B		
(69-80) C		
(55-68) D		
(39-54) E		
(21-38) F		
(1-20) G		
Not energy efficient - higher running costs		
England & Wales		EU Directive 2002/91/EC

Disclaimer – In accordance with the Property Misdescriptions Act, the company gives notice that all descriptions, references to condition, necessary permissions for use and other details are given in good faith and believed to be correct, but any intending lessees do not rely on them as statements of fact, but must satisfy themselves by inspection or other means, as to their accuracy.

Whilst every attempt has been made to ensure the accuracy of the floorplan contained here, measurements of doors, windows, rooms and any other items are approximate and no responsibility is taken for any error, omission or mis-statement. This plan is for illustrative purposes only and should be used as such by any prospective purchaser. The services, systems and appliances shown have not been tested and no guarantee as to their operability or efficiency can be given.
 Made with Metropix ©2023



abbotFox presents this spacious top floor apartment. Overlooking greenery, this home has been well maintained and thoughtfully improved by the current owners, to provide a bright and stylish home, ideal for any first time buyer.

Located in the popular residential area of Sprowston, this property allows for easy access to a wealth of local amenities, including schooling for all ages, supermarkets, restaurants and the nearby countryside. The accommodation on offer, is neatly arranged and comprises; an inviting entrance hall, open plan living area, that opens onto a kitchen, with integrated appliances, two bedrooms and a stylish, re-fitted shower room. This property also benefits from two allocated parking spaces.

Guide price - £160,000 - £180,000

