

abbotFox





Paper Mill Yard, Norwich  
*Guide Price £250,000*

“

We are a team of genuine individuals who hold a deep passion for both property and marketing. Collectively, we bring over 70 years of experience in the property market of Norfolk and Suffolk. Our affection for both counties runs deep, and we are enthusiastic about sharing our passion with you.

Colin McKenzie | **Branch Partner**

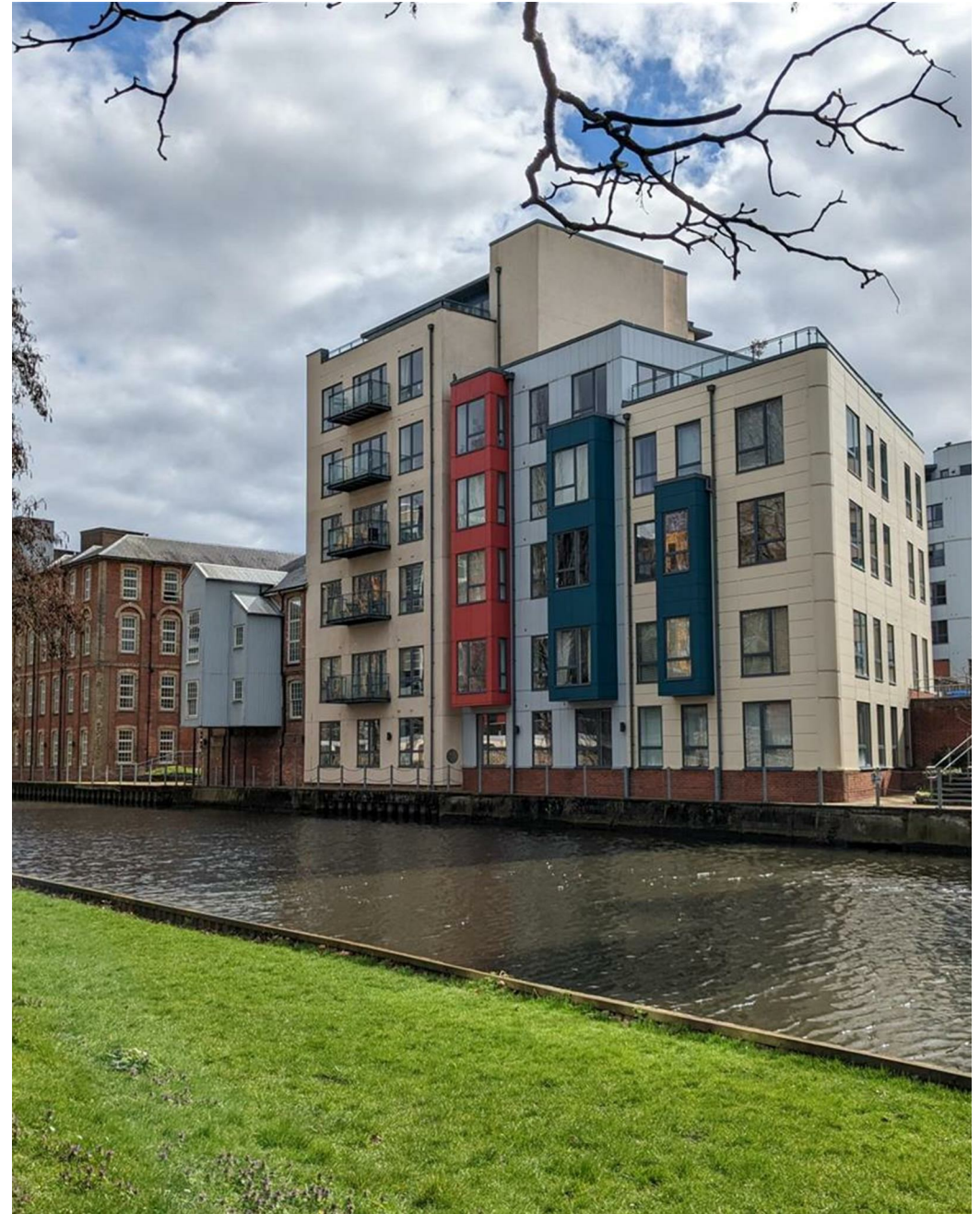









## THE DETAIL\_\_\_\_\_

abbotFox present this generously proportioned City Centre apartment being offered with no onward chain. Accommodation features a generous master bedroom (with en-suite), guest bedroom, open plan lounge/dining room/modern kitchen leading onto a balcony over looking River Wensum and bathroom. Benefiting from allocated parking, lift access and a convenient position close to the train station and A47 bypass.

Guide price - £250,000 - £275,000









## THE HIGHLIGHTS\_\_\_\_

- No onward chain
- River views
- Two double bedrooms
- Two bathrooms
- Allocated parking
- Open plan living
- Balcony

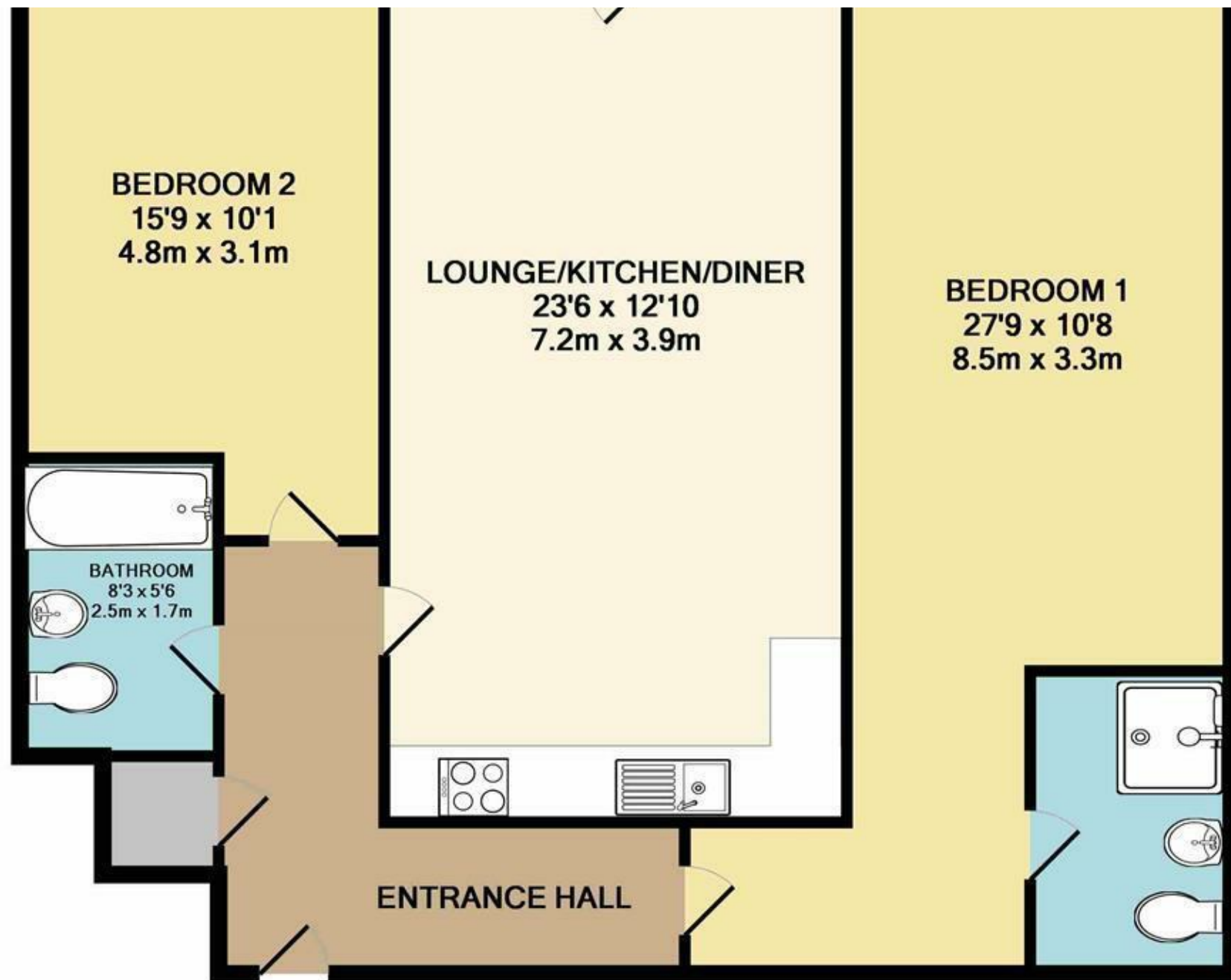

*Let's talk*

01603 660000

[sales@abbotfox.co.uk](mailto:sales@abbotfox.co.uk)

@abbotfox

EPC RATING - B

Disclaimer – In accordance with the Property Misdescriptions Act, the company abbotFox gives notice that all descriptions, references to condition, necessary permissions for use and other details are given in good faith and believed to be correct, but any purchaser should not rely on them as statements of fact, and must satisfy themselves by inspection or other means, as to their accuracy.