



Inglebys

Estate Agents



8 Exeter Street

Saltburn-By-The-Sea, TS12 1BN

£1,300 Per Calendar Month



A rare opportunity to acquire a charming and deceptively spacious 3-bedroom mid-terraced period property nestled in a picturesque tree-lined street in the increasing popular Victorian seaside Spa Town of Saltburn by the Sea.



Tenure: Freehold.

Council Tax: Redcar & Cleveland Borough Council. Band-C.

EPC Rating: D-Rating.

Rental Enquiries

Interested in this property? The fastest way to secure a viewing is to enquire online via the website that you have seen the property listed. Simply register your details, submit your online enquiry and we will respond as soon as possible with the next steps required to schedule a viewing.

Tenancy Deposit & Upfront Payments: 1x Month's Rent and a Security Deposit equivalent to 5 Weeks' Rent are both required upfront in order to move into the property.

Entrance Vestibule

Double glazed door to the front aspect, tiled floor.

Entrance Hall

Wooden door, with stained glass top panel, stained glass side panel with additional windows above adding natural light. Stairs to First Floor, dado rail, coving and ceiling cornice, radiator.

Living Room 13'10" x 12'9" (4.23m x 3.9m)

Large uPVC double glazed bay window to the front aspect, with wood panel surround, open fire with tiled hearth and insert, wooden surround, picture rail, coving, radiator, coving.

Dining Room 12'8" x 11'6" (3.88m x 3.51m)

uPVC window to the rear aspect, feature fire place in tiled surround, picture rail, radiator

Kitchen 18'11" x 11'6" (5.78m x 3.51m)

Range of fitted wall base and drawer units, wooden worktops with matching upstands, incorporation composite sink and a half with drainer and mixer tap. Eye level double electric oven, and 5 ring electric hob, extractor hood, under floor heating, 2 x uPVC windows to the side aspect, French doors leading to the enclosed rear court yard

Cloak Room 8'2" x 4'0" (2.5m x 1.24m)

uPVC window to the side aspect, low-level W/C, wash hand basin in vanity unit, storage cupboard housing combi boiler

First Floor

Landing area with sky light and loft hatch leading to boarded loft

Bedroom One 17'3" x 13'8" (5.26m x 4.19m)

uPVC bay window, and separate second window to the front aspect, fire place, fitted wardrobes, radiator

Bedroom Two 12'8" x 11'7" (3.88m x 3.54m)

uPVC window to the rear aspect, fireplace, picture rail, radiator

Bedroom Three 10'8" x (3.27m x)

uPVC window to the rear aspect, picture rail, radiator

Family Bathroom 8'6" x 5'0" (2.61m x 1.53m)

Fully Tiled, white panel bath with shower over, glazed screen, low-level W.C, pedestal wash hand basin, towel rail, uPVC window

W/C

uPVC window to the side, high level W/C

Externally

Front

Low maintenance front courtyard with paving and stone, wooden fence

Rear

Enclosed rear yard with wooden decking, log store, and workshop/outhouse, access to the rear alley

Disclaimer

Please note that all measurements contained in these particulars are for guidance purposes only and should not be relied upon for ordering carpets, furniture, etc. Anyone requiring more accurate measurements may do so by arrangement with our office.

Our description of any appliances and / or services (including any central heating system, alarm systems, etc.) should not be taken as any guarantee that these are in working order. The buyer is therefore advised to obtain verification from their solicitor, surveyor or other qualified persons to check the appliances / services before entering into any commitment.

The tenure details and information supplied within the marketing descriptions above are supplied to us by the vendors. This information should not be relied upon for legal purposes and should be verified by a competent / qualified person prior to entering into any commitment.

Area Map



Floor Plans

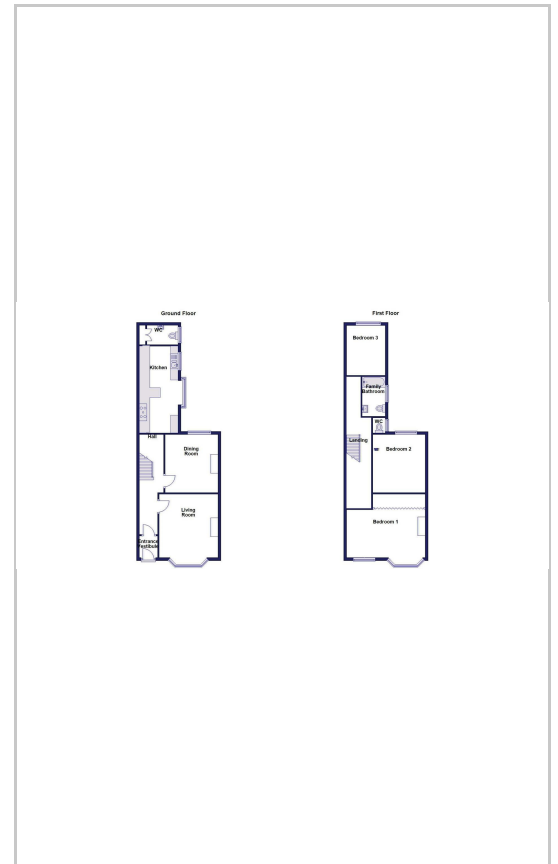

Energy Efficiency Graph

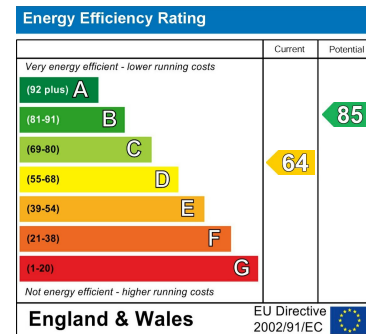

These particulars, whilst believed to be accurate are set out as a general outline only for guidance and do not constitute any part of an offer or contract. Intending purchasers should not rely on them as statements of representation of fact, but must satisfy themselves by inspection or otherwise as to their accuracy. No person in this firm's employment has the authority to make or give any representation or warranty in respect of the property.

Inglebys Estate Agents 4a Station Street, Saltburn by the Sea, North Yorkshire, TS12 1AE
Tel: 01287 623648 Email: enquiries@inglebysestateagents.com www.inglebysestateagents.com