

HJC

HIGHER VALUES



Camm Gardens

Thames Ditton, KT7 0JA

Guide Price

£1,500,000

Contemporary and versatile family home, with proximity to the open spaces of Weston Green and the River Thames, and the practicality of easy access to the Waterloo train and high street. A generous house, thoughtfully extended over two decades of ownership, and approaching 2700ft² over only two floors. The main living room stretches almost 30ft from front to back and opens into an excellent fitted kitchen. Along with a further living room and study, is a range of helpful spaces, including large porch, cloakroom, part-garage opening to front and a utility room with guest WC. Each of the first floor bedrooms has good built-in wardrobe storage and will accommodate a double bed; the primary bedroom benefits from its own ensuite, two beds share a Jack and Jill ensuite shower room and the remaining three share the family bathroom. They are all arranged around a wide landing, which has a wall of useful storage. Rear garden, with dedicated patio area for al-fresco dining/entertaining and characterful old brick wall, accessed via bi-folding doors from the main living room. Off-street parking to the front for three cars.

- Detached modern family home
- Carriage driveway parking
- Lateral family living
- Cleverly extended
- Approx 50ft rear garden
- 6 beds with 3 bath/showers
- Contemporary presentation
- Quiet cul de sac location

Floor Plan

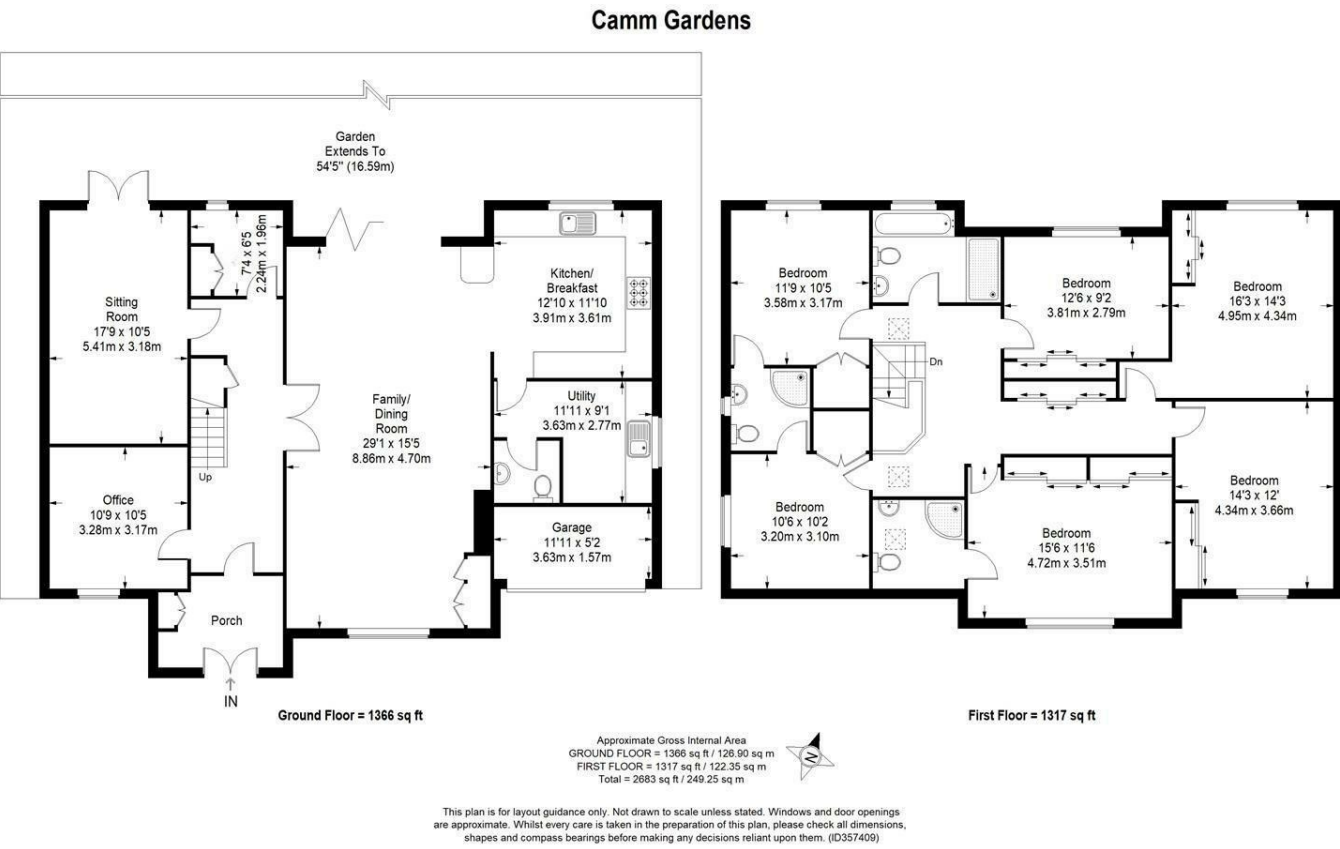

Energy Efficiency Graph

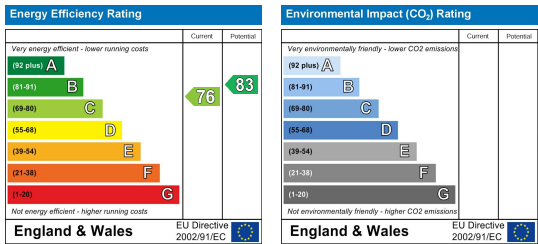

These particulars, whilst believed to be accurate are set out as a general outline only for guidance and do not constitute any part of an offer or contract. Intending purchasers should not rely on them as statements of representation of fact, but must satisfy themselves by inspection or otherwise as to their accuracy. No person in this firms employment has the authority to make or give any representation or warranty in respect of the property.