

# HJC

HIGHER VALUES



## Weston Green Road

Thames Ditton, KT7 0LA

£199,950

CHAIN FREE. A spacious and light, larger-than-average, studio flat, in this highly regarded gated development of apartments, close to Weston Green, with Thames Ditton and Esher stations nearby. This top floor property features a versatile living area with windows overlooking grounds, a high spec fitted kitchen with integrated appliances, modern white bathroom and a large storage/cloak cupboard. Further benefits beautiful communal gardens to rear, share of bike store, lift to all floors and parking. Service charge: £2,414pa (inclusive of gas and water) / Ground rent: £150.00pa

Material Info: Brick Walls & Roof Tiles. Water / Electricity / Sewerage: Mains. Heating: Communal. Mobile Coverage: Indoor: Likely Outdoor: Likely. No internet connection currently, but is available at this location.

- Light and spacious studio flat
- White bathroom
- Beautiful communal gardens
- Gated development
- Near shops and amenities
- Modern fitted kitchen
- Storage cupboard
- Parking
- Esher and Thames Ditton train stations nearby
- Share of bike storage

## The Newlands KT7

Approximate Gross Internal Floor Area = 31.6 sq m / 341 sq ft

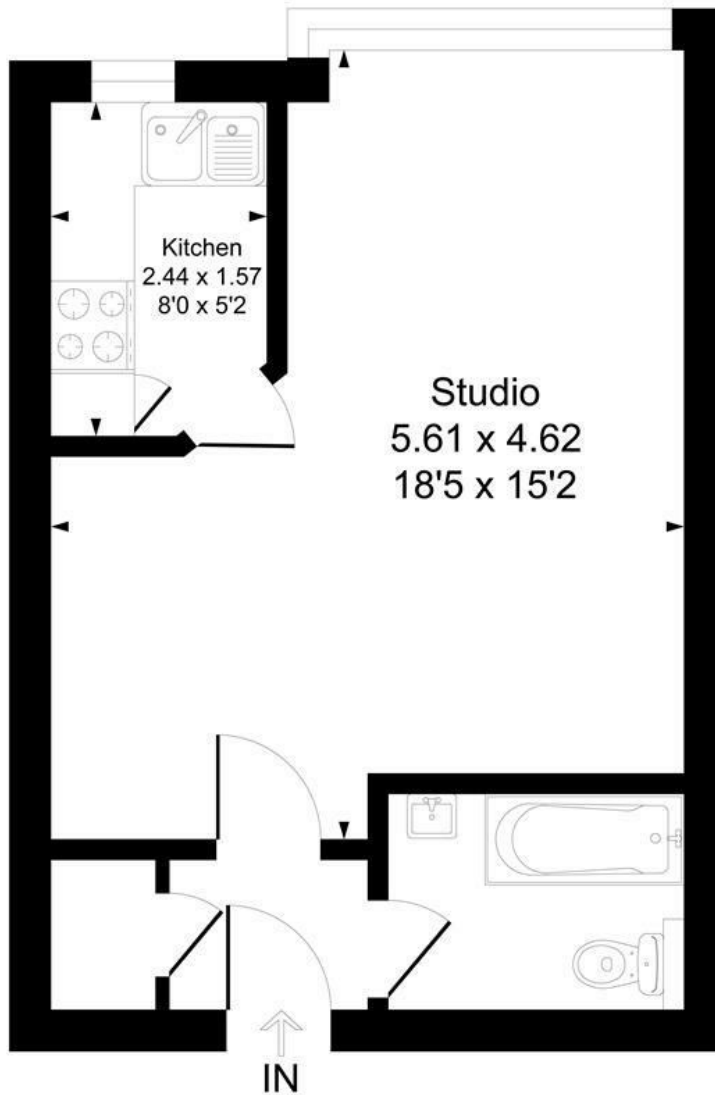

## Top Floor

Illustration for identification purposes only, measurements are approximate, not to scale.  
Produced By Esjay Property Marketing

## Energy Efficiency Graph

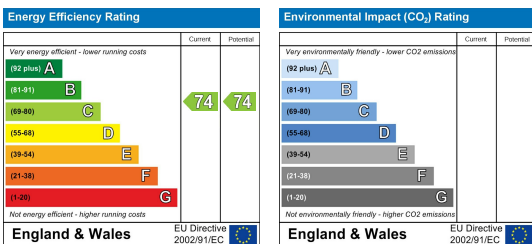

These particulars, whilst believed to be accurate are set out as a general outline only for guidance and do not constitute any part of an offer or contract. Intending purchasers should not rely on them as statements of representation of fact, but must satisfy themselves by inspection or otherwise as to their accuracy. No person in this firm's employment has the authority to make or give any representation or warranty in respect of the property.