

the floorplan...

GROUND FLOOR
482 sq.ft. (44.8 sq.m.) approx.

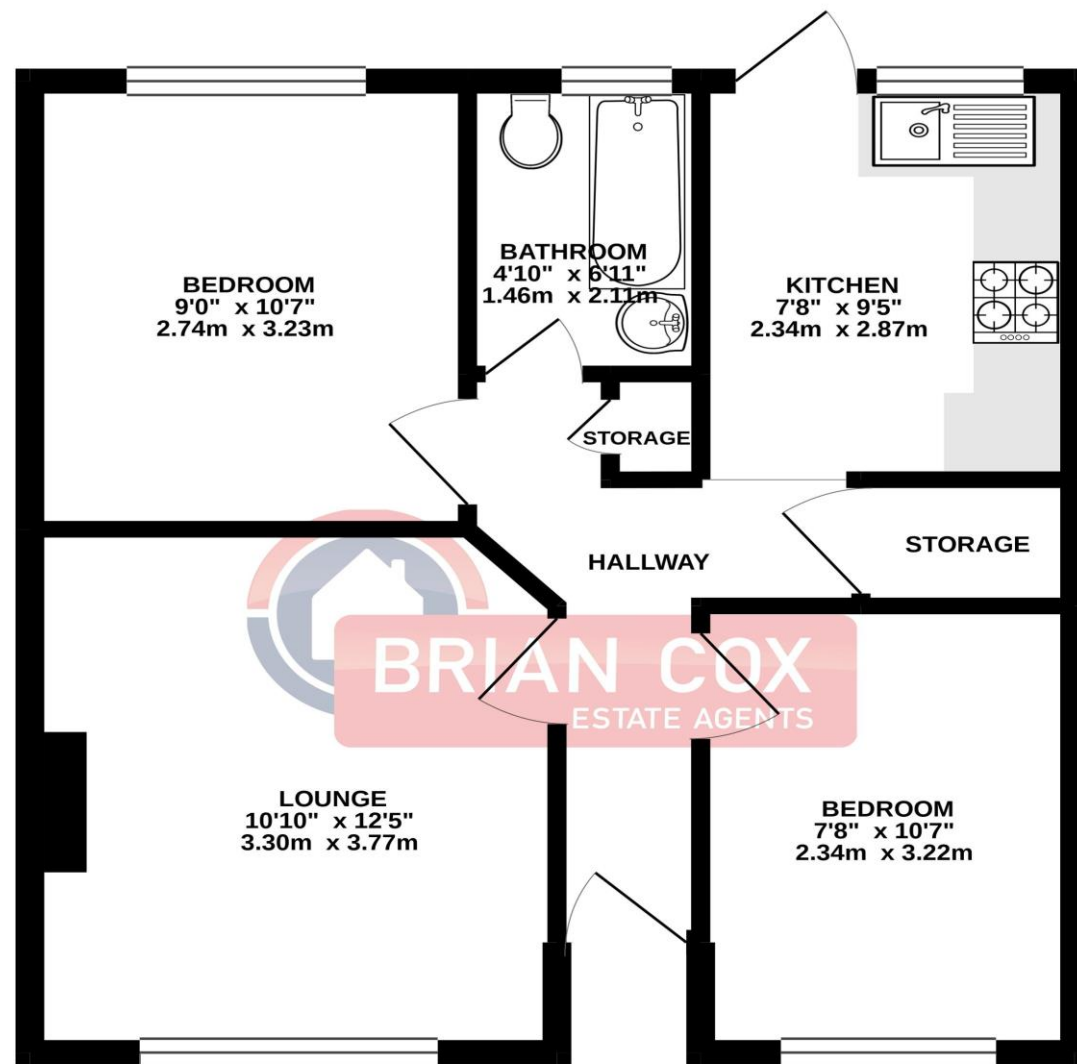

TOTAL FLOOR AREA : 482 sq.ft. (44.8 sq.m.) approx.

Whilst every attempt has been made to ensure the accuracy of the floorplan contained here, measurements of doors, windows, rooms and any other items are approximate and no responsibility is taken for any error, omission or mis-statement. This plan is for illustrative purposes only and should be used as such by any prospective purchaser. The services, systems and appliances shown have not been tested and no guarantee as to their operability or efficiency can be given.
Made with Metropix ©2021

more details from...

call: **Brian Cox North Greenford: 0208 578 1004**

email: daniel.jed@brian-cox.co.uk

web: www.brian-cox.co.uk



0208 578 1004
brian-cox.co.uk



TWO BEDROOM - GROUND FLOOR - PURPOSE BUILT MAISONETTE - LONG LEASE - NO CHAIN. Brian Cox and Company are delighted to bring to the market this recently refurbished two bedroom ground floor maisonette located in the heart of Greenford. The property briefly comprises two bedrooms, a lounge, modern bathroom and a fitted kitchen. Further benefits include double glazing, gas central heating and a private rear garden. Viewings are highly recommended, so call now to arrange yours!!



£349,950

Leasehold

Beechwood Avenue, Greenford UB6 9UA



in brief...

- Two Bedroom
- Ground Floor Maisonette
- Long Lease
- Front and Rear Gardens
- Recently Refurbished
- No Chain

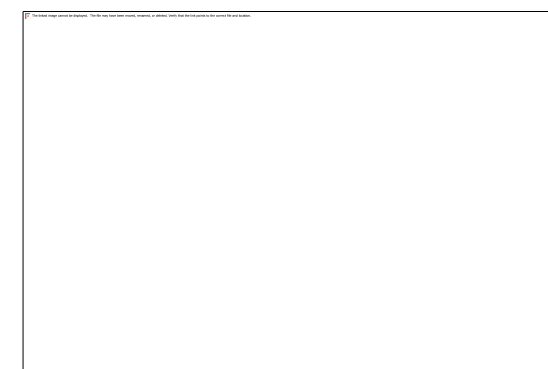

the location...

nearest stations ...

Greenford (1.1 miles)
South Greenford (1.2 miles)
Northolt (1.2 miles)

Greenford is a large suburb in the London Borough of Ealing in West London, UK. It was an ancient parish in the historic county of Middlesex. It is 11 miles (18 km) from Charing Cross in Central London.

Within a 10 minute walk you will be situated on Greenford's Broadway which offers ample shops, schools and bus links to numerous locations. Also within easy reach is Ravenor Park offering outdoor space for walking and leisure activities.

If you commute in or out of London then you will be pleased to know that within a short 15-20 minute walk you will be at Greenford's Central Line Tube or if you drive then just a couple of minutes down the road is the A40 which offers an excellent link to the city or the Home Counties

There are several local schools in the area which include Ravenor Primary School, Stanhope Primary School, Coston Primary School and Edward Betham Church of England Primary School.

If you have older children there are many local secondary schools in the area which include Greenford High School, The Cardinal Wiseman Catholic School and William Perkin Church of England High School.