



## Stockey Bridge Brook Lane, Charlton

Guide Price **£450,000**





## Stockey Bridge Brook Lane

Charlton, Pershore

Council Tax band: E

Tenure: Freehold

EPC Energy Efficiency Rating: D

EPC Environmental Impact Rating: D

- WELL MAINTAINED WITH IMPROVEMENTS
- LIGHT AND AIRY ACOMMODATION
- SEMI RURAL LOCATION
- OPEN LOUNGE
- KITCHEN / BREAKFAST ROOM WITH SEPERATE DINING ROOM
- UTILITY WITH SIDE ACCESS TO THE REAR & FRONT
- FOUR BEDROOMS - THREE BEING DOUBLES
- FAMILY BATHROOM, EN-SUITE AND WC
- BEAUTIFUL OUTLOOK OF CHARLTON
- VIEWING HIGHLY ADVISED!





















## Ground Floor

Approx. 67.5 sq. metres (726.9 sq. feet)

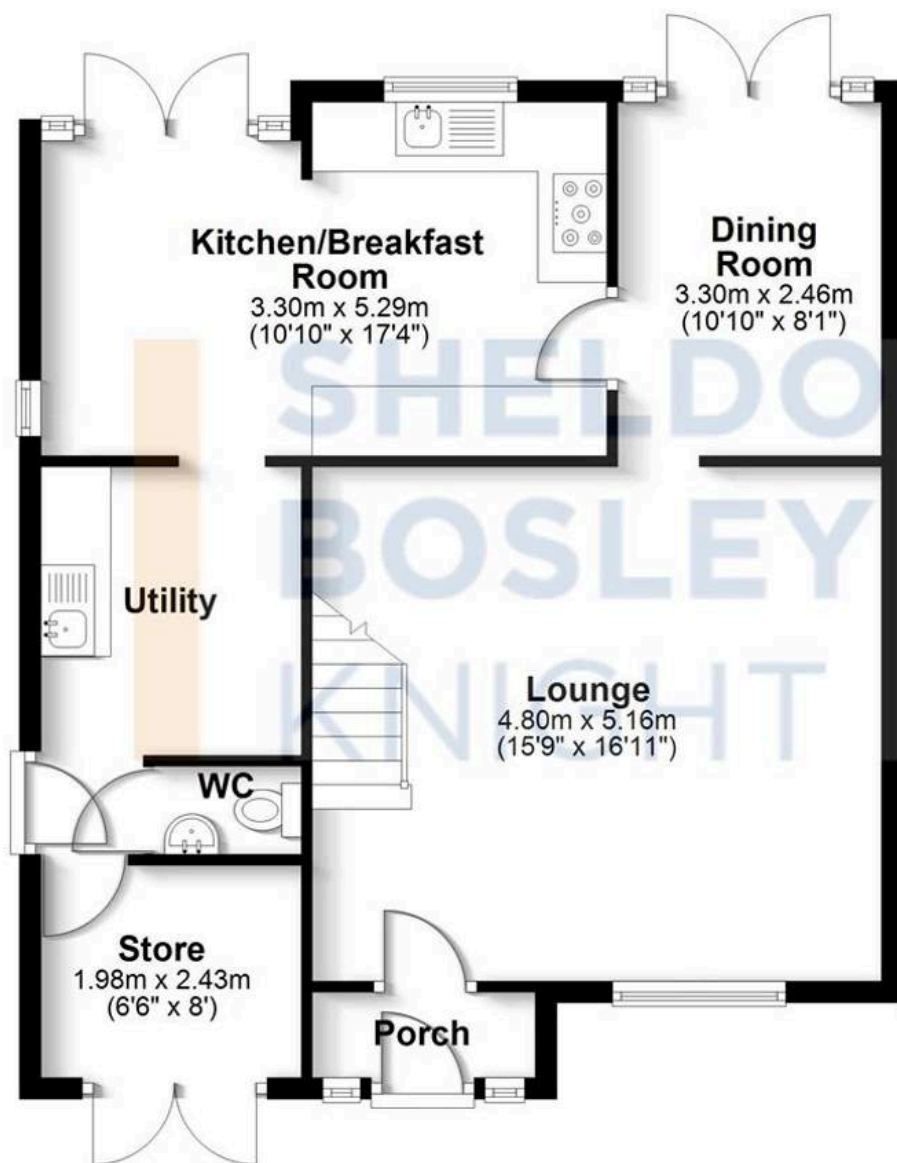

## First Floor

Approx. 60.5 sq. metres (651.1 sq. feet)

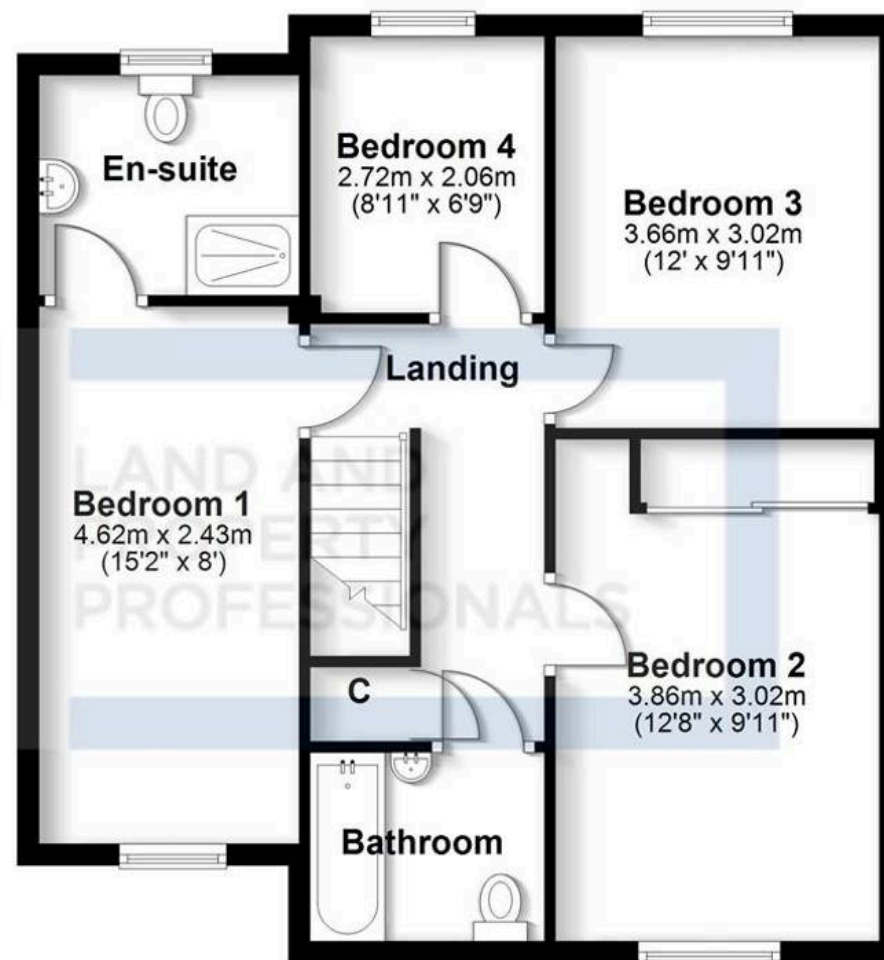

Total area: approx. 128.0 sq. metres (1378.1 sq. feet)

All efforts have been made to ensure the measurements are accurate on this floor plan, however these are for guidance purposes only.  
Plan produced using PlanUp.





## Sheldon Bosley Knight Evesham & Pershore

Sheldon Bosley Knight, 1 Bridge Street, Evesham - WR11 4SQ

01386444900 • [eveshamsales@sheldonbosleyknight.co.uk](mailto:eveshamsales@sheldonbosleyknight.co.uk) • [www.sheldonbosleyknight.co.uk/](http://www.sheldonbosleyknight.co.uk/)

### DISCLAIMER

All fixtures and fittings mentioned in these particulars are included in the sale, all others in the property are specifically excluded.

Photographs are reproduced for general information and it must not be inferred that any item is included for sale with the property.

These particulars are thought to be materially correct. Their accuracy is not guaranteed and they do not form part of any contract.