



Malinshill Road, Hampton, WR11 2QG

**SHELDON
BOSLEY
KNIGHT**

LAND AND
PROPERTY
PROFESSIONALS

Property Description

FOUR BEDROOM DETACHED HOME IN A QUIET, POPULAR AREA OF HAMPTON - CHAIN FREE*

A wonderful opportunity to purchase this beautifully presented home offered to the market with no onward chain. The property boasts a private position and has been much improved by the current owner.

The property comprises; entrance hall, shower room, spacious, open plan living room / sitting area boasting superb natural lighting, dining room, newly fitted kitchen and utility.

The first floor comprises; spacious landing area leading to FOUR well proportioned bedrooms, large airing cupboard and family bathroom. There is opportunity to utilise a bedroom as an ideal working from home space. There is also a spacious, fully boarded attic with insulation, light and pull down ladder.

The property benefits from a private, mature garden with patio area, new fencing and greenhouse with access to store and a door to the generous sized garage. The front of the property enjoys parking for multiple cars, an array of shrubs and greenery and overlooks two characterful thatched cottages with far reaching views of Bredon Hill.





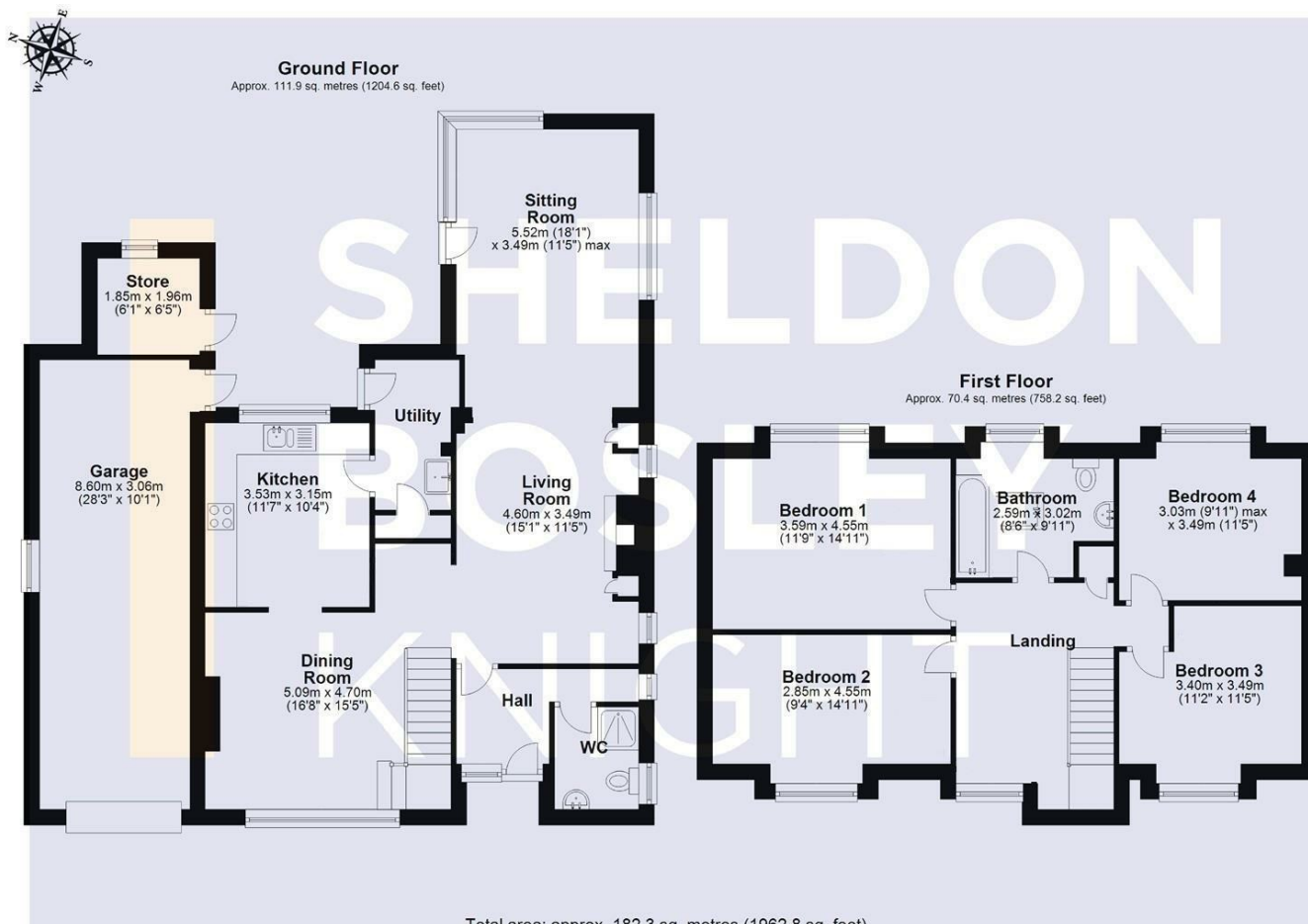

DISCLAIMER - Floor plans shown are for general guidance only. Whilst every attempt has been made to ensure that the floorplan measurements are as accurate as possible, they are for illustrative purposes only.

Key Features

- FOUR BEDROOMS
- QUIET, PRIVATE LOCATION
- DESIRABLE AREA IN HAMPTON
- OVER 1900 SQ FT OF ACCOMMODATION
- MODERNISED THROUGHOUT
- EPC RATING - D
- LIGHT AND AIRY THROUGHOUT
- CHAIN FREE

Asking Price
£499,800

EPC Rating - D

Tenure - Freehold

Council Tax Band - F

Local Authority -
Wychavon District Council

We routinely refer clients to both our recommended Legal Firm and a panel of Financial Services Providers. It is your decision whether you choose to deal with these companies. In making that decision, you should know that we receive a referral fee