



Rushley Lane, Cheltenham, GL54 5JE

**SHELDON
BOSLEY
KNIGHT**

LAND AND
PROPERTY
PROFESSIONALS

Property Description

*** AVAILABLE SEPTEMBER *** A incredibly spacious three bedroom character cottage situated in Winchcombe, an ancient Saxon town situated on the famous Cotswold Way about 7 miles north-east of Cheltenham and 16 miles from Gloucester. The accommodation briefly comprises; entrance hall with downstairs WC which leads into the dining room with a feature fireplace and pantry, kitchen with a range of fitted units, living room with fitted wood burner and conservatory which showcases the beautiful gardens to the front of the property. Staircase leads to the first floor with the main double bedrooms which includes an en-suite, two further bedrooms (one single and one double) and a family bathroom. This property is offered Unfurnished. Council Tax Band E. Energy Rating E. Pets Considered. Initial 12 Month Tenancy.





Key Features

- AVAILABLE SEPTEMBER
- Winchcombe
- 3 Bedrooms
- Character Cottage
- Beautiful Gardens
- Unfurnished
- Council Tax Band E
- Energy Rating E
- Initial 12 Month Tenancy
- Pets Considered

PCM
£1,600 PCM

EPC Rating - E

Tenure -

Council Tax Band - E

Local Authority -
Tewkesbury Borough Council

Ground Floor

Approx. 66.9 sq. metres (719.6 sq. feet)

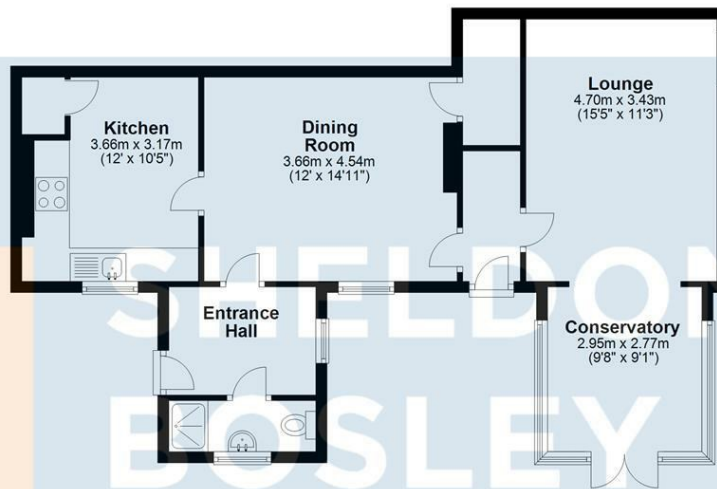

First Floor

Approx. 50.4 sq. metres (542.2 sq. feet)



Total area: approx. 117.2 sq. metres (1261.7 sq. feet)

All efforts have been made to ensure that the measurements on this floorplan are accurate however these are for guidance purposes only.
Plan produced using PlanUp.

We routinely refer clients to both our recommended Legal Firm and a panel of Financial Services Providers. It is your decision whether you choose to deal with these companies. In making that decision, you should know that we receive a referral fee