



Priestfield Road, Redditch, B97 5LR

**SHELDON
BOSLEY
KNIGHT**

LAND AND
PROPERTY
PROFESSIONALS

Property Description

*** AVAILABLE END OF MARCH *** A well presented two bedroom mid terrace house located in the sought after area of Headless Cross. The property briefly comprises of; kitchen with fitted units, cooker and hob, living room with patio door to garden with patio area. Upstairs; one master bedroom with built in wardrobe, one single bedroom with built in wardrobe, and family bathroom with shower-over-bath, basin and WC. This property further benefits from rear garden, gas central heating and an allocated parking space. Council Tax Band B. Energy Rating C. Initial 6 Month Tenancy. Pets Considered.





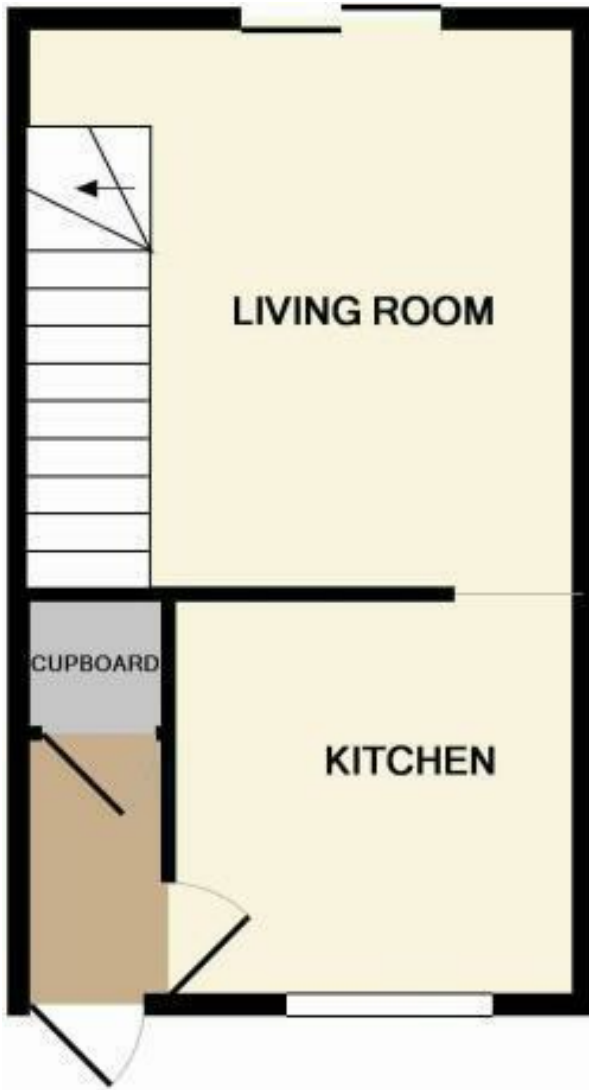

GROUND FLOOR

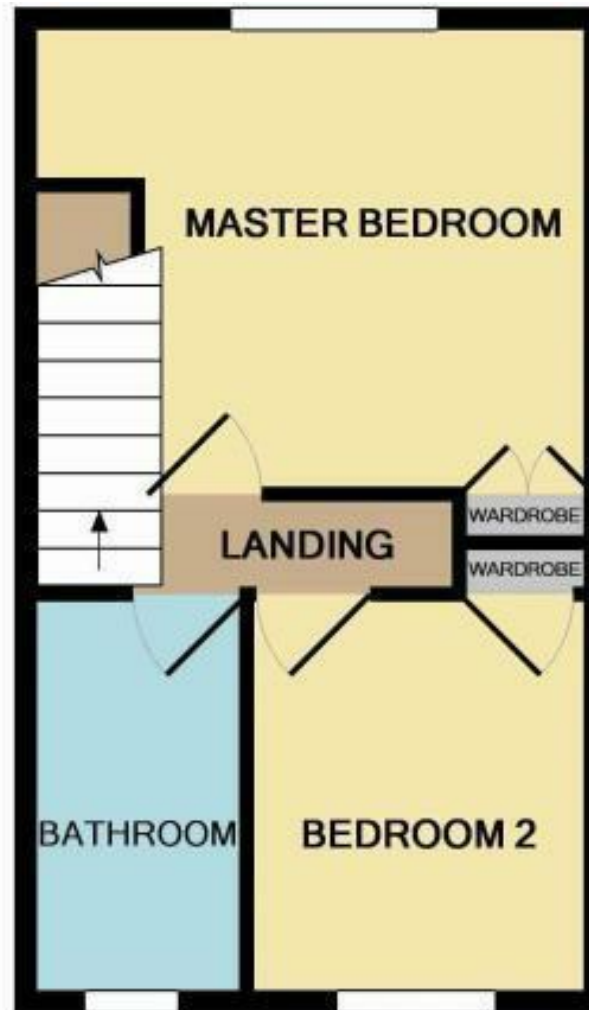

1ST FLOOR

Measurements are approximate. Not to scale. Illustrative purposes only
 Made with Metropix ©2015

Key Features

- AVAILABLE END OF MARCH
- Evesham
- 2 Bedrooms
- Terraced House
- Unfurnished
- Rear Garden, Gas Central Heating and One Allocated Parking Space
- Council Tax Band B
- Energy Rating C
- Initial 6 Month Tenancy
- Pets Considered

£825 PCM