

FLETCHERS

ESTATE AGENTS



Fernhead Road, W9

£400,000

A well presented one bedroom flat with a private garden in Maida Vale. Situated on the ground floor, this excellent property has been well kept by the current owner and comprises of a generous double bedroom with plenty of built in storage, a tasteful bathroom suite, a separate fitted kitchen that is complete with built in appliances, a spacious reception room with large windows allowing for plenty of natural light and access out into a private rear garden. The property is offered to the market with no onward chain.

Fernhead Road is a popular tree lined street positioned exceptionally for Maida Vale and its extensive array of shops, bars and restaurants along with the green spaces of Paddington recreation ground and the renowned canal walks of Little Venice. The amenities of Westbourne Park & Queens Park are within a mile. It is well located for underground links with Westbourne Park Tube station within 0.4 Miles (Circle and Hammersmith and City lines) and Queens Park Station 0.5miles away (Bakerloo Line & Overground) offering excellent access in and out of town.

• Quiet Tree Lined Street • Private Rear Garden • No Onward Chain • Separate Kitchen/Reception • Near Local Amenities • Good Transport Links •

FLETCHERS

ESTATE AGENTS

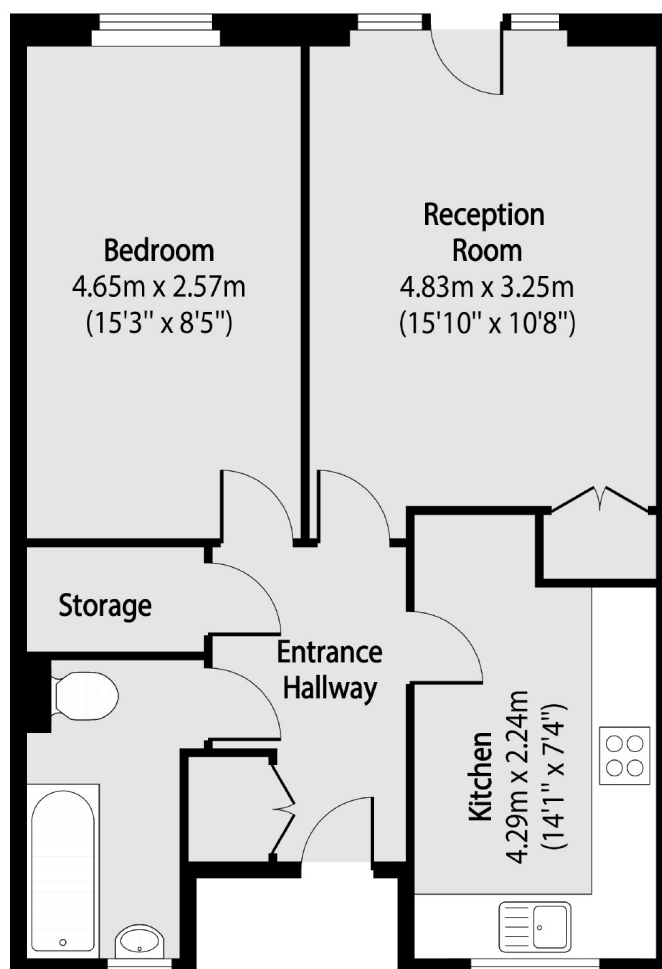

Total area (approx): 49.52 sq m (533 sq. ft)

Fletchers Brook Green Sales
144 Shepherds Bush Road, Hammersmith, London, W6 7PB
020 7603 1415
brookgreensales@fletcherestates.com

Energy Rating: . We aim to make our particulars both accurate and reliable. However they are not guaranteed; nor do they form part of an offer or contract. If you require clarification on any points then please contact us, especially if you're traveling some distance to view. Please note that appliances and heating systems have not been tested and therefore no warranties can be given as to their good working order.