

FLETCHERS

ESTATE AGENTS



Westville Road, W12

£550,000

A bright and spacious garden flat located within an imposing Mansion block in a residential street in Askew Village. Arranged laterally and with high ceilings throughout, the property comprises of two generously sized double bedrooms both benefitting from built-in storage, a separate kitchen that comes complete with fitted appliances, a wonderful & bright, bay-fronted separate reception room and a recently modernised bathroom suite. There is a private garden accessed directly from the kitchen also perfect for outside entertaining in the summer months.

This excellent home has plenty of natural light with external windows in every room and benefitting from multiple aspects and is perfect for a young couple, pied a terre or for a young family looking to live in this popular location. It also benefits from a share of the freehold and the use of a large, well-kept communal garden to the rear in addition to the private outside space that comes with this flat.

Westville Road is a quiet, residential street in Askew Village and positioned well for the green space of Ravenscourt Park. Located just off Askew Road, it is positioned ideally for its array of local shops, bars and restaurants. The award-winning Ginger Pig butchers, The Eagle with its excellent pub garden, the October 26 Bakery and Burnt local favourites, Ravenscourt Park (District line) as well as Goldhawk Road (Hammersmith & City line & Circle line) as well as Shepherds Bush (Central line) are all nearby offering excellent connections into town. The home is also ideally located for the array of shops, restaurants and amenities of Westfield and those surrounding the development at the BBC Television Centre.

• Two Double Bedrooms • Private & Communal Garden • Share of Freehold • Red Brick Mansion Block • Separate Reception/Kitchen • Quiet Residential Street •

FLETCHERS

ESTATE AGENTS

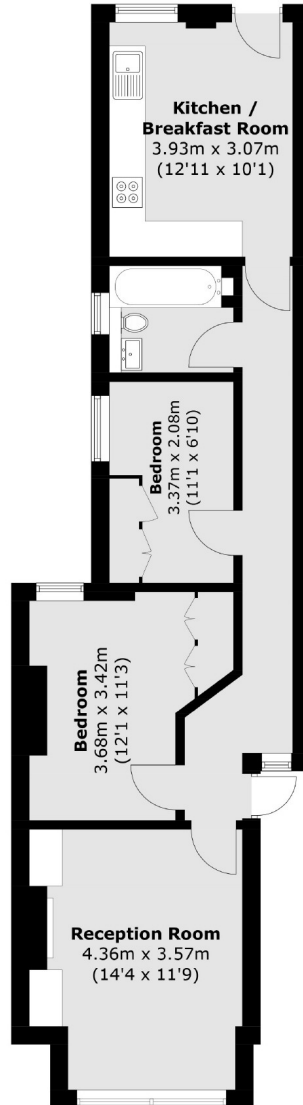

Total area (approx.): 60.5 sq. m (651.2 sq. ft)

Fletchers Brook Green Sales
144 Shepherds Bush Road, Hammersmith, London, W6 7PB
020 7603 1415
brookgreensales@fletcherestates.com

Energy Rating: D. We aim to make our particulars both accurate and reliable. However they are not guaranteed; nor do they form part of an offer or contract. If you require clarification on any points then please contact us, especially if you're traveling some distance to view. Please note that appliances and heating systems have not been tested and therefore no warranties can be given as to their good working order.