

# FLETCHERS

ESTATE AGENTS



## Beadon Road, W6

£950,000

A lovely, two double bedroom, two bathroom luxury apartment within a popular, modern development in the heart of Hammersmith. Situated within the highly sought after sovereign court development, this stylish flat offers elegant and contemporary living with an open plan kitchen/living area complete with high spec appliances and plenty of natural light from large, floor to ceiling windows that open onto a private balcony overlooking the surrounding area in Hammersmith.

The master bedroom benefits from an en suite shower room and built in storage and both rooms have lofty views of the surrounding area. Residents can also enjoy having access to a 24 hour porter service, communal gardens, lift access and a residents only fitness suite, as well as shops and restaurants only several minutes walk away in both Hammersmith & Brook Green.

The property is offered to the market with a long lease and no onward chain.

Marquis House is part of the sought after Sovereign Court development in the heart of Hammersmith which is excellently positioned for the local amenities within Brackenbury village & Hammersmith. Brackenbury Road and Hammersmith Grove have an array of independent restaurants, butchers, pubs and cafes and the more functional larger supermarkets and retail outlets can be found on Kings Street. The house is also within a quarter of a mile of Hammersmith tube station (District, Piccadilly, Hammersmith & City and Circle lines). It is also close by to some exceptional local schools Godolphin and Latimer and West London Free to name a few.

- Two Double Bedrooms • Two Bathrooms • No Onward Chain • 900+ Year Lease • 8th Floor With Lift Access • Private Balcony •

# FLETCHERS

ESTATE AGENTS

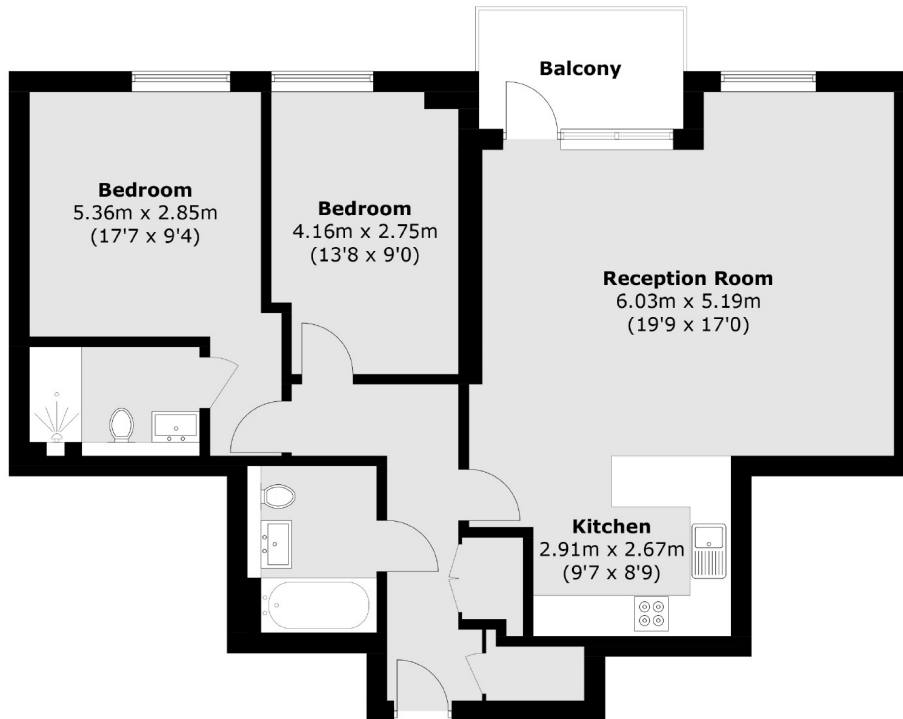

Total area (approx.): 86.6 sq. m (932.2 sq. ft)  
Balcony (approx.): 5.2 sq. m (56.0 sq. ft)

Fletchers Brook Green Lettings  
144 Shepherds Bush Road, Hammersmith, London, W6 7PB  
020 7603 1415  
[brookgreensales@fletcherstates.com](mailto:brookgreensales@fletcherstates.com)

Energy Rating: B. We aim to make our particulars both accurate and reliable. However they are not guaranteed; nor do they form part of an offer or contract. If you require clarification on any points then please contact us, especially if you're traveling some distance to view. Please note that appliances and heating systems have not been tested and therefore no warranties can be given as to their good working order.