

FLETCHERS

ESTATE AGENTS



Beryl Road, W6

£550 Per week (£2,383 pcm)

A brand new two bedroom conversion flat on the first floor with an open plan reception room and kitchen with integrated appliances including a dishwasher and wood floors finished to an excellent standard in a residential street close to Charing Cross Hospital in Hammersmith.

Beryl Road is a residential street offering easy access to Hammersmith Broadway's excellent transport links and variety of shops and restaurants as well as Barons Court tube.

- Brand New Refurbished Flat • First Floor • Two Bedrooms • Open Plan Reception/ Kitchen • Furnished • Hammersmith Broadway •

FLETCHERS

ESTATE AGENTS

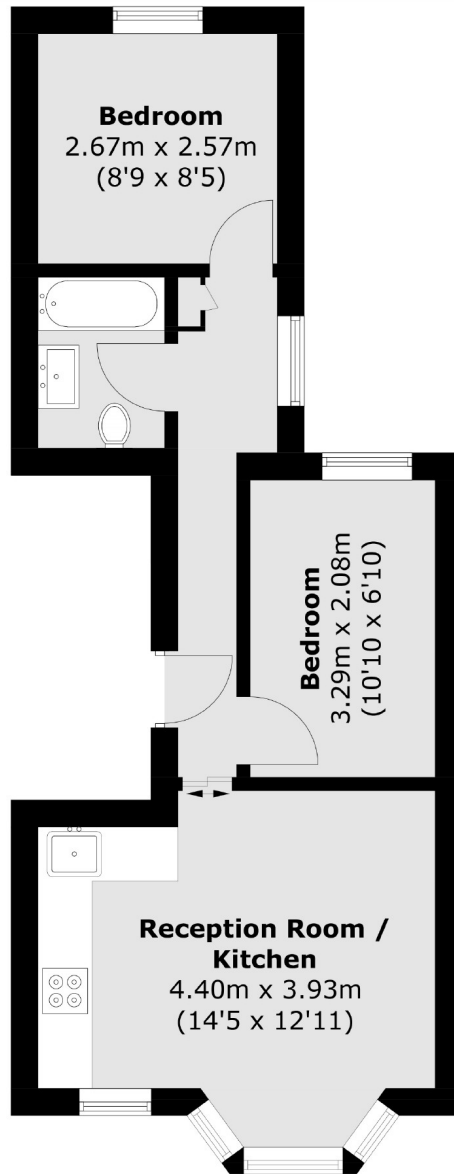

Total area (approx.): 37.4 sq. m (402.6 sq. ft)

Fletchers Brook Green Lettings
144 Shepherds Bush Road, Hammersmith, London, W6 7PB
020 7603 0603
brookgreenlettings@fletcherestates.com

Energy Rating: C. We aim to make our particulars both accurate and reliable. However they are not guaranteed; nor do they form part of an offer or contract. If you require clarification on any points then please contact us, especially if you're traveling some distance to view. Please note that appliances and heating systems have not been tested and therefore no warranties can be given as to their good working order.