



St. James's Gardens, W11

£461 Per week

Offering a separate entrance and wooden flooring throughout, this impressive, newly refurbished one double bedroom apartment is situated within a well maintained period building located moments from Holland Park Tube.

St James's Gardens is ideally located moments from Westfield Shopping Centre, Holland Park and Shepherds Bush Tube stations.

Features

- Outside Space
- Newly Refurbished
- Wooden Flooring
- Open Plan
- Rainfall Shower
- Period Conversion



St. James's Gardens, W11



St. James's Gardens,
London, W11

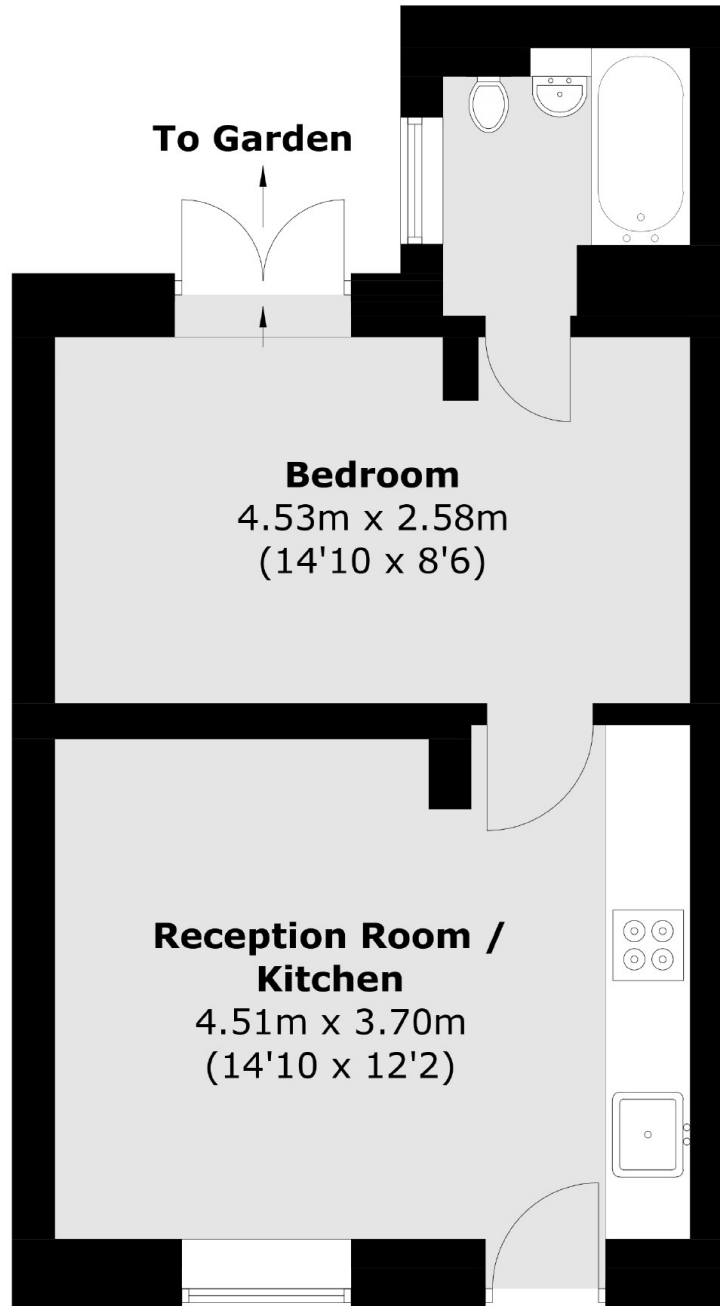

Lower Ground Floor

Total area (approx.): 33.1 sq. m (356.3 sq. ft)

Dexters

Notting Hill
121-123 Notting Hill Gate
London
W11 3LB
Lettings
020 7792 0792

Energy Rating: . We aim to make our particulars both accurate and reliable. However they are not guaranteed; nor do they form part of an offer or contract. If you require clarification on any points then please contact us, especially if you're traveling some distance to view. Please note that appliances and heating systems have not been tested and therefore no warranties can be given as to their good working order.

 **RICS** | Regulated
Estate Agent
and Letting Agent

dexters.co.uk