



## Avondale Park Gardens, W11

£1,384 Per week

A lovely home over two floors that has recently been renovated to a high specification. As you enter the property, there is a large living space, with a separate eat in kitchen at the back of the home, leading to the outdoor space. Upstairs you have three double bedrooms and a family bathroom. The property would be perfect for a family of a couple who want a little more space and a private outside area.

Avondale Park Gardens is a beautifully kept cul-de-sac close to Avondale Park. A 15 minute walk to both Holland Park and Shepherds Bush tube stations, as well as all the restaurants around Holland Park Avenue.

### Features

Three Bedroom House  
Private Outside Space  
Furnished  
Available Now  
Wooden Floors



Avondale Park Gardens, W11





# Avondale Park Gardens, London, W11

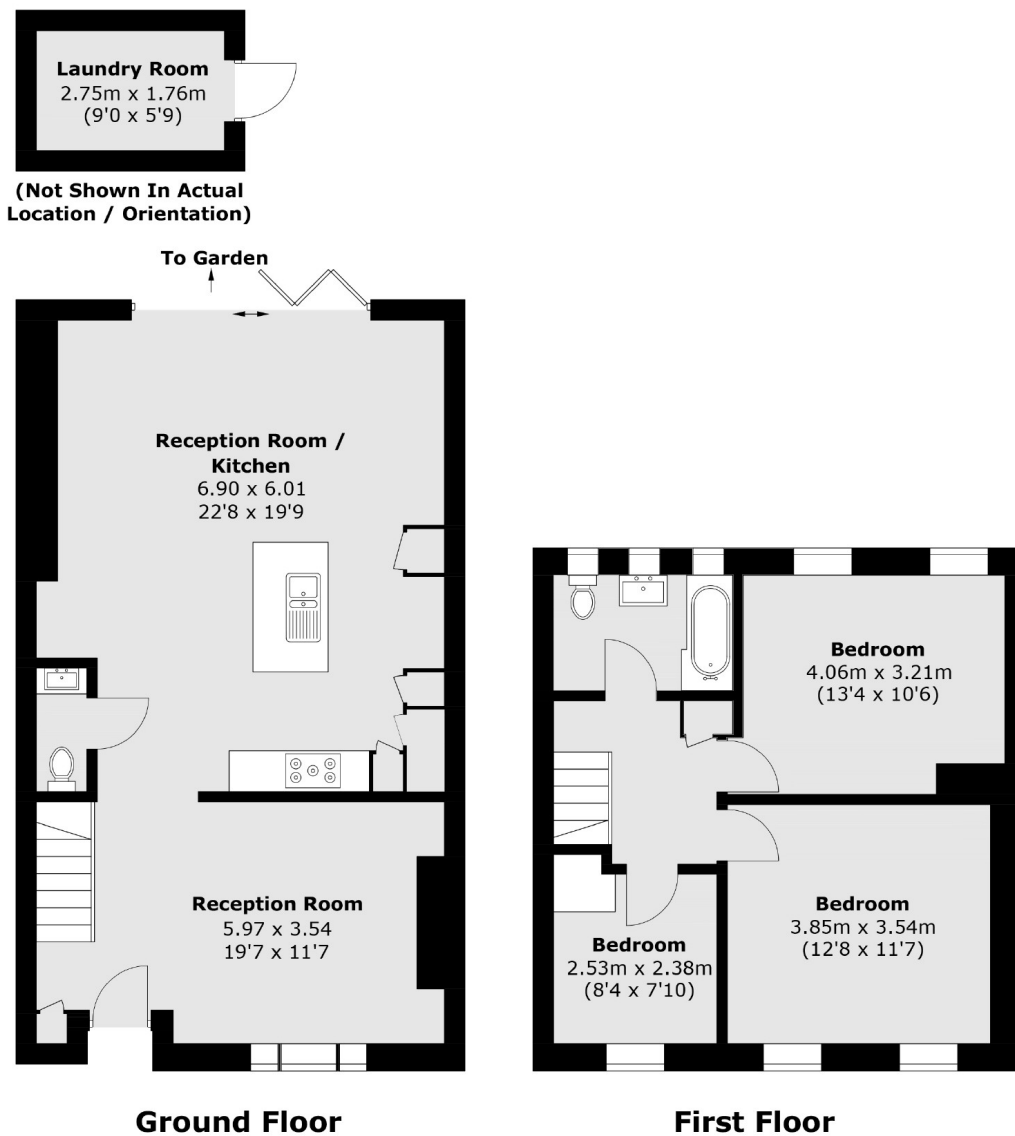

Total area (approx.): 106.3 sq. m (1,144.2 sq. ft)  
Laundry Room : 5.0 sq. m (53.8 sq. ft)