



## Hereford Road, W2

£519 Per week

A top floor three bedroom property close to the local amenities of Westbourne Grove. Layout includes a separate kitchen with gas hob, a tiled bathroom with shower over bath.

Located just off Westbourne Grove, close to the shops and restaurants including Pharmacy restaurant, Beach Blanket and Babylon and the Westbourne.

### Features

Three Bedrooms  
Top Floor  
Separate Kitchen  
Tiled Bathroom  
Wood Floors  
Close To Local Amenities

Hereford Road,  
London, W2

### Third Floor

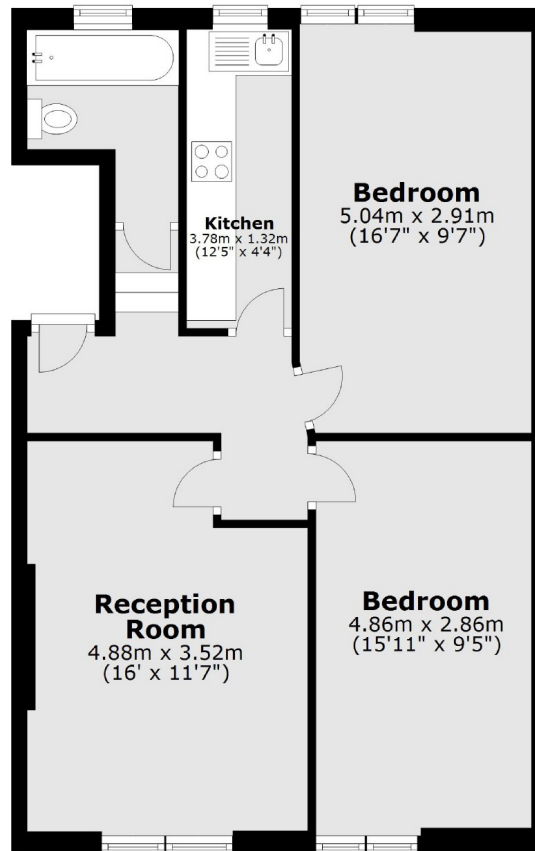

Total area: approx. 61.8 sq. metres (665.1 sq. feet)