



Holland Park, W11

£773 Per week

Dexters



Holland Park, W11

This exceptional two bedroom flat has been refurbished throughout and is ideally positioned within an immaculately maintained period villa located on the prestigious Holland Park.

This property is located on one of the most prestigious streets in Holland Park. The flat is close to Holland Park station and the Kyoto Gardens of Holland Park itself.

Features

- Two Bedroom Flat
- Newly Refurbished
- Wood Floors
- Dual Aspect Windows
- End of Terrace
- Prestigious Neighbourhood



Holland Park, London, W11

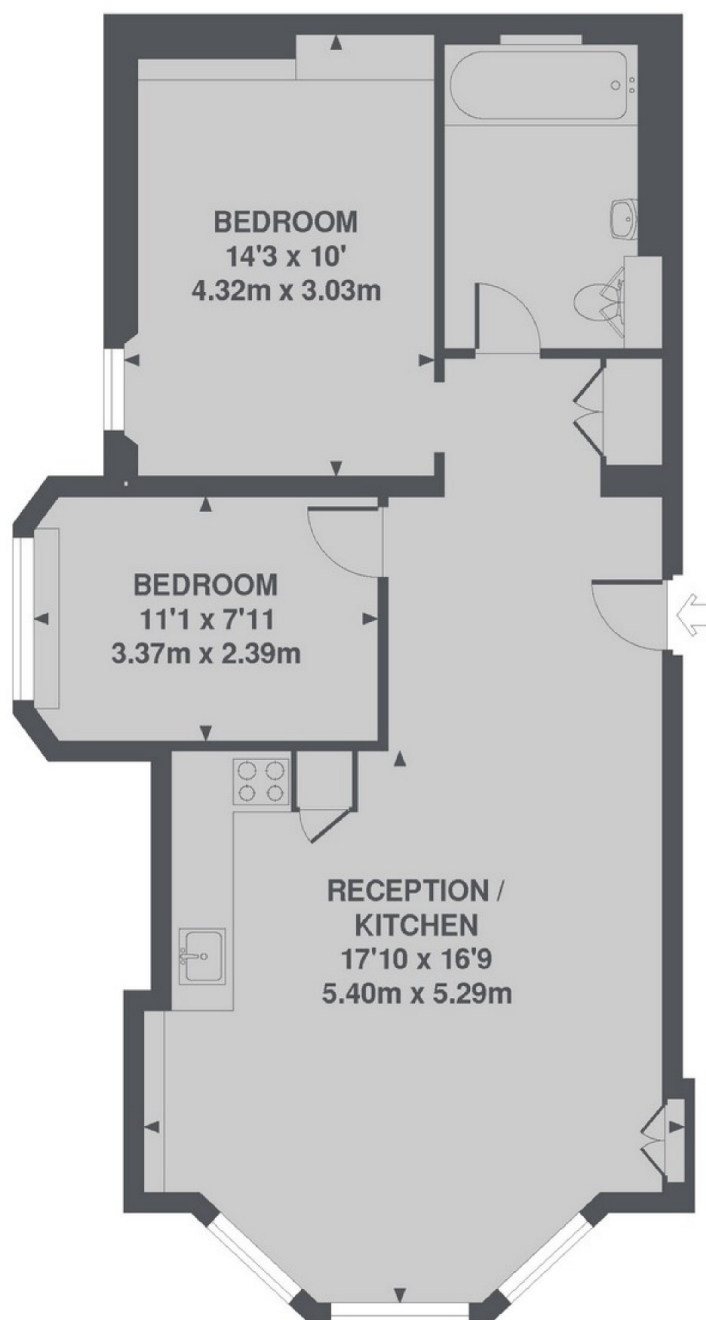

TOTAL APPROX. FLOOR AREA 681 SQ. FT. (63.3 SQ. M.)

Dexters

Notting Hill
121-123 Notting Hill Gate
London
W11 3LB
Lettings
020 7792 0792

Energy Rating: D. We aim to make our particulars both accurate and reliable. However they are not guaranteed; nor do they form part of an offer or contract. If you require clarification on any points then please contact us, especially if you're traveling some distance to view. Please note that appliances and heating systems have not been tested and therefore no warranties can be given as to their good working order.

 **RICS** | Regulated
Estate Agent
and Letting Agent

[dexters.co.uk](https://www.dexters.co.uk)