



Bramley Road, W10

£692 Per week

This unique and beautifully designed 3-bedroom, 2 bathroom duplex offers luxurious living over two spacious floors, completed to an exceptional standard.

Nestled on Bramley Road, just a 2-minute walk from Latimer Road Tube Station, this rare gem combines modern elegance with superb convenience. With excellent transport links and local amenities on your doorstep, this home offers both convenience and the perfect blend of indoor and outdoor living in the heart of West London.

Features

- Private Roof Terrace
- Jacuzzi/Spa Bath
- Split Level
- Finished To An Excellent Standard
- 2 Minute Walk From Latimer Road
- Close To Amenities



Bramley Road, W10



Bramley Road, London, W10

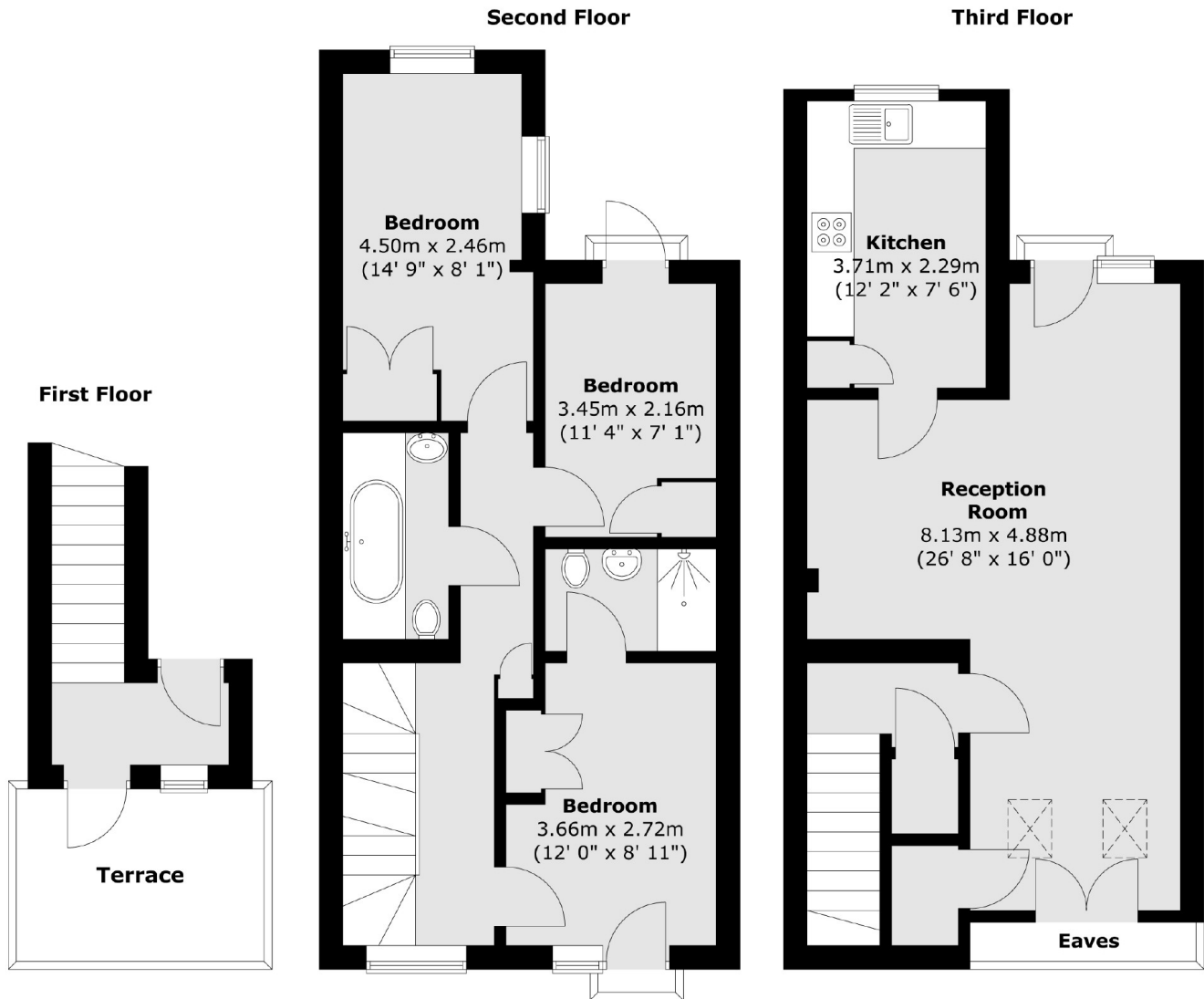

Total area (approx.) : 99.1 sq. m (1067 sq. ft)
Total terrace area (approx.) : 6.1 sq. m (66 sq. ft)
Total balcony area (approx.) : 0.8 sq. m (8 sq. ft)