



Henry Dickens Court, W11

£577 Per week

Located just moments from Latimer Road Tube Station, this well-presented 3-bedroom flat in Florence House offers a blend of space, convenience, and modern living in one of West London's thriving areas.

Situated just a short walk from Latimer Road Tube Station (Circle and Hammersmith & City lines), this flat enjoys excellent transport links to Central London and beyond. The surrounding area offers a great selection of local shops, cafes, and amenities, with Westfield London and Portobello Road close by.

Features

- 2 Large Rooms & A Smaller Room
- New Carpet Throughout
- Close to Latimer Road Tube
- Close To local amenities



Henry Dickens Court, W11



Henry Dickens Court, London, W11

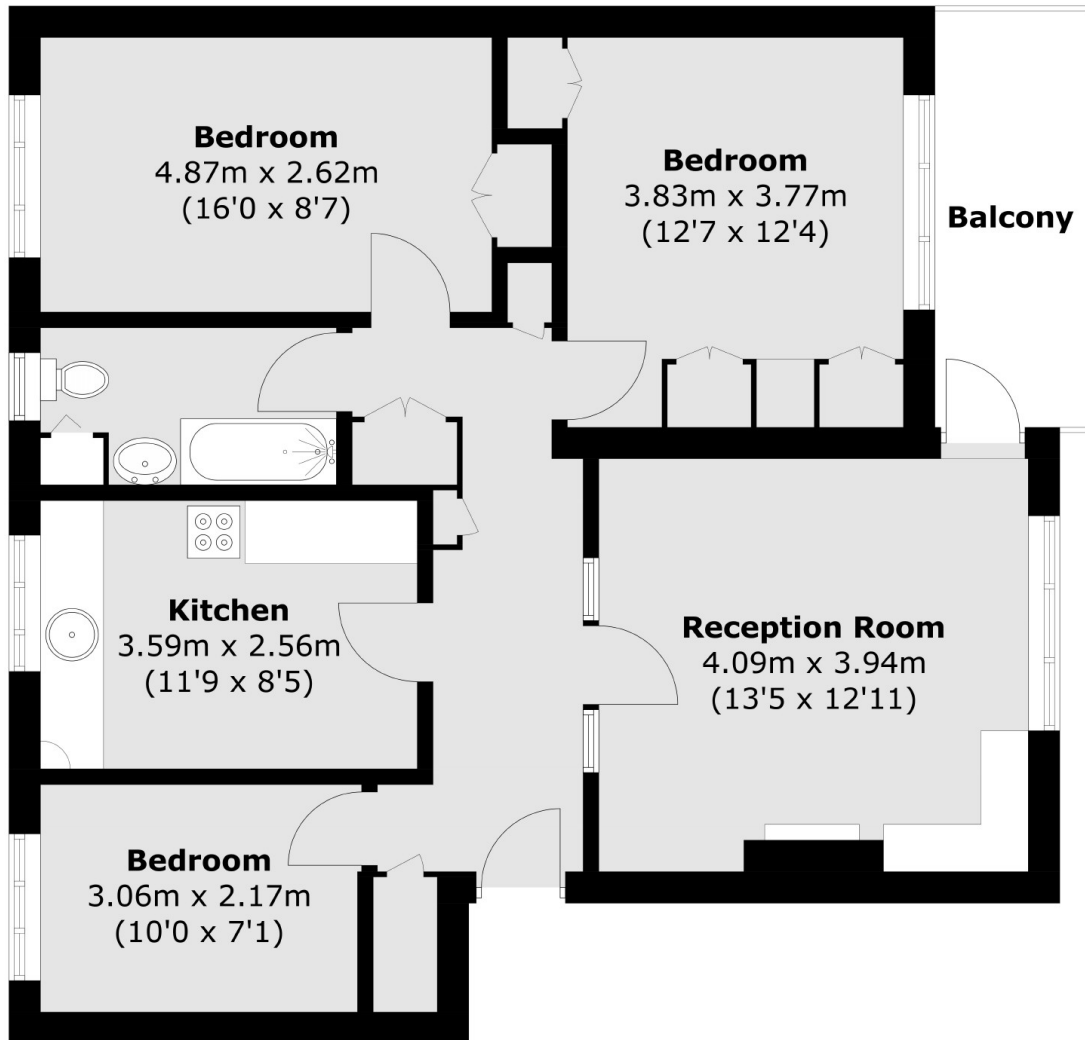

Total area (approx.): 75.4 sq. m (811.6 sq. ft)
Balcony area : 5.8 sq. m (62.4 sq. ft)