



Blenheim Crescent, W11

£650 Per week

Finished to a high standard throughout this chic, two bedroom apartment with an open plan kitchen/reception room is on one of the best roads in Notting Hill. The flat has wood floor, Sharp built-in wardrobes, new kitchen with wine cooler and Miele appliances.

Blenheim Crescent is situated moments from the local boutique shops and restaurants of both Westbourne Grove and Ladbroke Grove, while Holland Park station is only a short distance away.

Features

- Two Bedrooms
- Beautifully Finished
- Open Plan Kitchen
- Miele Appliances
- Period Conversion
- Near Portobello Road

Blenheim Crescent,
London, W11

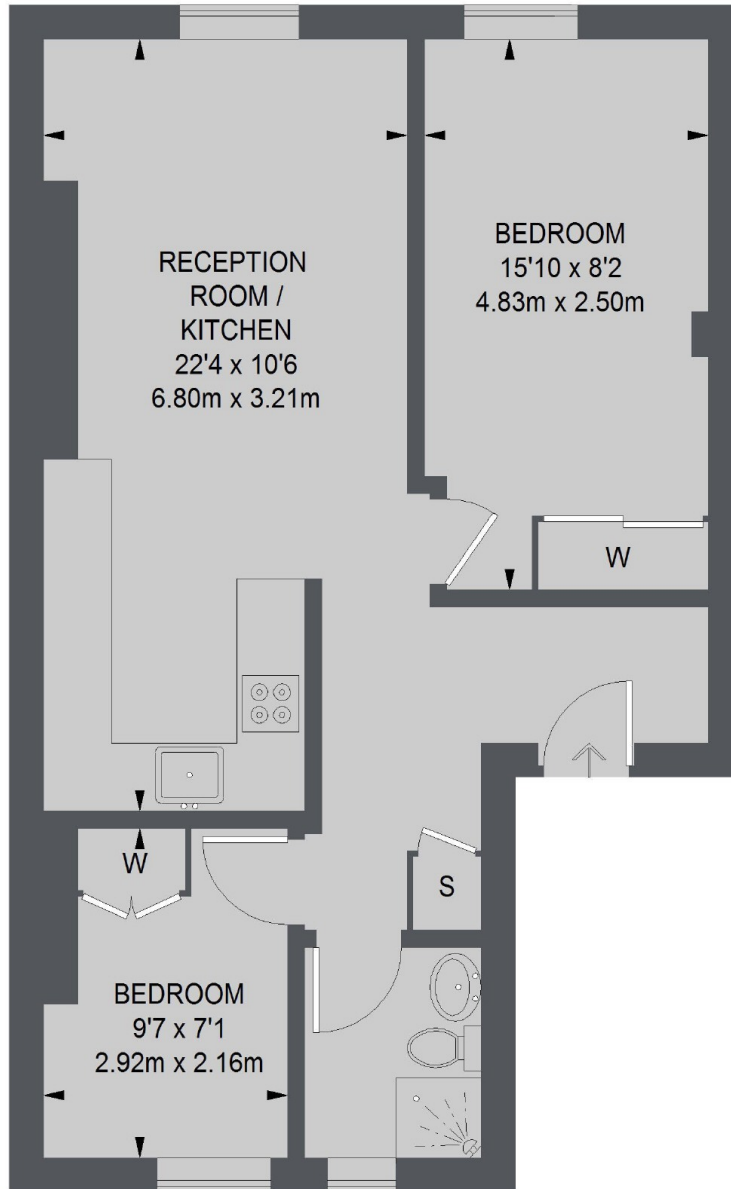

THIRD FLOOR

TOTAL APPROX. FLOOR AREA
544 SQ. FT. (50.5 SQ. M.)