



Chepstow Road, W2

£550 Per week

Dexters



Chepstow Road, W2

A beautifully refurbished two bedroom apartment situated on the top floor (lift access) of a well maintained period building ideally located on the residential Chepstow Road, in the heart of Notting Hill.

Chepstow Road is conveniently located moments from the shops and restaurants of Westbourne Grove and within easy reach of Royal Oak, Notting Hill Gate and Bayswater Tube Stations.

Features

- Top Floor Apartment
- Fully Refurbished
- Two Bedrooms
- Elevator Access
- Wood Floors
- Farrow & Ball Paint



Chepstow Road, London, W2

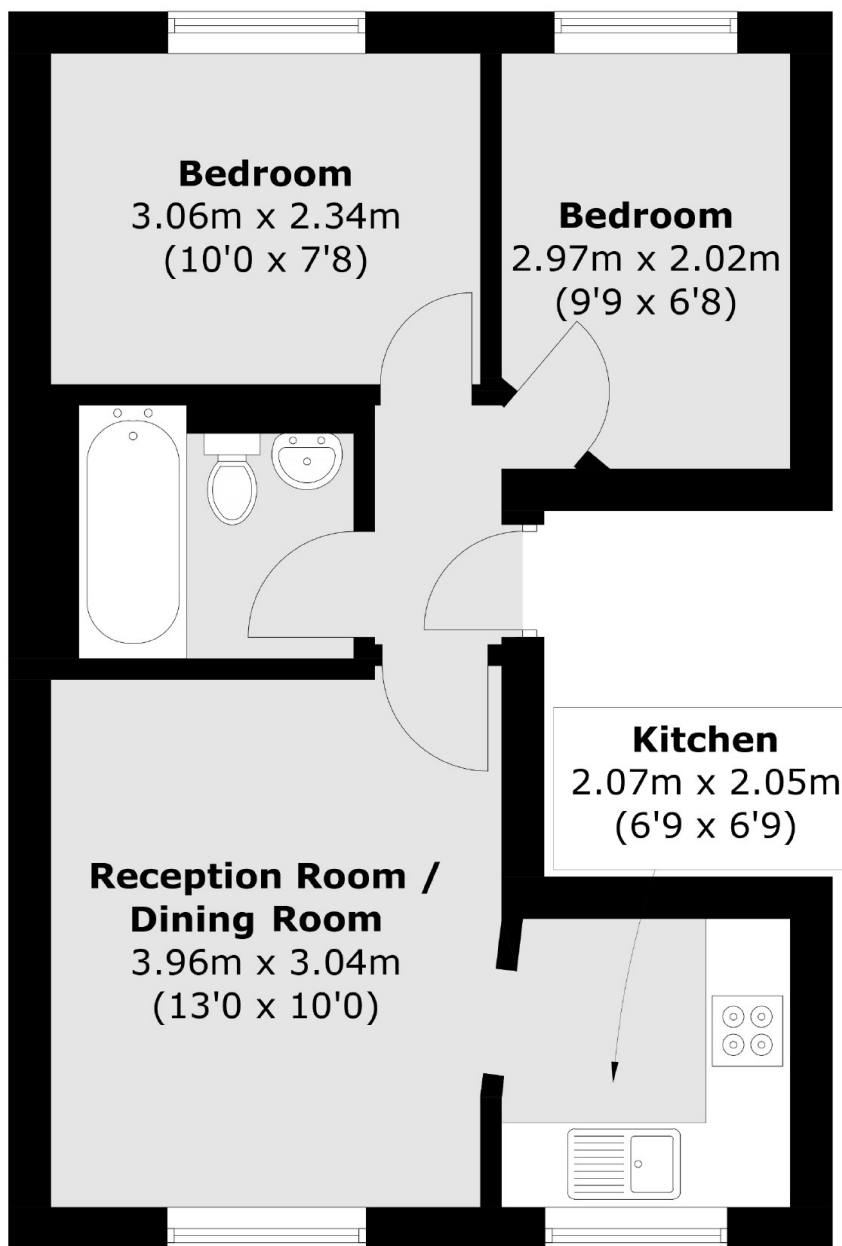

Total area (approx.): 36.6 sq. m (394.0 sq. ft)