



Redcliffe Gardens, SW10

£1,100,000

A well presented garden flat with spacious rooms. This property offers two double bedrooms, an additional study and a large kitchen. This space benefits from natural light throughout due to the large conservatory and landscaped garden.

Redcliffe Gardens is a popular road ideally located between Redcliffe Square Gardens and Earls Court Road. It is close to the shops and restaurants on Earls Court Road. The closest underground station is Earls Court.

Features

Highly Sought After Location
Private Garden
Walking Distance To Amenities
And Tube Station
Spacious Bedrooms
Study

Redcliffe Gardens, London, SW10

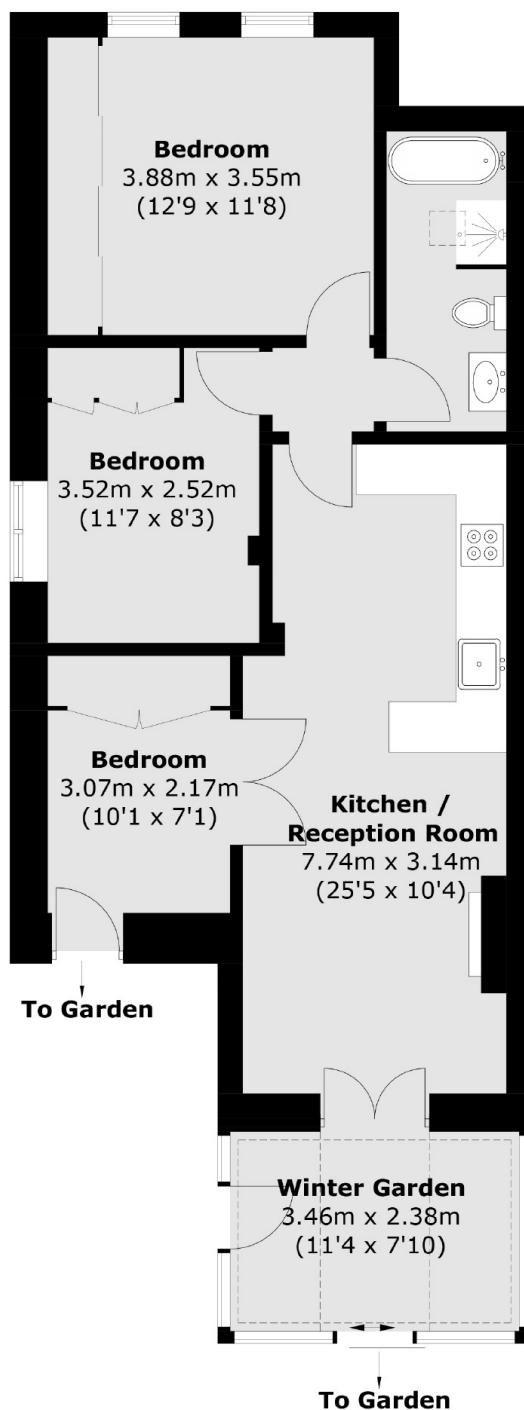

Total area (approx.): 72.0 sq. m (775.0 sq. ft)

Dexters

South Kensington
144 Old Brompton Road
London
SW7 4NR
Sales
0207 838 0108

Energy Rating: D. We aim to make our particulars both accurate and reliable. However they are not guaranteed; nor do they form part of an offer or contract. If you require clarification on any points then please contact us, especially if you're traveling some distance to view. Please note that appliances and heating systems have not been tested and therefore no warranties can be given as to their good working order.

 **RICS** | Regulated
Estate Agent
and Letting Agent

dexters.co.uk