



Rosary Gardens, SW7

£775 Per week

A great two bedrooms flat to let in South Kensington. On the second floor of this red brick Victorian building is furnished, with an open-plan kitchen/living room, wood floors and modern specification throughout.

Close to Gloucester Road and Earls Court Road with a wide choice of cafes, shops and restaurants. Gloucester Road is the closest underground with links to the city via the District and Piccadilly line.

Features

- Two Bedrooms
- One Bathroom
- Open Plan Kitchen
- Spacious Living Room
- Lateral Flat
- Wood Floors

Rosary Gardens, London, SW7

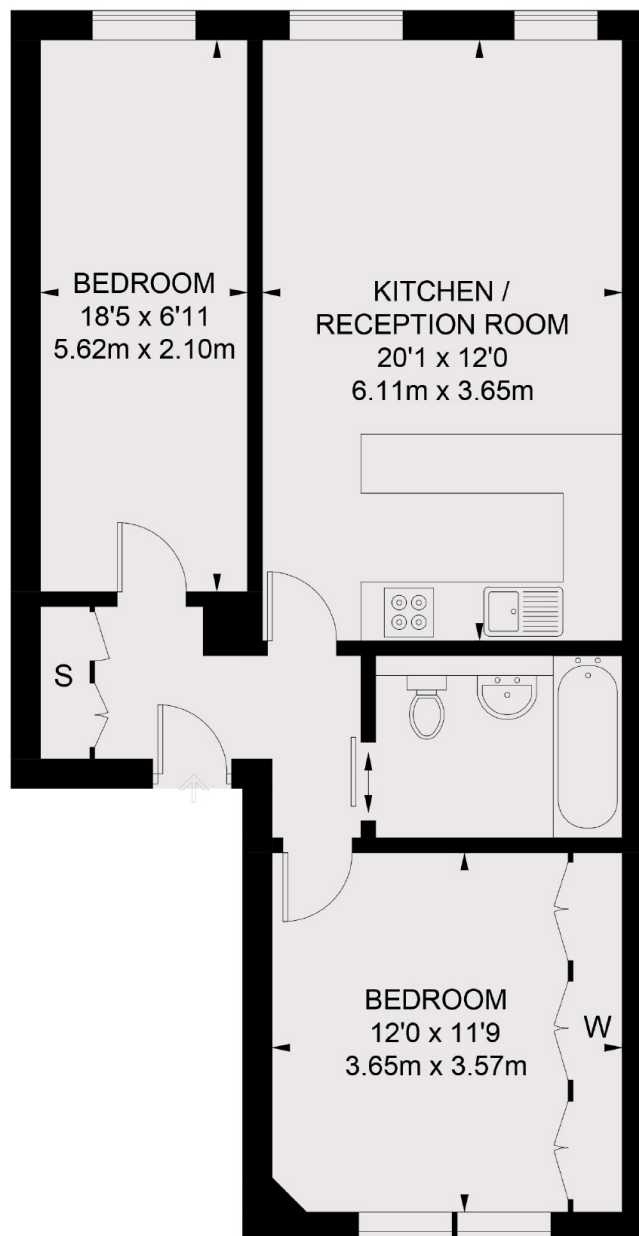

SECOND FLOOR

TOTAL APPROX. FLOOR AREA 640 SQ. FT. (59.5 SQ. M.)

Dexters

South Kensington
144 Old Brompton Road
London
SW7 4NR
Lettings
020 7244 7711

Energy Rating: D. We aim to make our particulars both accurate and reliable. However they are not guaranteed; nor do they form part of an offer or contract. If you require clarification on any points then please contact us, especially if you're traveling some distance to view. Please note that appliances and heating systems have not been tested and therefore no warranties can be given as to their good working order.

 **RICS** | Regulated
Estate Agent
and Letting Agent

[dexters.co.uk](https://www.dexters.co.uk)