



## Ashburn Gardens, SW7

£495 Per week

A well-located studio flat with a large living area which includes a dining area, separate kitchen and a bathroom. This is the perfect pad for a young professional.

The property is extremely close to many local amenities and is ideally situated just moments from Gloucester Road, ideal for grabbing a coffee.

### Features

- Studio Flat
- Large Living Area
- Dining Area
- Separate Kitchen
- Raised Ground Floor
- Furnished

# Ashburn Gardens, London, SW7

## ASHBURN GARDENS, SW7

Approx. gross internal area  
419 Sq.Ft. / 38.9 Sq.M.  
431 Sq.Ft. / 40.0 Sq.M. Inc. Restricted Height Area

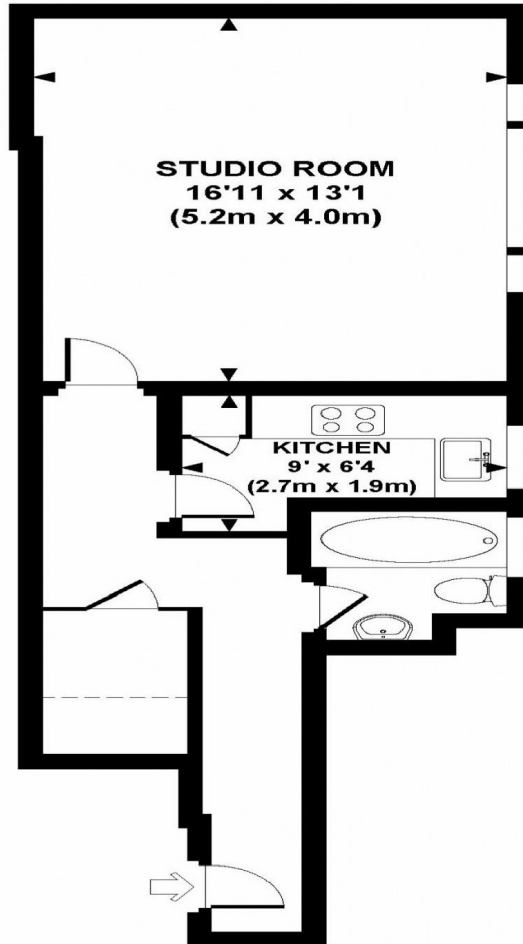

### RAISED GROUND FLOOR



All measurements are approximate and for illustration purposes only as defined by the RICS Code of Measuring Practice © 2013  
Dowling Jones Design www.dowlingjones.com 020 7610 9933

# Dexters

South Kensington  
144 Old Brompton Road  
London  
SW7 4NR  
Lettings  
020 7244 7711

Energy Rating: C. We aim to make our particulars both accurate and reliable. However they are not guaranteed; nor do they form part of an offer or contract. If you require clarification on any points then please contact us, especially if you're traveling some distance to view. Please note that appliances and heating systems have not been tested and therefore no warranties can be given as to their good working order.



dexters.co.uk